

4

3

2

1

Fastener Standard (Metric): Screw, Socket Head, M2.5 X 8

TORQUE:  
4±1 IN.LB.

COMP SELECTOR KNOB

820-05-553-KIT  
2019 Grip 34 & 36 Rhythm Topcap Interface Parts

Seals: O-Ring Custom: [1.066 C.S. X .742 ID] N-70, Static

GREASE:  
THIN LAYER  
OF SLICK HONEY

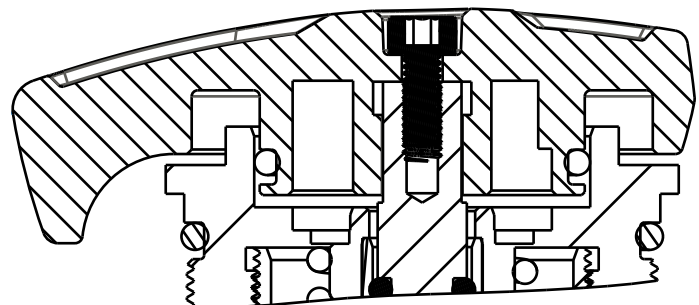
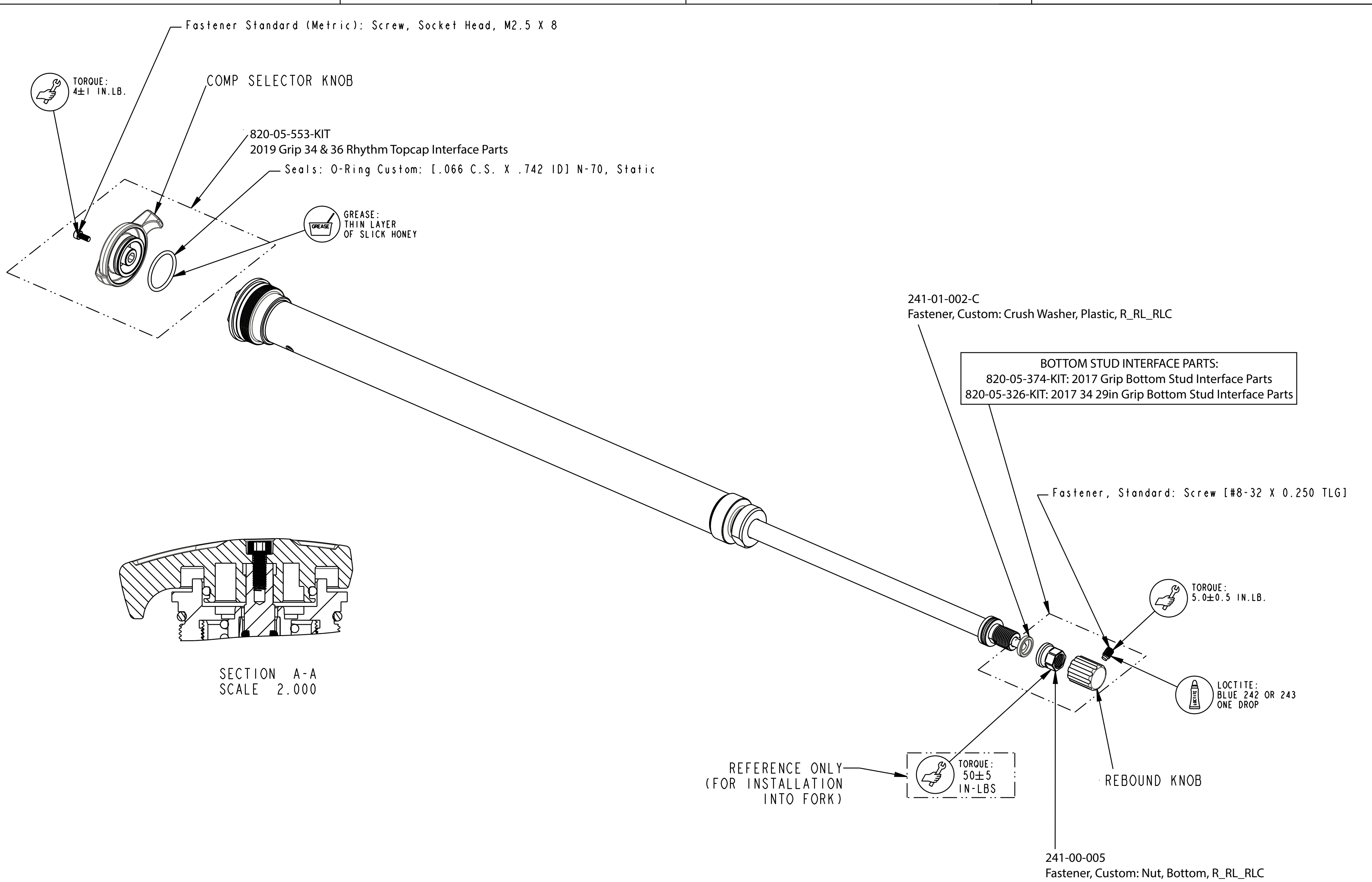

SECTION A-A  
SCALE 2.000

241-01-002-C  
Fastener, Custom: Crush Washer, Plastic, R\_RL\_RLC

BOTTOM STUD INTERFACE PARTS:  
820-05-374-KIT: 2017 Grip Bottom Stud Interface Parts  
820-05-326-KIT: 2017 34 29in Grip Bottom Stud Interface Parts

Fastener, Standard: Screw [#8-32 X 0.250 TLG]

TORQUE:  
5.0±0.5 IN.LB.

LOCTITE:  
BLUE 242 OR 243  
ONE DROP

REBOUND KNOB

241-00-005  
Fastener, Custom: Nut, Bottom, R\_RL\_RLC

REFERENCE ONLY  
(FOR INSTALLATION  
INTO FORK)

TORQUE:  
50±5  
IN-LBS

**FOX** **FOX Factory, Inc.** Ph 831-768-1100  
130 Hangar Way, Watsonville, CA 95076 USA Fax 831-768-9312

TITLE  
**2021 34 RHYTHM GRIP  
CARTRIDGE ASSEMBLIES COMPLETE**

SIZE DWG. NO.  
**C**

PLOT SCALE 0.75:1 | SHEET 1 OF 2

- PROPRIETARY -  
THIS DOCUMENT CONTAINS CONFIDENTIAL, PROPRIETARY INFORMATION  
THAT IS FOX PROPERTY. DO NOT DISCLOSE TO OR DUPLICATE  
FOR OTHERS EXCEPT AS AUTHORIZED BY FOX.

4

3

2

1