

4

3

2

1

D

D

C

C

B

B

A

A

ASSEMBLE 002-02-011 AT THIS LEVEL

038-01-073
Retaining Ring: Wire [.280 OD X .024 CS] SS

210-22-920
Compression Adjust Coupler, F-S, FIT4

820-05-421-KIT
2018 32 FIT4 SC Topcap Assy, VC49, Black Ano

TORQUE:
55±5 IN LBS

820-03-259-KIT
2017 32 27.5in and 29in FIT4 SC Damper Shaft Assy

TORQUE:
55±5 IN LBS

820-03-281-KIT
2017 32 27.5in and 29in 80-100 FIT4 Lightweight, Bladder Assy

029-08-068
Seals: O-Ring [3.0MM ID x 1.5MM CS] Metric, N-70, Static

039-00-243
Spring: Detent [.138 TLG, .087 OD, 48 lb/in]

010-01-012
Ball [Ø.1094]

GREASE:
THIN LAYER OF
SLICK HONEY ON BALL

ASSEMBLE THESE PARTS AFTER OIL FILL

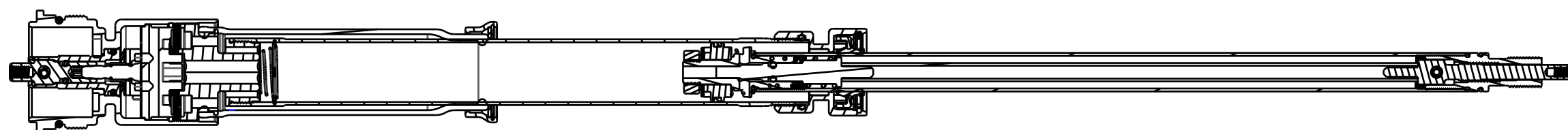

SECTION A-A
SCALE 0.750

- PROPRIETARY -
THIS DOCUMENT CONTAINS CONFIDENTIAL, PROPRIETARY INFORMATION
THAT IS FOX PROPERTY. DO NOT DISCLOSE TO OR DUPLICATE
FOR OTHERS EXCEPT AS AUTHORIZED BY FOX.

FOX FOX Factory, Inc. Ph 831-768-1100
130 Hangar Way, Watsonville, CA 95076 USA Fax 831-768-9312

TITLE
2018 32mm 27.5in/29in 80-100
FIT4 SC Cartridge Assembly

SIZE DWG. NO.
C
PLOT SCALE 1.0:1 SHEET 1 OF 1

4

3

2

1