

4

3

2

1

D

D

C

C

B

B

A

A

ASSEMBLE 002-02-011 AT THIS LEVEL

019-01-107
Socket Set Screw [M6 x 1.0mm x 6mm] Flat Pt, SST

010-01-001
Ball [Ø 0.1875] Steel

TORQUE:
55±5 IN LBS

820-03-259-KIT
2017 32 27.5in and 29in FIT4 SC Damper Shaft Assy

TORQUE:
55±5 IN LBS

820-03-281-KIT
2017 32 27.5in and 29in 80-100 FIT4 Lightweight, Bladder Assy

820-05-497-KIT
2018 32 FIT4 SC Topcap Assy, Remote, U-Cup, P-S, Push to Unlock, 2 Position

ASSEMBLE THESE PARTS AFTER OIL FILL

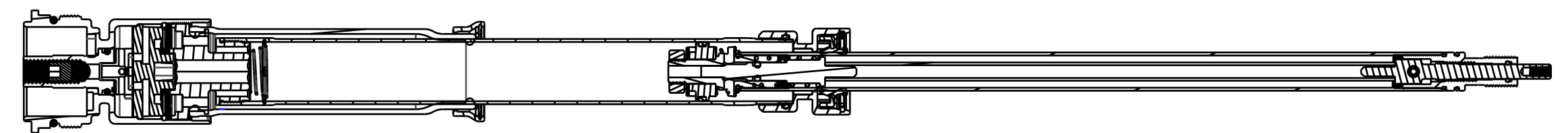

SECTION A-A
SCALE 0.750

- PROPRIETARY -
THIS DOCUMENT CONTAINS CONFIDENTIAL, PROPRIETARY INFORMATION
THAT IS FOX PROPERTY. DO NOT DISCLOSE TO OR DUPLICATE
FOR OTHERS EXCEPT AS AUTHORIZED BY FOX.

FOX FOX Factory, Inc. Ph 831-768-1100
 130 Hangar Way, Watsonville, CA 95076 USA Fax 831-768-9312

TITLE 2018 32mm 27.5in/29in 80-100
 FIT4 SC P-S Remote Cartridge Assy

SIZE DWG. NO. C

PLOT SCALE 1.0:1 SHEET 1 OF 1

4

3

2

1