

4

3

2

1

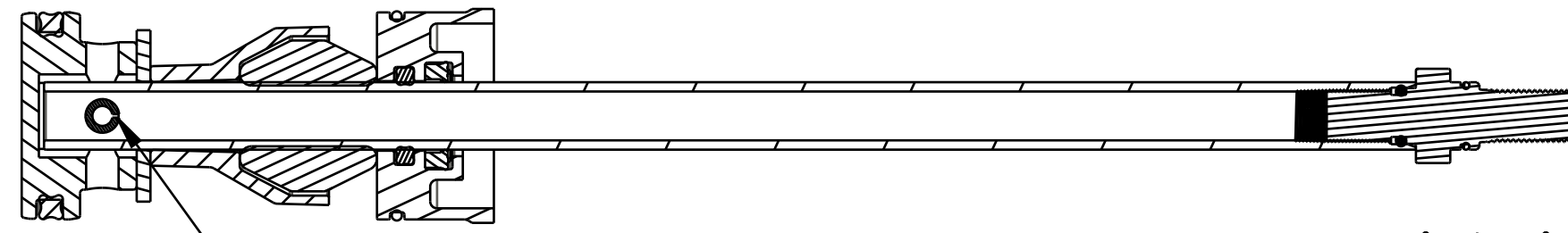

IMPORTANT:  
ORIENT GAP IN PIN TOWARDS  
TOPOUT SPACER ±15°

Seals: O-Ring [6.0mm ID x 1.5mm CS] Metric, N-70, Static

Seals: O-Ring [8.0MM ID x 1.0MM CS] Metric, N-70, Static

234-04-655  
Base Stud: Float, 0.305-48 Thread

029-08-060

**Neg Plate Subassemblies:**  
820-02-409-KIT: Neg Plate Subassembly, 2018 FLOAT LC NA 2, 32, Short Travel, 1.110 Bore  
820-02-411-KIT: Neg Plate Subassembly, 2018 FLOAT LC NA 2, 32, Long Travel, 1.110 Bore

234-04-629  
Topout Bumper, FLOAT NA

234-04-738  
Topout Spacer, FLOAT NA 2, 0.040" Thick, Aluminum

TORQUE:  
50±5 IN LB

GREASE:  
THIN LAYER  
OF SLICK HONEY

035-00-212  
Seals: Q-Ring [(-212) 0.139 C.S. X 0.859 ID]

**Pistons:**  
222-01-330: Piston, FLOAT NA 2 LC, 32, 1.110 Bore  
222-01-335: Piston, FLOAT NA 2 LC, 32, 1.110 Bore, Long Travel

LOCTITE:  
1-2 DROPS  
RED 262

NO LOCTITE ON O-RING GLANDS

234-04-739  
Topout Spacer, Float, Rhythm  
ONLY USED FOR 130-150 TRAVEL AIR SHAFTS

**Shafts:**  
230-17-001: Shaft, FLOAT Air Spring, NA 2 LC, 80mm  
230-17-002: Shaft, FLOAT Air Spring, NA 2 LC, 90mm  
230-17-003: Shaft, FLOAT Air Spring, NA 2 LC, 100mm  
230-17-004: Shaft, FLOAT Air Spring, NA 2 LC, 110mm  
230-17-005: Shaft, FLOAT Air Spring, NA 2 LC, 120mm  
230-17-006: Shaft, FLOAT Air Spring, NA 2 LC, 130mm  
230-17-007: Shaft, FLOAT Air Spring, NA 2 LC, 140mm  
230-17-008: Shaft, FLOAT Air Spring, NA 2 LC, 150mm

IMPORTANT:  
PRESS PIN UNTIL CENTERED

060-01-010  
Pin: Spring [Ø 0.188 X 0.875 TLG] Spring Steel, Zinc

IMPORTANT:  
VERIFY SEAL IS NOT  
TWISTED AFTER INSTALL

**FOX Factory, Inc.**  
130 Hangor Way, Watsonville, CA 95076 USA  
Ph 831-768-1100  
Fax 831-768-9312

TITLE  
**2018 34mm SPD-PED-ELEC 80-150  
FLOAT NA2 Air Shaft Assemblies**

SIZE DWG. NO.  
**C**  
PLOT SCALE 1:1:1 SHEET 1 OF 1

PROPRIETARY  
THIS DOCUMENT CONTAINS CONFIDENTIAL, PROPRIETARY INFORMATION  
THAT IS FOX PROPERTY. DO NOT DISCLOSE TO OR DUPLICATE  
FOR OTHERS EXCEPT AS AUTHORIZED BY FOX.

4

3

2

ProE ASSEM