

4

3

2

1

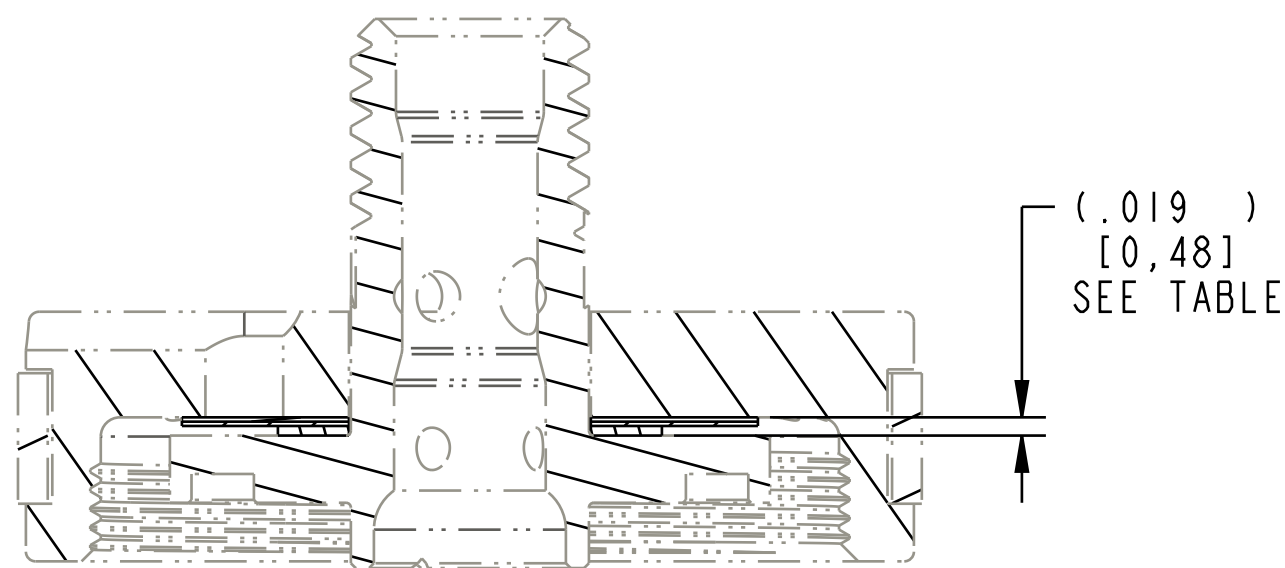

CONFIGURATION 2	STACK HEIGHT	TOLERANCE (+/-)
AS SHOWN	.019	.003
+.010 SPACER	.029	.003
+.020 SPACER	.039	.003

SECTION B-B  
SCALE 5.000

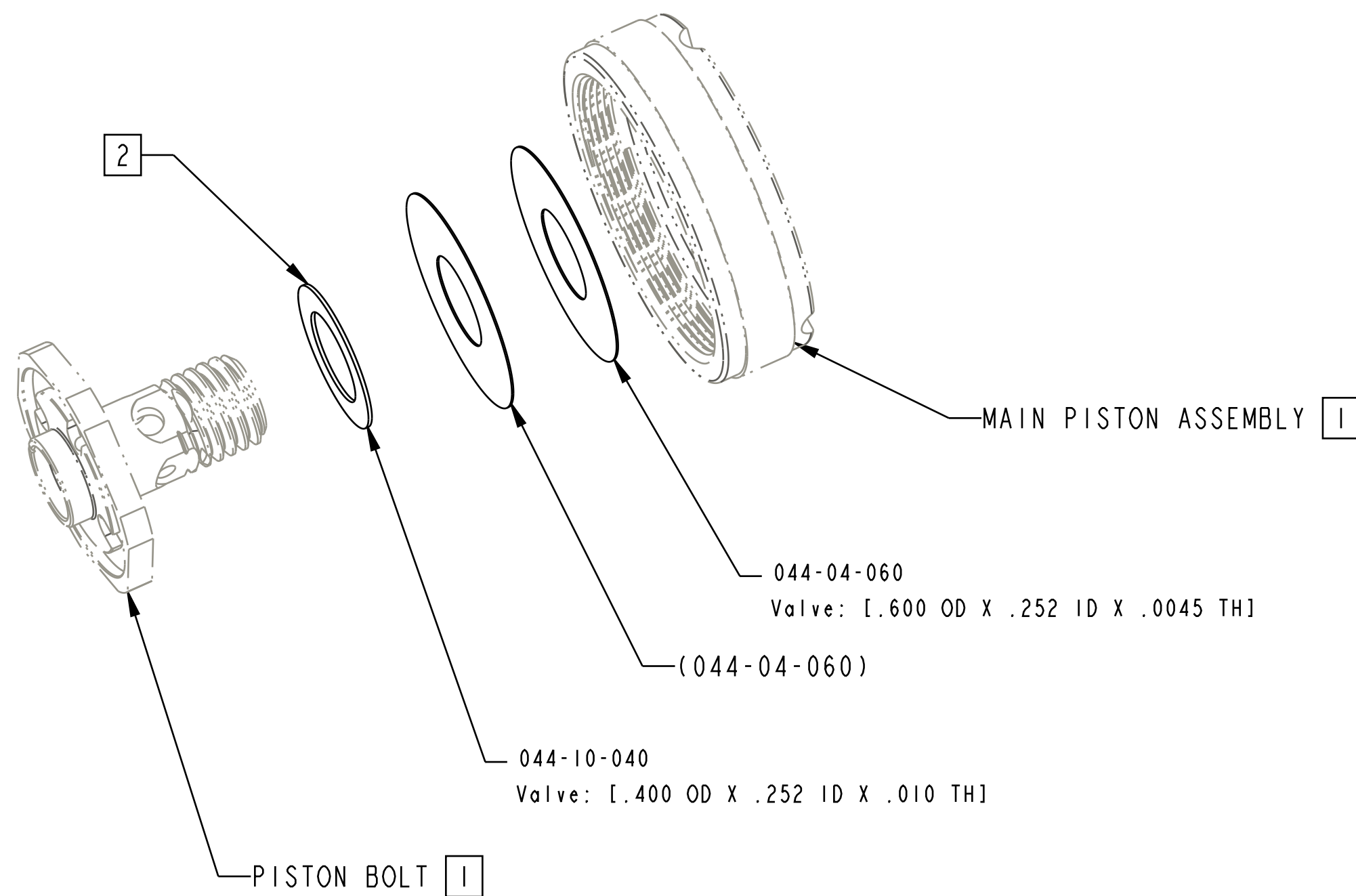

NOTES: UNLESS OTHERWISE SPECIFIED

1 PISTON AND PISTON BOLT PARTS SHOWN FOR ORIENTATION PURPOSES. MAY NOT REPRESENT ACTUAL PART GEOMETRY

2 SPACER MAY NOT BE REMOVED. 1 OR 2 SPACERS MAY BE ADDED TO ADJUST NUMBER OF REBOUND CLICKS. MATCH OUTSIDE DIAMETER OF ADJACENT SPACER.

- PROPRIETARY -  
THIS DOCUMENT CONTAINS CONFIDENTIAL, PROPRIETARY INFORMATION THAT IS FOX PROPERTY. DO NOT DISCLOSE TO OR DUPLICATE FOR OTHERS EXCEPT AS AUTHORIZED BY FOX.

		<b>FOX Factory, Inc.</b>	Ph 831-768-1100 Fax 831-768-9312
TITLE		130 Hangar Way, Watsonville, CA 95076 USA	
Valve Stack Assy: 2018 Float DPS, Linear Rebound, LRL01			
SIZE	DWG. NO.	805-05-306-KIT	
C			
PLOT SCALE 3.00:1		SHEET 1 OF 1	

4

3

2

1