

4

3

2

1

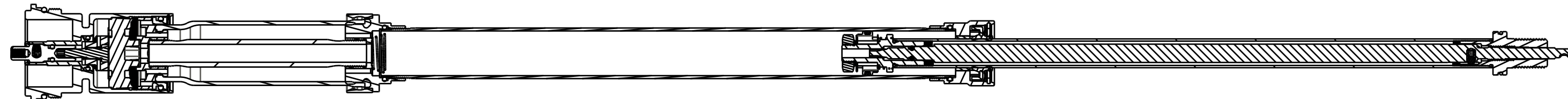

DAMPER SHAFT ASSEMBLIES:
 820-03-469-KIT: 2016 34 26in and 27.5in and 29in FIT4 Damper Shaft Assy
 820-03-334-KIT: 2016 34 26in and 27.5in and 29in FIT4 Damper Shaft Assy, 120 Max Travel

038-01-073
 Retaining Ring: Wire [.280 OD X .024 CS] SS

210-22-920
 Compression Adjust Coupler, F-S, FIT4

029-08-068
 Seals: O-Ring [3.0MM ID x 1.5MM CS] Metric, N-70, Static

820-05-498-KIT
 2018 34 FIT4 F-S Topcap Assy, E18, Black Ano

TORQUE:
 55±5 IN.LB.

TORQUE:
 55±5 IN.LB.

207-11-106
 (T) Pressure Tube, 15.5 Bore, 160 Max Travel, FIT4

039-00-243
 Spring: Detent [.138 TLG X .087 OD X 48 lb/in] SS

010-01-012
 Air Valve Parts: Ball [Ø 0.1094] E52100 Grade 25 Steel, Chrome

GREASE:
 THIN LAYER
 OF SLICK HONEY ON BALL

ASSEMBLE THESE PARTS AFTER OIL FILL

COMPRESS DAMPER SHAFT 3IN BEFORE SEALING DAMPER

PROPRIETARY
 THIS DOCUMENT CONTAINS CONFIDENTIAL, PROPRIETARY INFORMATION
 THAT IS FOX PROPERTY. DO NOT DISCLOSE TO OR DUPLICATE
 FOR OTHERS EXCEPT AS AUTHORIZED BY FOX.

FOX FOX Factory, Inc. Ph 831-768-1100
 130 Hangar Way, Watsonville, CA 95076 USA Fax 831-768-9312

TITLE
2019 34 F-S FIT4 Cartridge Assemblies

SIZE DWG. NO.
C
 PLOT SCALE | .00:1 | SHEET | OF |