

— PROPRIETARY —  
 THIS DOCUMENT CONTAINS CONFIDENTIAL, PROPRIETARY INFORMATION  
 THAT IS FOX PROPERTY. DO NOT DISCLOSE TO OR DUPLICATE  
 FOR OTHERS EXCEPT AS AUTHORIZED BY FOX.

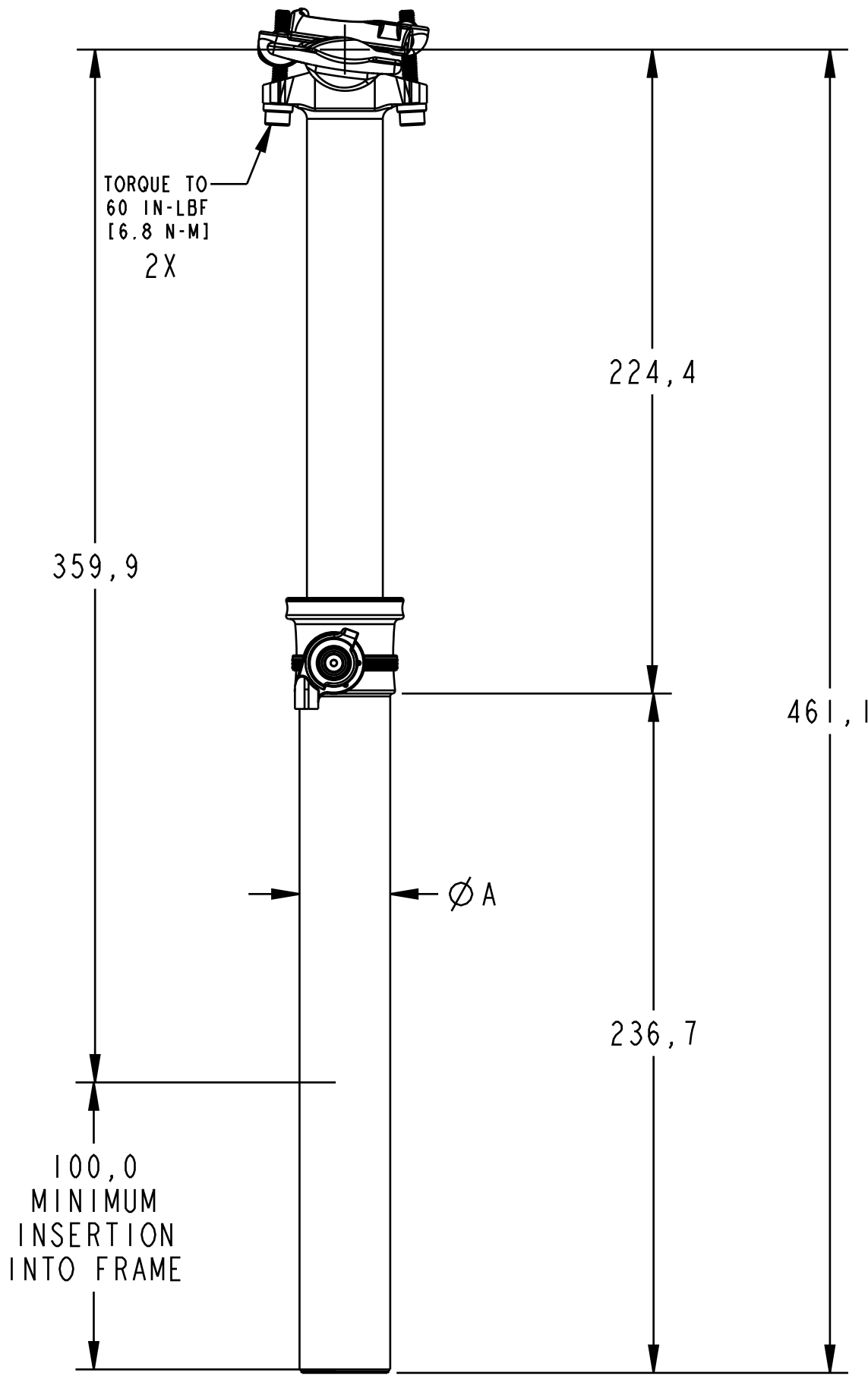

150mm DROP

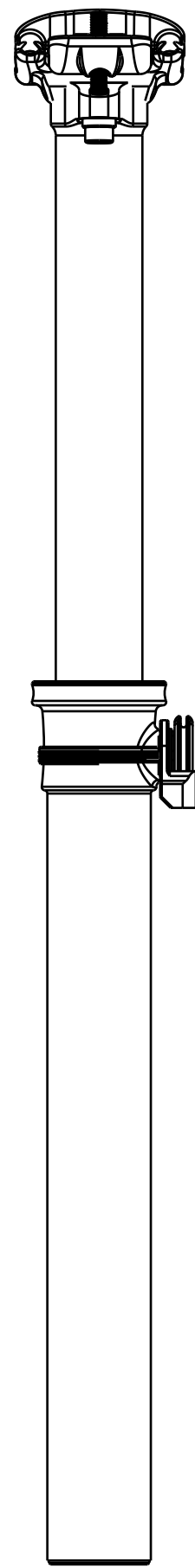
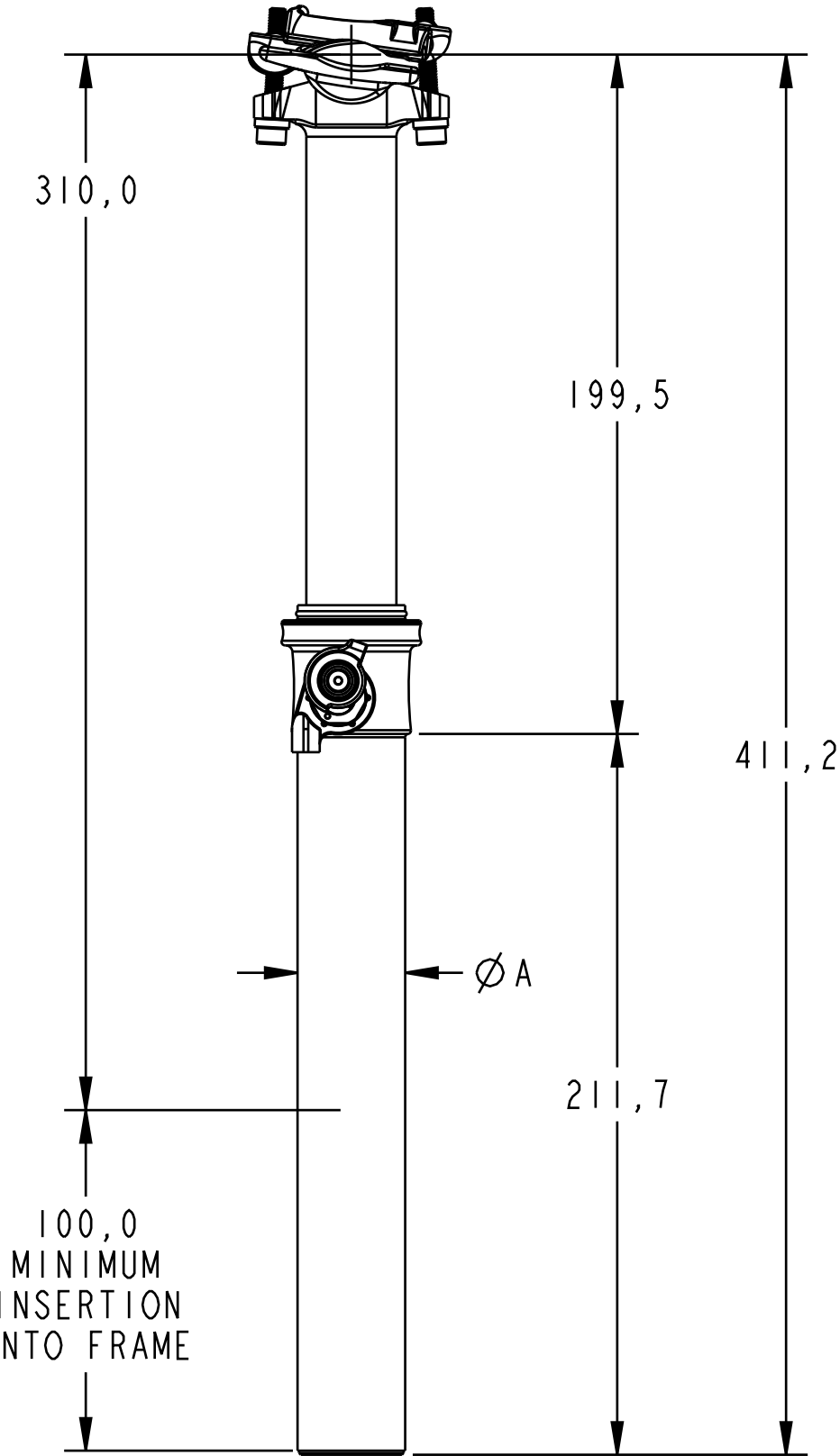

125mm DROP

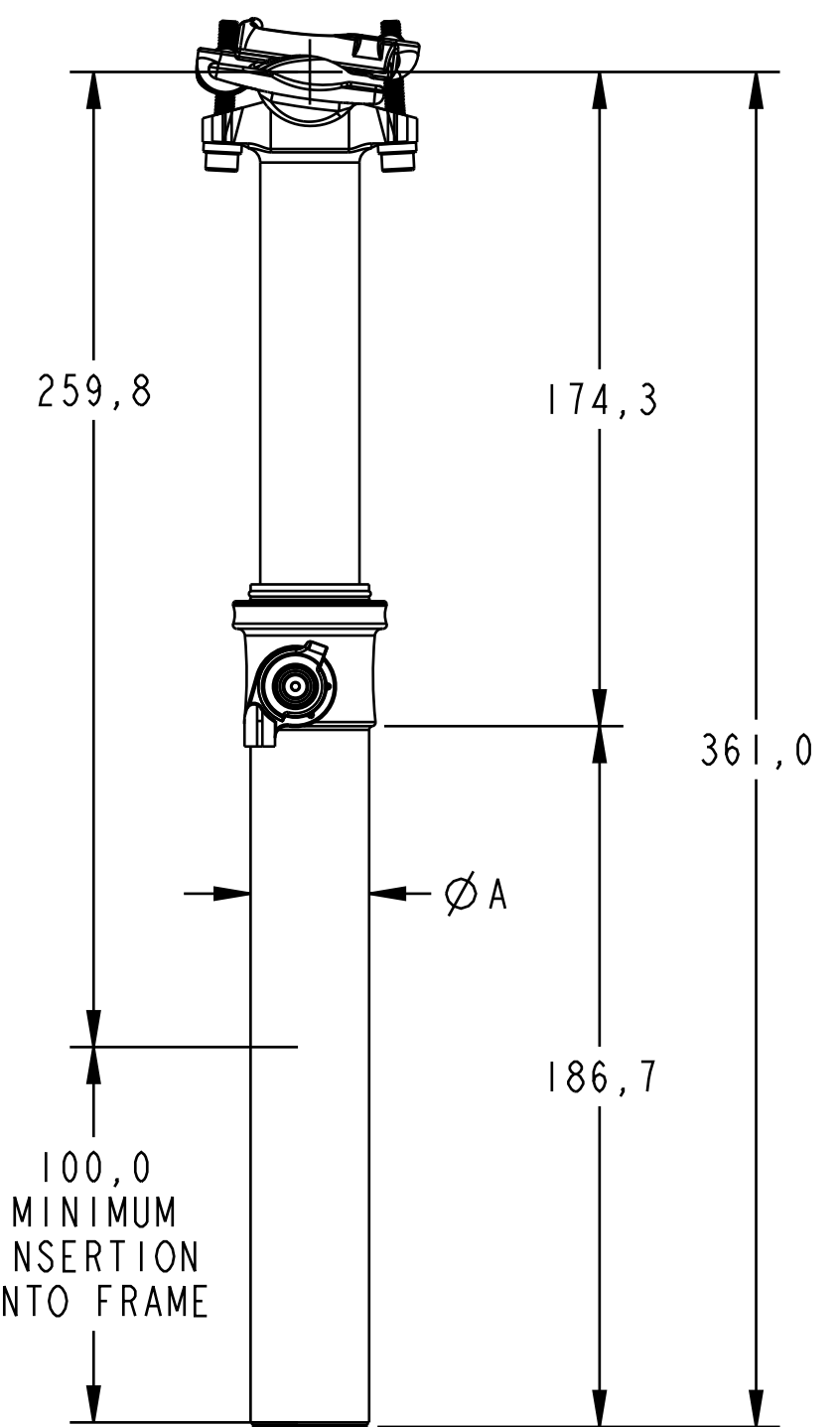

100mm DROP

DRAWING NOT TO SCALE. FOX RESERVES THE RIGHT TO CHANGE SPECIFICATIONS WITHOUT PRIOR NOTICE.  
 SADDLE RAIL COMPATIBILITY: Ø7MM STEEL/TI OR 7MM X 9MM OBOUND CARBON.  
 NOT COMPATIBLE WITH Ø8MM SADDLE RAILS.  
 SADDLE CLAMPS ARE REVERSIBLE, TO ALLOW CABLE TO EXIT ON THE LEFT OR RIGHT SIDE.  
 ON CARBON FIBER FRAMES, APPLY THIN LAYER OF CARBON ASSEMBLY PASTE TO PREVENT SEATPOST SLIPPAGE.  
 THOROUGHLY REVIEW OWNER'S MANUAL PRIOR TO INSTALLATION AND USE.  
 USE STANDARD 1.1 OR 1.2MM SHIFTER CABLE.  
 USE STANDARD 4MM SHIFTER HOUSING WITH 6MM OD END CAPS ON EACH END.  
 SEAT COLLAR BINDER BOLT TORQUE 45-65 IN-LBS (5.1-7.3 Nm).  
 NOTE: EXCESSIVE SEAT TUBE COLLAR BINDER BOLT TIGHTNESS CAN CAUSE THE UPPER SEAT POST TO BIND WITHIN THE LOWER SEAT POST.

DIAMETER	30.9 OD	31.6 OD
ØA	30.9 +0.0/-0.1	31.6 +0.0/-0.1

**FOX** FOX Factory, Inc.  
 130 Hangar Way, Watsonville, CA 95076 USA, Ph 831-768-1100, Fax 831-768-9312

**TRANSFER SEAT POST, COLLAR ROUTING, USER SPECIFICATION**

SIZE	PART NO.
C	

PLOT SCALE 1.00:1 SHEET 1 OF 1