

4

3

2

1

D

D

C

C

B

B

A

A

IMPORTANT:
ENSURE VALVE ARE NOT
PINCHED DURING ASSEMBLY

LOCTITE:
RED 263
2-3 DROPS

APPLY BLUE MARINE GREASE
TO THREADS ON
ALUMINUM REBOUND NEEDLES

GREASE:
THIN LAYER
OF SLICK HONEY

LOCTITE:
2-3 DROPS RED 263
OR FEMALE THREADS

TORQUE:
40±5 IN.LB.

210-24-037
BASE STUD

010-01-012
Ball [Ø.1094]

039-00-243
Spring: Detent [1.138 TLG, .087 OD, 48 lb/in]

210-03-234
Rebound Needle

029-03-005
O-Ring (-005) [1.070 C.S. X 0.101 ID]

820-03-476-KIT
2016 FIT4 Bearing Housing Assy

229-10-274
Damper Shaft

SEE DETAIL A

820-03-330-KIT
REBOUND PISTON ASSEMBLY

TORQUE:
40±5 IN.LB.

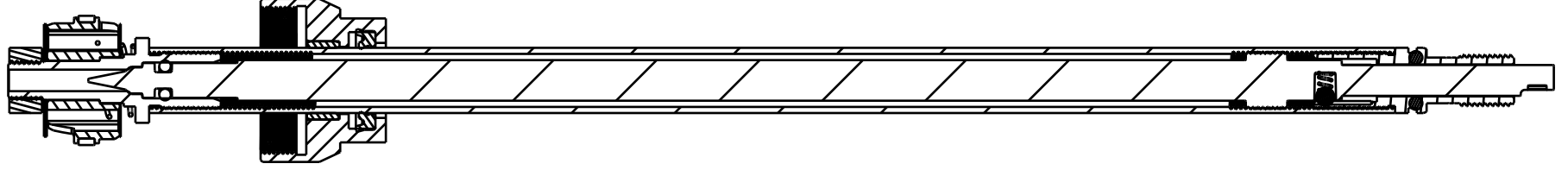

SECTION A-A

DETAIL A
SCALE 2.000

PROPRIETARY
THIS DOCUMENT CONTAINS CONFIDENTIAL, PROPRIETARY INFORMATION
THAT IS FOX PROPERTY. DO NOT DISCLOSE TO OR DUPLICATE
FOR OTHERS EXCEPT AS AUTHORIZED BY FOX.

FOX FOX Factory, Inc.		Ph 831-768-1100
130 Hangar Way, Watsonville, CA 95076 USA		Fax 831-768-9312
TITLE DAMPER SHAFT, GRIP		
SIZE C	DWG. NO. 820-03-306-KIT	
PLOT SCALE .00 : 1		SHEET OF 1

4

3

2

1