

4

3

2

1

Retaining Ring: Wire [.280 OD X .024 CS] SS

Compression Adjust Coupler, F-S, FIT4

ASSEMBLE AT THIS LEVEL

TOPCAP ASSEMBLIES:
 820-05-578-KIT: 2020 34 FIT4 F-S Topcap Assy, Remote, U-Cup, 2 Position, Push-Lock
 820-05-580-KIT: 2020 34 FIT4 F-S Topcap Assy, Remote, U-Cup, 3 Position

TORQUE:
 55±5 IN LBS

TORQUE:
 55±5 IN LBS

820-03-604-KIT
 2020 34 ALL Non-SC FIT4 8mm Damper Shaft Assy

820-03-683-KIT
 2022 32 and 34 Non-SC FIT4 8mm, Bladder Assy, 140 MAX

Seals: O-Ring [3.0MM ID x 1.5MM CS] Metric, N-70, Static

Spring: Detent [.138 TLG, .087 OD, 48 lb/in]

Ball [Ø.1094]

GREASE:
 THIN LAYER OF
 SLICK HONEY ON BALL

ASSEMBLE THESE PARTS AFTER OIL FILL

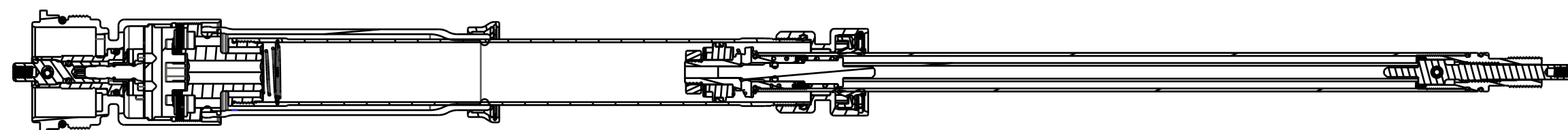

SECTION A-A
 SCALE 0.750

- PROPRIETARY -
 THIS DOCUMENT CONTAINS CONFIDENTIAL, PROPRIETARY INFORMATION
 THAT IS FOX PROPERTY. DO NOT DISCLOSE TO OR DUPLICATE
 FOR OTHERS EXCEPT AS AUTHORIZED BY FOX.

FOX FOX Factory, Inc. Ph 831-768-1100
 130 Hangar Way, Watsonville, CA 95076 USA Fax 831-768-9312

TITLE
**2022 34 NON-SC FIT4 REMOTE
 CARTRIDGE ASSEMBLIES**

SIZE DWG. NO.
C
 PLOT SCALE 1.0:1 SHEET 1 OF 1