

4

3

2

1

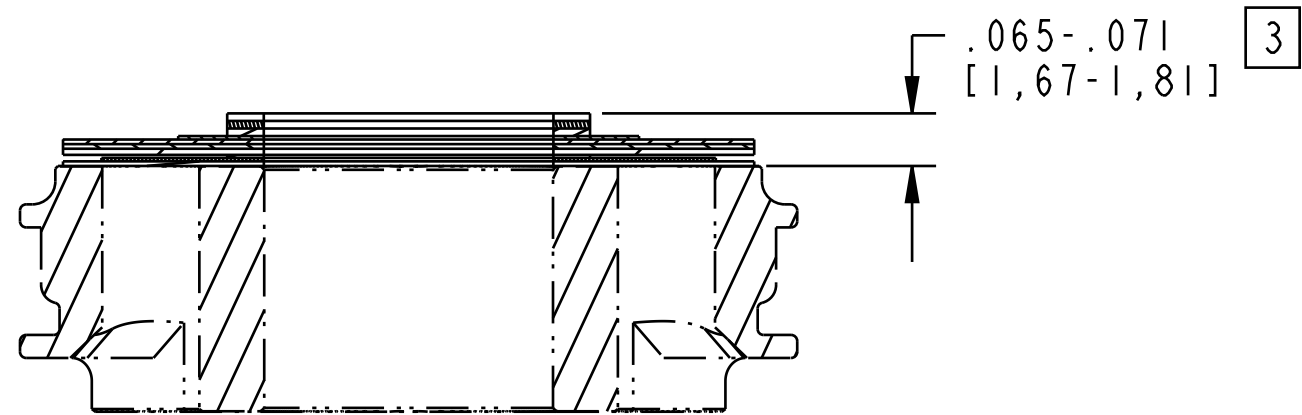

Valve: Metric [12.0 mm OD X 9.58mm ID X 0.25mm TH]

Valve: [.600 OD X .377 ID X .0045 TH]

Valve: [.900 OD X 0.377 ID X 0.008 TH]

Valve: Metric [12.0 mm OD X 9.58mm ID X 0.10mm TH]

Valve: [.800 OD X .377 ID X .0045 TH]

Valve: [.900 OD X .377 ID X .006 TH]

Valve: Metric [12.0 mm OD X 9.58mm ID X 0.25mm TH]

Valve: [.900 OD X .377 ID X .006 TH]

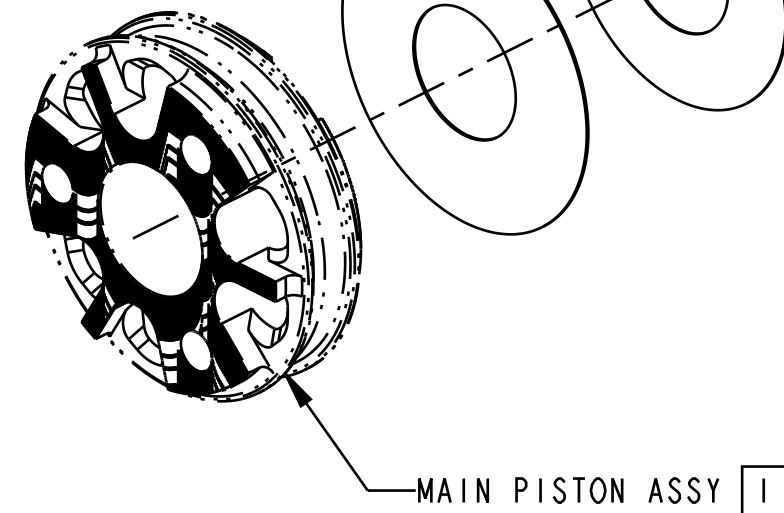

NOTES: UNLESS OTHERWISE SPECIFIED

1 MAIN PISTON ASSEMBLY SHOWN FOR ORIENTATION PURPOSES. NOTE PROPER ORIENTATION OF PISTON--SEE VALVING ASSEMBLY DRAWING FOR DETAILS. IMAGE SHOWN MAY NOT REPRESENT ACTUAL PART GEOMETRY.

2 1 SPACER MAY BE ADDED OR REMOVED TO ADJUST NUMBER OF REBOUND CLICKS.

3 DIMENSION APPLIES TO VALVE STACK AS SHOWN. ADD OR SUBTRACT THICKNESS FOR ANY VALVES ADDED OR REMOVED PER NOTE 2.

PROPRIETARY - THIS DOCUMENT CONTAINS CONFIDENTIAL, PROPRIETARY INFORMATION THAT IS FOX PROPERTY. DO NOT DISCLOSE TO OR DUPLICATE FOR OTHERS EXCEPT AS AUTHORIZED BY FOX.

		<b>FOX Factory, Inc.</b>	Ph 831-768-1100
		130 Hangar Way, Watsonville, CA 95076 USA	Fax 831-768-9312
TITLE Valve Stack Assy: 2022 FLOAT X & DHX, Compression, CNE001			
SIZE <b>C</b>	DWG. NO. <b>805-05-503-KIT</b>		
PLOT SCALE 2:1		SHEET 1 OF 1	

4

3

2

1