

4

3

2

1

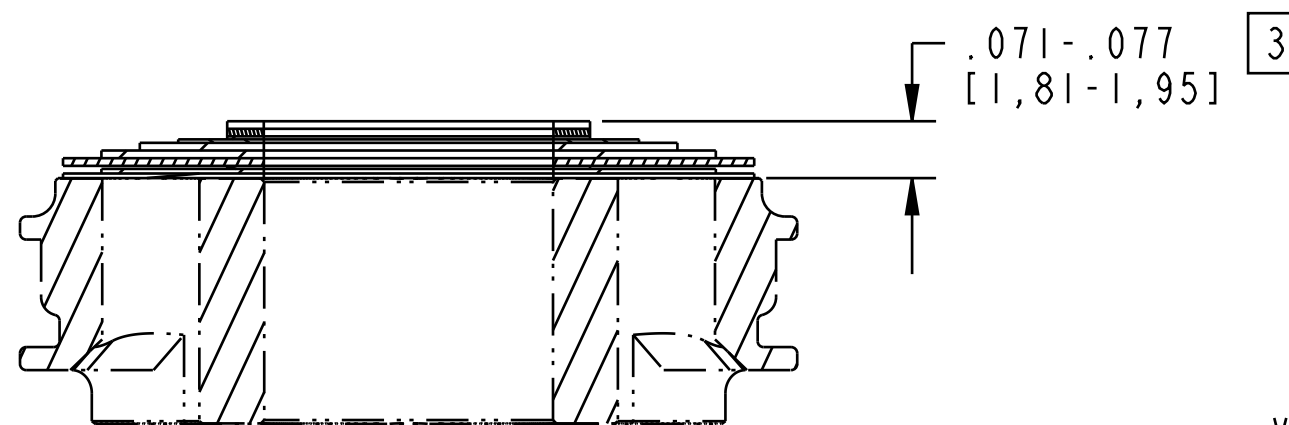

Valve: [.700 OD X .377 ID X .010 TH]

Valve: [.800 OD X .377 ID X .010 TH]

Valve: [.900 OD X .377 ID X .010 TH]

Valve: Metric [12.0 mm OD X 9.58mm ID X 0.10mm TH]

Valve: [.800 OD X .377 ID X .006 TH]

Valve: [.900 OD X .377 ID X .006 TH]

Valve: [.600 OD X .377 ID X .0045 TH]

Valve: Metric [12.0 mm OD X 9.58mm ID X 0.25mm TH]

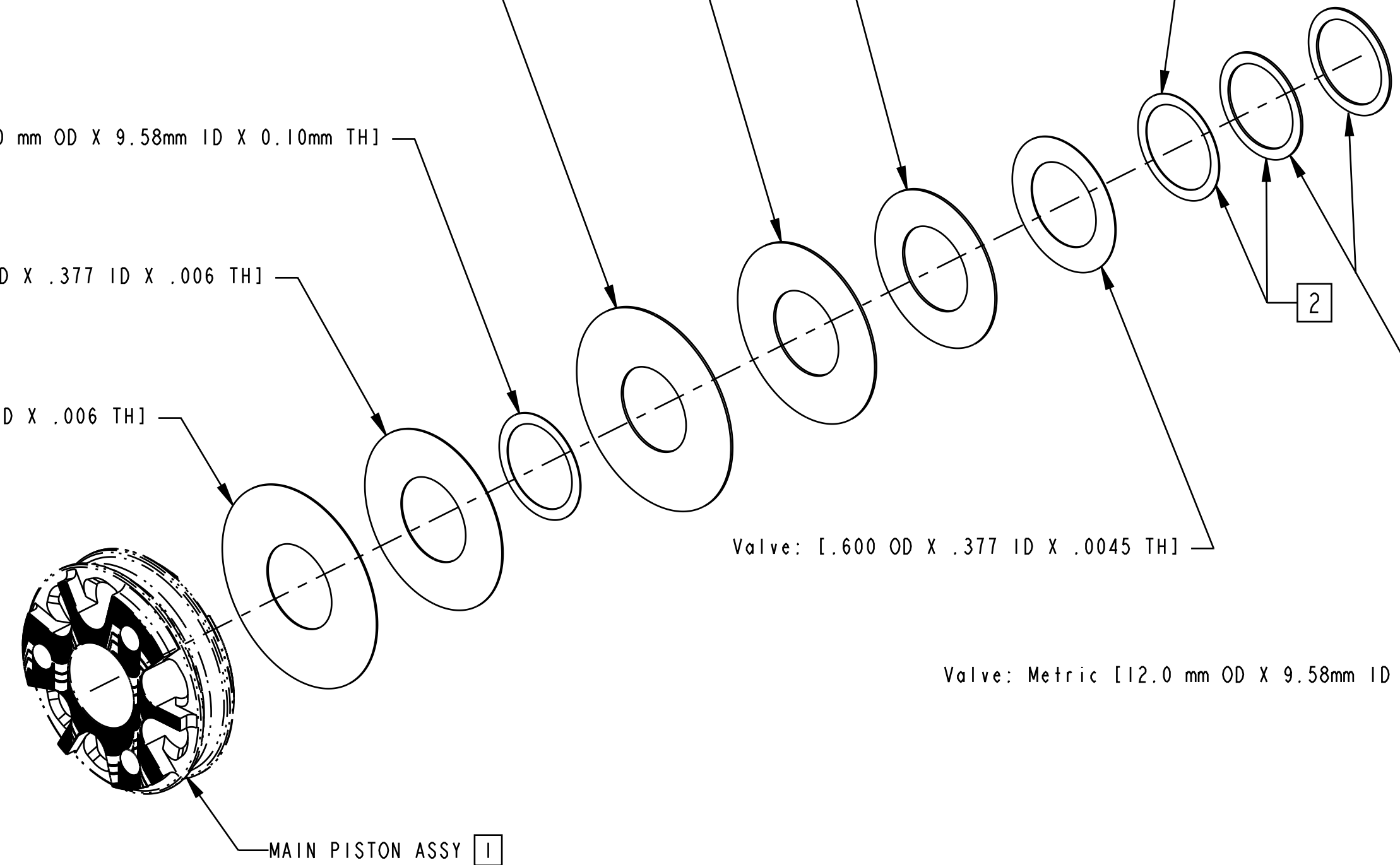

NOTES: UNLESS OTHERWISE SPECIFIED

1 MAIN PISTON ASSEMBLY SHOWN FOR ORIENTATION PURPOSES. NOTE PROPER ORIENTATION OF PISTON--SEE VALVING ASSEMBLY DRAWING FOR DETAILS. IMAGE SHOWN MAY NOT REPRESENT ACTUAL PART GEOMETRY.

2 1 SPACER MAY BE ADDED OR REMOVED TO ADJUST NUMBER OF REBOUND CLICKS.

3 DIMENSION APPLIES TO VALVE STACK AS SHOWN. ADD OR SUBTRACT THICKNESS FOR ANY VALVES ADDED OR REMOVED PER NOTE 2.

- PROPRIETARY -  
THIS DOCUMENT CONTAINS CONFIDENTIAL, PROPRIETARY INFORMATION  
THAT IS FOX PROPERTY. DO NOT DISCLOSE TO OR DUPLICATE  
FOR OTHERS EXCEPT AS AUTHORIZED BY FOX.

|   |            |   |              |                                     |
|---|------------|---|--------------|-------------------------------------|
| <b>FOX</b>                                |            | <b>FOX Factory, Inc.</b>                                    |              | Ph 831-768-1100<br>Fax 831-768-9312 |
| 130 Hangar Way, Watsonville, CA 95076 USA |            |   |              |                                     |
| TITLE                                     |            | Valve Stack Assy: 2022 FLOAT X<br>& DHX, Compression, CM+SS |              |                                     |
| SIZE                                      | DWG. NO.   | 805-05-535-KIT  |              |                                     |
| C   | PLOT SCALE | 2:1   | SHEET 1 OF 1 |                                     |

4

3

2

ProE ASSEM