

4

3

2

1

D

D

C

C

B

B

A

A

IMPORTANT:
ENSURE VALVES ARE NOT
PINCHED DURING ASSEMBLY

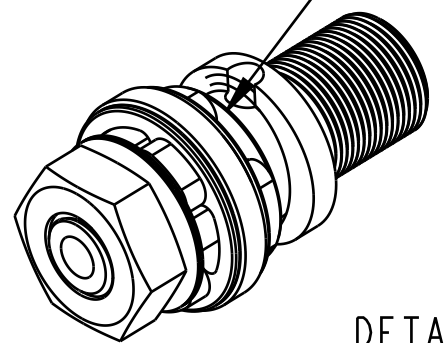

DETAIL A
SCALE 2.000

GREASE:
THIN LAYER OF SLICK HONEY
ON BULLET TOOL

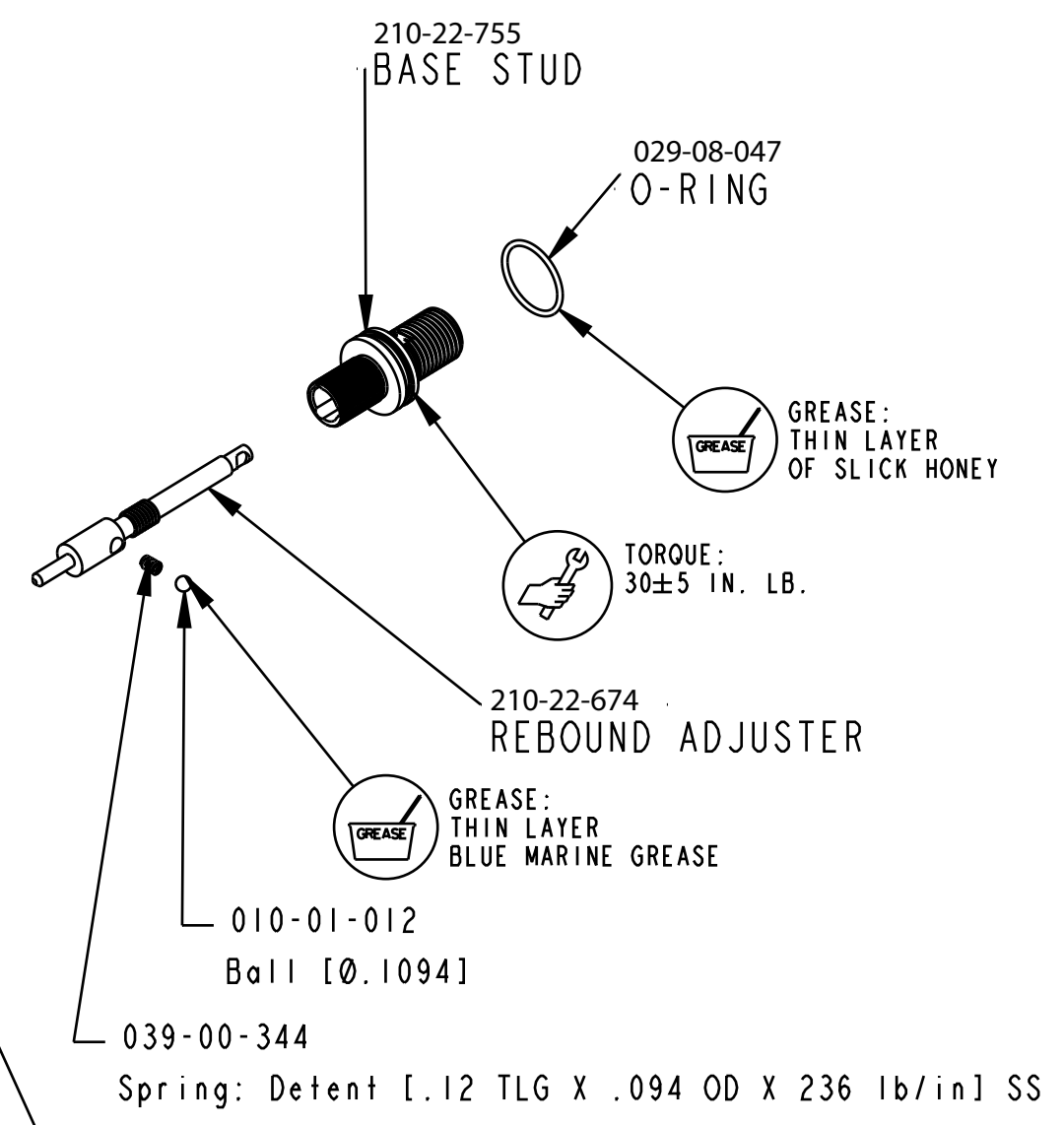

210-22-755
BASE STUD

029-08-047
O-RING

GREASE:
THIN LAYER
OF SLICK HONEY

TORQUE:
30±5 IN. LB.

210-22-674
REBOUND ADJUSTER

GREASE:
THIN LAYER
BLUE MARINE GREASE

010-01-012
Ball [Ø.1094]

039-00-344

Spring: Detent [.12 TLG X .094 OD X 236 lb/in] SS

820-03-464-KIT
BEARING HOUSING ASSY

229-10-138
REBOUND SHAFT

204-74-022
REBOUND TUBE

039-00-131
Spring: [.690 TLG X .242 ID X 22.0 lb/in] Stainless Steel

029-08-026
Seals: O-Ring [2.0 MM ID x 1.5 MM CS] Metric, N-60, Static

210-22-673
Needle, Rebound, 2016 FIT4 40RC

GREASE:
THIN LAYER
OF SLICK HONEY

TORQUE:
30±5 IN. LB.

820-03-465-KIT
REBOUND ASSY

SEE DETAIL A

PROPRIETARY
THIS DOCUMENT CONTAINS CONFIDENTIAL, PROPRIETARY INFORMATION
THAT IS FOX PROPERTY. DO NOT DISCLOSE TO OR DUPLICATE
FOR OTHERS EXCEPT AS AUTHORIZED BY FOX.

		FOX Factory, Inc.		Ph 831-768-1100
		130 Hangar Way, Watsonville, CA 95076 USA		Fax 831-768-9312
TITLE		2017 40 Rebound Tube Damper Shaft Assy		
SIZE	DWG. NO.	820-03-472-KIT		
C				
PLOT SCALE .00 : 1		SHEET OF 1		

4

3

2

1

ProE ASSEM