

4

3

2

1

D

D

C

C

B

B

A

A

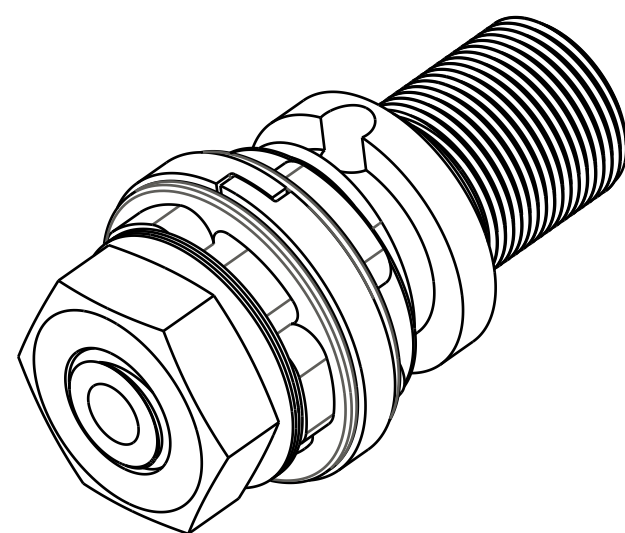

045-00-149  
Valve: Metric [8.0mm OD X 6.40mm ID X 0.152mm TH]

044-10-035  
Valve: [.350 OD X .252 ID X 0.010 TH]

018-00-012  
Nut [1/4-28 X 5/32 TLG]

TORQUE:  
HAND TIGHT

002-02-011  
Glide Ring, 04 Slim R\_RL\_RLC\_X

210-10-105  
Piston: Rebound, Kidney, 35/65 Flow

039-00-120  
Spring: Rebound Check, 09 36\_40

044-08-050  
Valve: [.500 OD X 0.252 ID X 0.008 TH]

(044-08-050)

(045-00-149)

IMPORTANT:  
ORIENT SPRING SO CLOSED  
END FACES SHAFT STUD

IMPORTANT:  
NOTE PISTON  
ORIENTATION

210-22-881  
Shaft Stud, FIT4

GREASE:  
THIN LAYER  
OF SLICK HONEY

029-08-029  
Seals: O-Ring [7.0MM ID x 1.0MM CS] Metric, N-70, Static

045-00-035  
Valve: Metric [13.0mm OD X 8.1mm ID X 0.15mm TH]

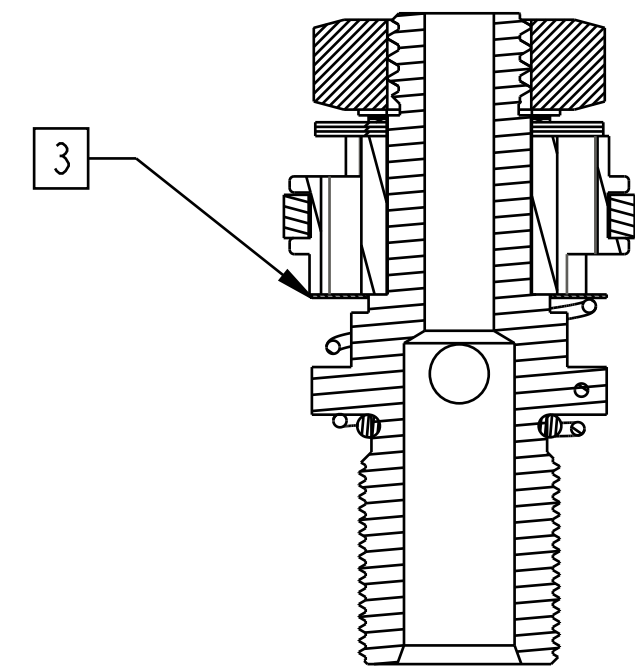

3 ENSURE VALVES ARE NOT PINCHED DURING ASSEMBLY

PROPRIETARY -  
THIS DOCUMENT CONTAINS CONFIDENTIAL, PROPRIETARY INFORMATION  
THAT IS FOX PROPERTY. DO NOT DISCLOSE TO OR DUPLICATE  
FOR OTHERS EXCEPT AS AUTHORIZED BY FOX.

		<b>FOX Factory, Inc.</b>	Ph 831-768-1100
		130 Hangar Way, Watsonville, CA 95076 USA	Fax 831-768-9312
TITLE			
<b>2016 RC2</b>			
<b>Rebound Piston Assy, 831</b>			
SIZE	DWG. NO.		
<b>C</b>	<b>820-03-484 -KIT</b>		
PLOT SCALE 3.00:1		SHEET 1 OF 1	

4

3

2

1

ProE ASSEM