

REFERENCE ONLY
(FOR INSTALLATION
INTO FORK)

TORQUE:
50±5 IN-LB

Rebound Knobs:
210-24-006: Knob, Rebound Adjust, Extruded, 2016 32 29in 15x110QR
210-22-523: Knob: Rebound Adj, Extruded

TORQUE:
5.0±1.0 IN-LB

LOCTITE:
BLUE 242
ONE DROP

018-01-004-A
Fastener, Standard: Screw [#8-32 X 0.250 TLG]

241-00-005
Fastener, Custom: Nut, Bottom, R_RL_RLC

Bottom Stud Interface Parts:
820-05-334-KIT: 2016 FIT4 Bottom Stud Interface Parts 32
820-05-381-KIT: 2016 FIT4 Bottom Stud Interface Parts 32 29in 15x110QR

241-01-002-C
Fastener, Custom: Crush Washer, Plastic, R_RL_RLC

REFERENCE ONLY
(FOR INSTALLATION
INTO FORK)

TORQUE:
220±5 IN-LB

CARTRIDGE ASSY

036-01-043
Seals: U-Cup, Shore 70A, 2013 Fit-CTD and CTD-ADJ

210-22-923
Compression Adjust Knob, F-S, FIT4

TORQUE:
11±3 IN-LB

SEE DETAIL A FOR PARTS

GREASE:
THIN LAYER
BLUE MARINE

210-22-922
Lockout Knob, F-S, FIT4

019-01-095
Fastener, Standard (Metric): Screw [M3 X 6mm] SHCS, Patchlock

DO NOT TIGHTEN FASTENER AGAINST COMPRESSION ADJUSTER HARD STOP,
USE TOOL TO PREVENT KNOB FROM TURNING

820-05-330-KIT
2016 FIT4 TopCap Interface Parts F-S

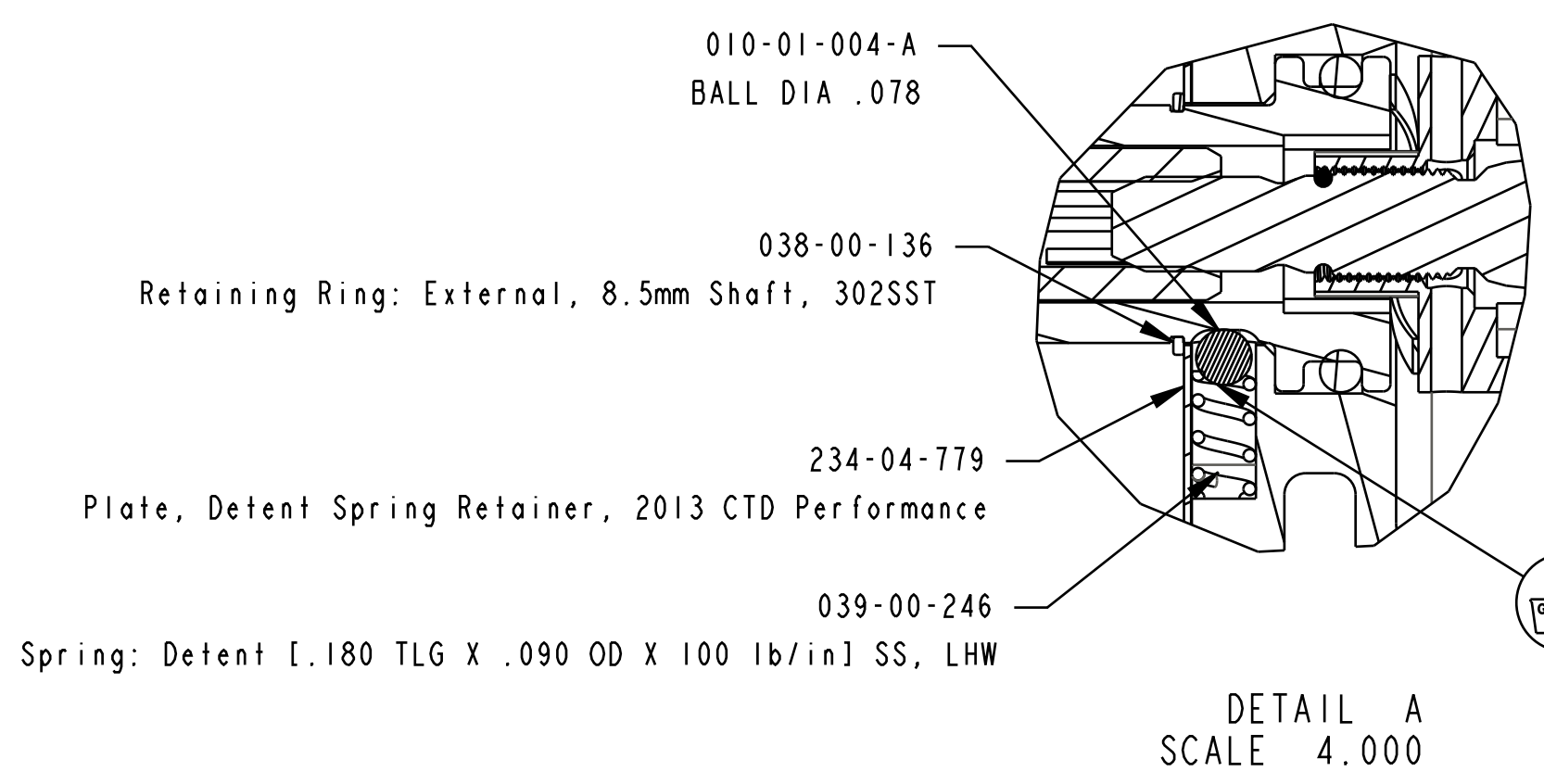

DETAIL A
SCALE 4.000

SEE DETAIL A

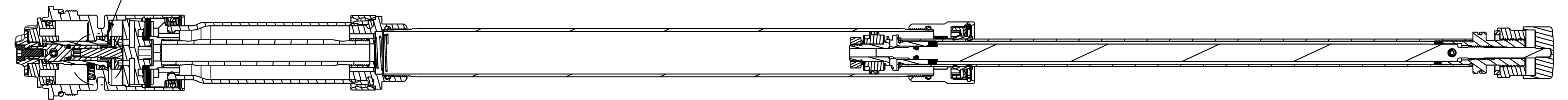

FOX Factory, Inc.
130 Hangar Way, Watsonville, CA 95076 USA
Ph 831-768-1100
Fax 831-768-9312

TITLE
**2018 32mm 26in/27.5in/29in
F-S FIT4 Cartridges Complete**

SIZE DWG. NO.
D

PLOT SCALE 1.00:1

SHEET 1 OF 1

PROPRIETARY
THIS DOCUMENT CONTAINS CONFIDENTIAL, PROPRIETARY INFORMATION
THAT IS FOR PROPERTY. DO NOT DISCLOSE TO OR DUPLICATE
FOR OTHERS EXCEPT AS AUTHORIZED BY FOX.