

ASSEMBLY INSTRUCTIONS:

1. ASSEMBLE DAMPER SHAFT ASSEMBLY TO PRESSURE TUBE.
2. FILL CARTRIDGE WITH OIL.
3. STROKE DAMPER SHAFT 5X, THEN TOP OUT.
4. FILL OIL HEIGHT TO PRESSURE TUBE BLEED HOLE.
5. TOPCAP ASSY (WITHOUT COMPRESSION NEEDLE)
 - A. SLOWLY PUSH INTO PRESSURE TUBE AND ENGAGE THREADS.
 - B. ROTATE TO ENGAGE 1-2 THREADS.
6. DIP COMPRESSION NEEDLE AND O-RING IN OIL.
7. THREAD COMPRESSION NEEDLE 3-4 TURNS.
8. TORQUE TOPCAP ASSEMBLY.

Damper Shaft Assemblies:
 820-03-490-KIT: 2017 32 Grip SC Damper Shaft Assy
 820-03-496-KIT: 2017 32 27.5 80-120 Grip Damper Shaft Assy
 820-03-497-KIT: 2017 32 29 80-120 Grip Damper Shaft Assy
 820-03-303-KIT: 2017 32 27.5 130-150, Grip Damper Shaft Assy
 820-03-304-KIT: 2017 32 29 130, Grip Damper Shaft Assy

Pressure Tubes:
 204-18-151: Pressure Tube, 20.0 Bore, Grip, 34 Rhythm & 32 27.5
 204-18-152: Pressure Tube, 20.0 Bore, Grip, 32 29 110-130 & 80-100
 204-18-154: Pressure Tube, 20.0 Bore, Grip, 32 SC

Topcap Assemblies:
 820-05-440-KIT: 2018 32, All, Grip Remote, Topcap Assy
 820-05-447-KIT: 2018 32 SC, Grip Remote, Topcap Assy

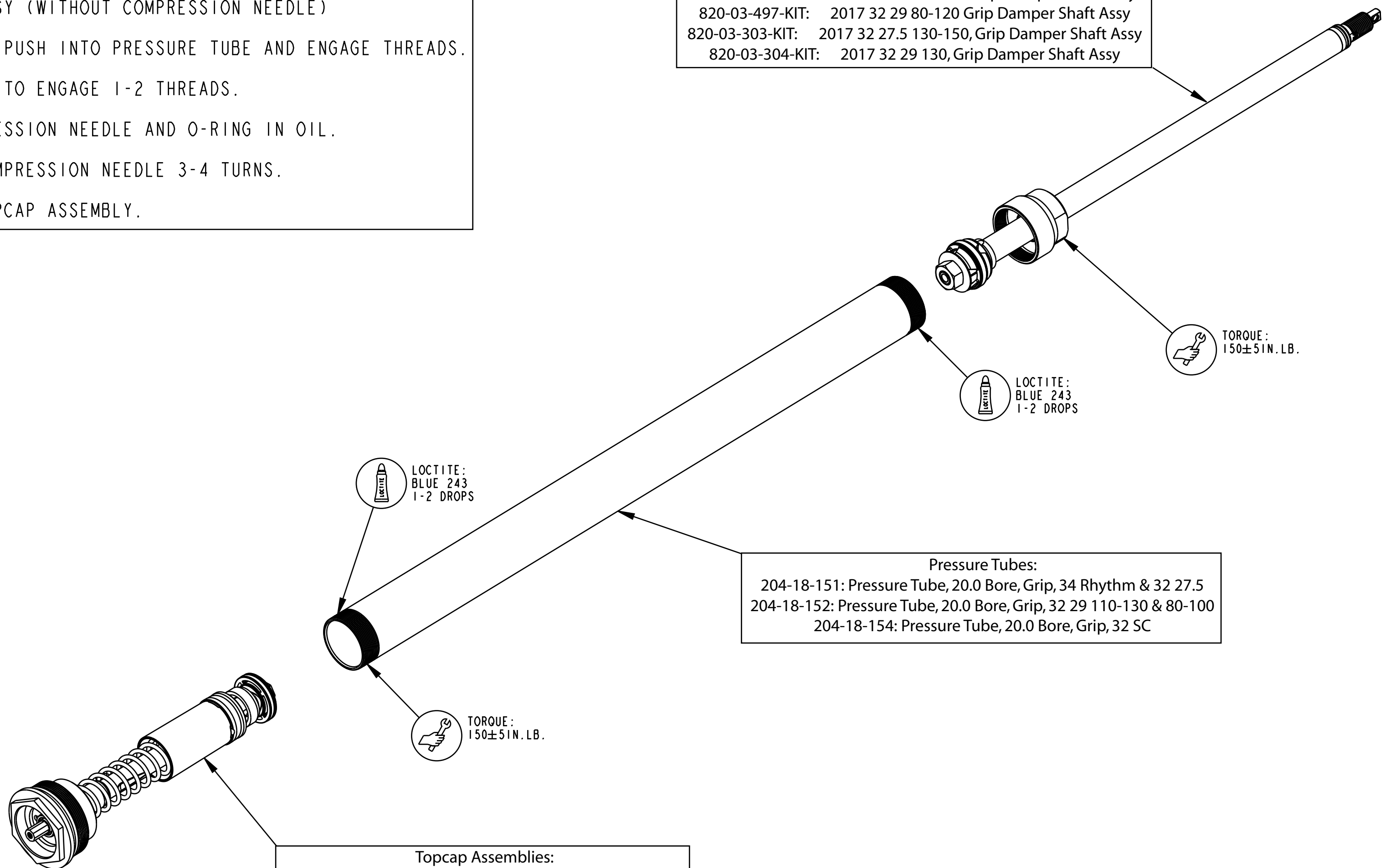

TORQUE:
150±5 IN. LB.

LOCTITE:
BLUE 243
1-2 DROPS

LOCTITE:
BLUE 243
1-2 DROPS

TORQUE:
150±5 IN. LB.

FOX FOX Factory, Inc. Ph 831-768-1100
 130 Hangar Way, Watsonville, CA 95076 USA Fax 831-768-9312
 TITLE 2018 32mm 27.5in/29in GRIP
 Remote Cartridge Assemblies

SIZE DWG. NO. C
 PLOT SCALE 0.75:1 SHEET 1 OF 1

PROPRIETARY - THIS DOCUMENT CONTAINS CONFIDENTIAL, PROPRIETARY INFORMATION THAT IS FOX PROPERTY. DO NOT DISCLOSE TO OR DUPLICATE FOR OTHERS EXCEPT AS AUTHORIZED BY FOX.