

ASSEMBLY INSTRUCTIONS:

1. ASSEMBLE DAMPER SHAFT ASSEMBLY TO PRESSURE TUBE.
2. FILL CARTRIDGE WITH OIL.
3. STROKE DAMPER SHAFT 5X, THEN TOP OUT.
4. FILL OIL HEIGHT TO PRESSURE TUBE BLEED HOLE.
5. TOPCAP ASSY (WITHOUT COMPRESSION NEEDLE)
  - A. SLOWLY PUSH INTO PRESSURE TUBE AND ENGAGE THREADS.
  - B. ROTATE TO ENGAGE 1-2 THREADS.
6. DIP COMPRESSION NEEDLE AND O-RING IN OIL.
7. THREAD COMPRESSION NEEDLE 3-4 TURNS.
8. TORQUE TOPCAP ASSEMBLY.

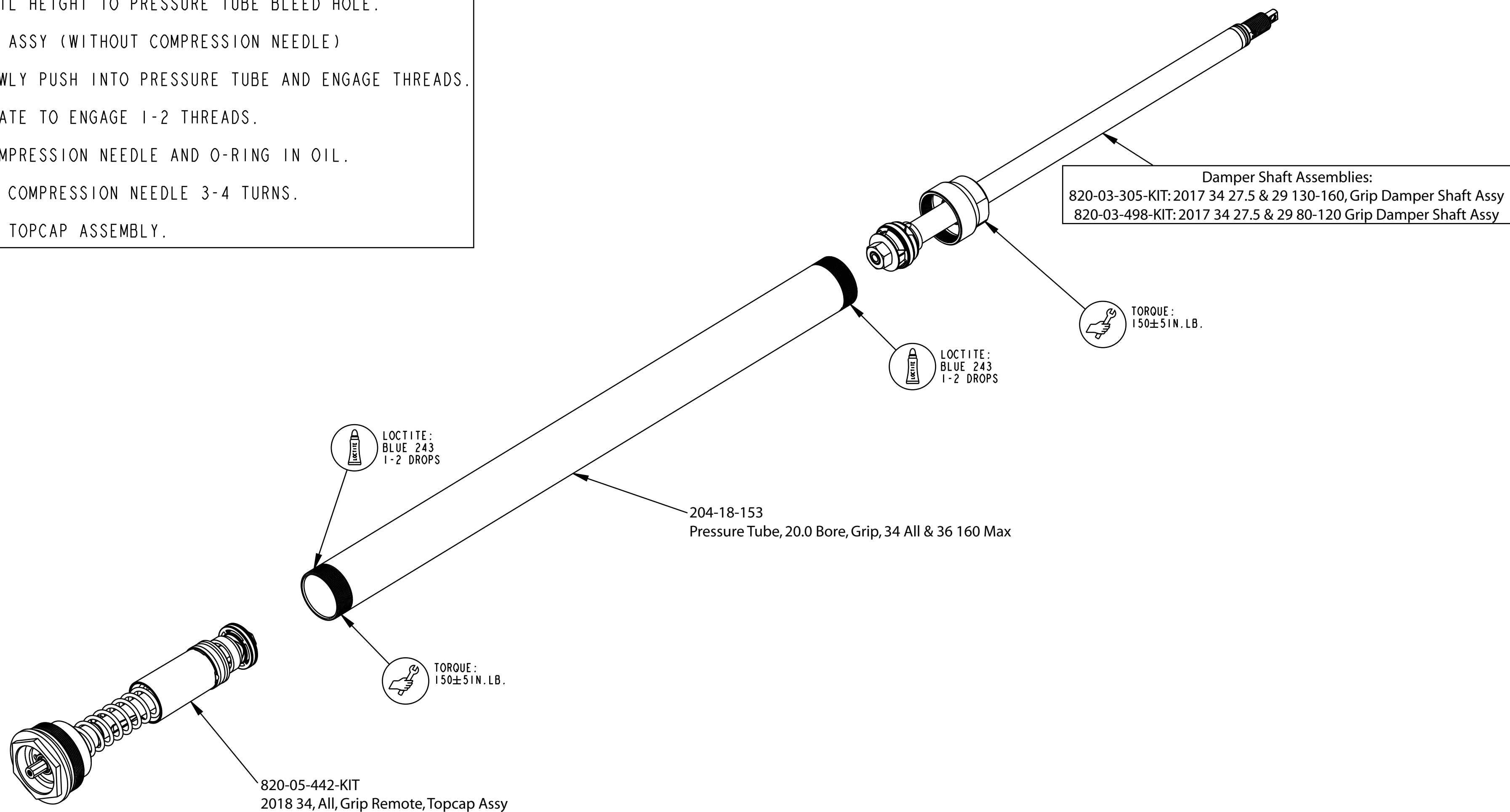

<b>FOX</b> <b>FOX Factory, Inc.</b>		Ph 831-768-1100
130 Hangar Way, Watsonville, CA 95076 USA		Fax 831-768-9312
TITLE		
2018 34mm 27.5in/29in 80-120 & 130-160		
GRIP Remote Cartridge Assemblies		
SIZE	DWG. NO.	
<b>C</b>		
PLOT SCALE	0.75:1	SHEET 1 OF 1

PROPRIETARY - THIS DOCUMENT CONTAINS CONFIDENTIAL, PROPRIETARY INFORMATION THAT IS FOX PROPERTY. DO NOT DISCLOSE TO OR DUPLICATE FOR OTHERS EXCEPT AS AUTHORIZED BY FOX.