

4

3

2

1

D

D

C

C

B

B

A

A

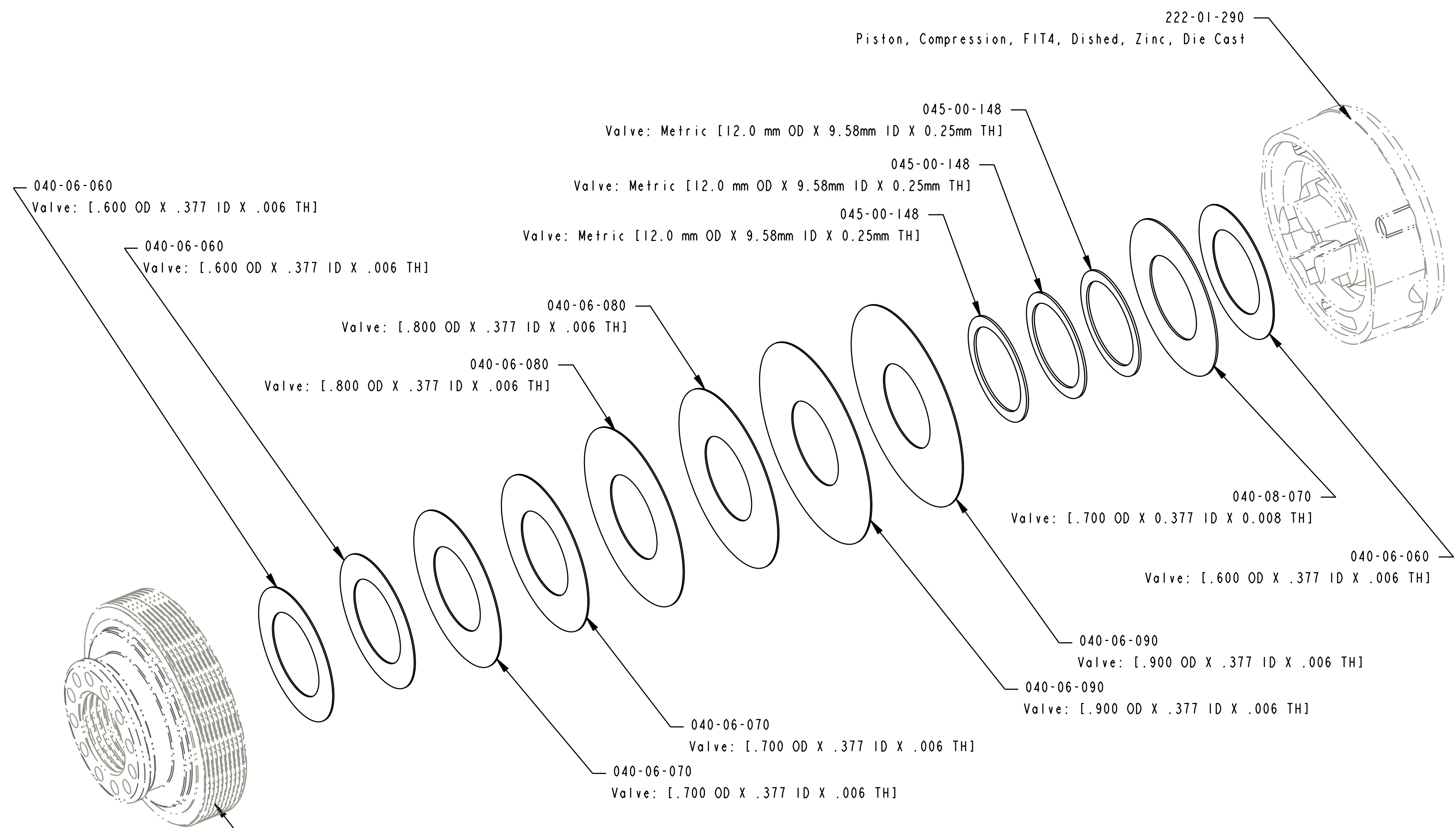

040-06-060
Valve: [.600 OD X .377 ID X .006 TH]

040-06-060
Valve: [.600 OD X .377 ID X .006 TH]

040-06-080
Valve: [.800 OD X .377 ID X .006 TH]

040-06-080
Valve: [.800 OD X .377 ID X .006 TH]

040-06-080

040-06-080
Valve: [.800 OD X .377 ID X .006 TH]

040-06-070
Valve: [.700 OD X .377 ID X .006 TH]

040-06-070
Valve: [.700 OD X .377 ID X .006 TH]

040-06-090
Valve: [.900 OD X .377 ID X .006 TH]

040-06-090
Valve: [.900 OD X .377 ID X .006 TH]

045-00-148
Valve: Metric [12.0 mm OD X 9.58mm ID X 0.25mm TH]

045-00-148
Valve: Metric [12.0 mm OD X 9.58mm ID X 0.25mm TH]

045-00-148
Valve: Metric [12.0 mm OD X 9.58mm ID X 0.25mm TH]

040-08-070
Valve: [.700 OD X 0.377 ID X 0.008 TH]

040-06-060
Valve: [.600 OD X .377 ID X .006 TH]

222-01-290
Piston, Compression, FIT4, Dished, Zinc, Die Cast

210-22-997
Compression Piston Clamp, FIT4

- PROPRIETARY -
THIS DOCUMENT CONTAINS CONFIDENTIAL, PROPRIETARY INFORMATION
THAT IS FOX PROPERTY. DO NOT DISCLOSE TO OR DUPLICATE
FOR OTHERS EXCEPT AS AUTHORIZED BY FOX.

		FOX Factory, Inc.		Ph 831-768-1100
		130 Hangar Way, Watsonville, CA 95076 USA		Fax 831-768-9312
TITLE 2017 FIT4 SC Compression Valving Assy, VC49				
SIZE C	DWG. NO. 820-03-522-KIT			
PLOT SCALE 3.00:1			SHEET 1 OF 1	

4

3

2

1

ProE ASSEM