

4

3

2

1

ASSEMBLY INSTRUCTIONS:

1. ASSEMBLE DAMPER SHAFT ASSEMBLY TO PRESSURE TUBE
2. FILL CARTRIDGE 1/2 FULL WITH OIL
3. STROKE DAMPER SHAFT 5X, THEN TOP OUT DAMPER SHAFT
4. FILL OIL HEIGHT TO PRESSURE TUBE BLEED HOLE
5. TOPCAP ASSY
 - A. SLOWLY PUSH INTO PRESSURE TUBE AND ENGAGE TOPCAP THREADS
 - B. ROTATE TO ENGAGE 1-2 THREADS
6. TORQUE TOPCAP AND SEALHEAD ASSEMBLIES
7. STROKE DAMPER SHAFT APPROXIMATELY 75% OF MAX DAMPER TRAVEL TO EXPELL EXCESS OIL

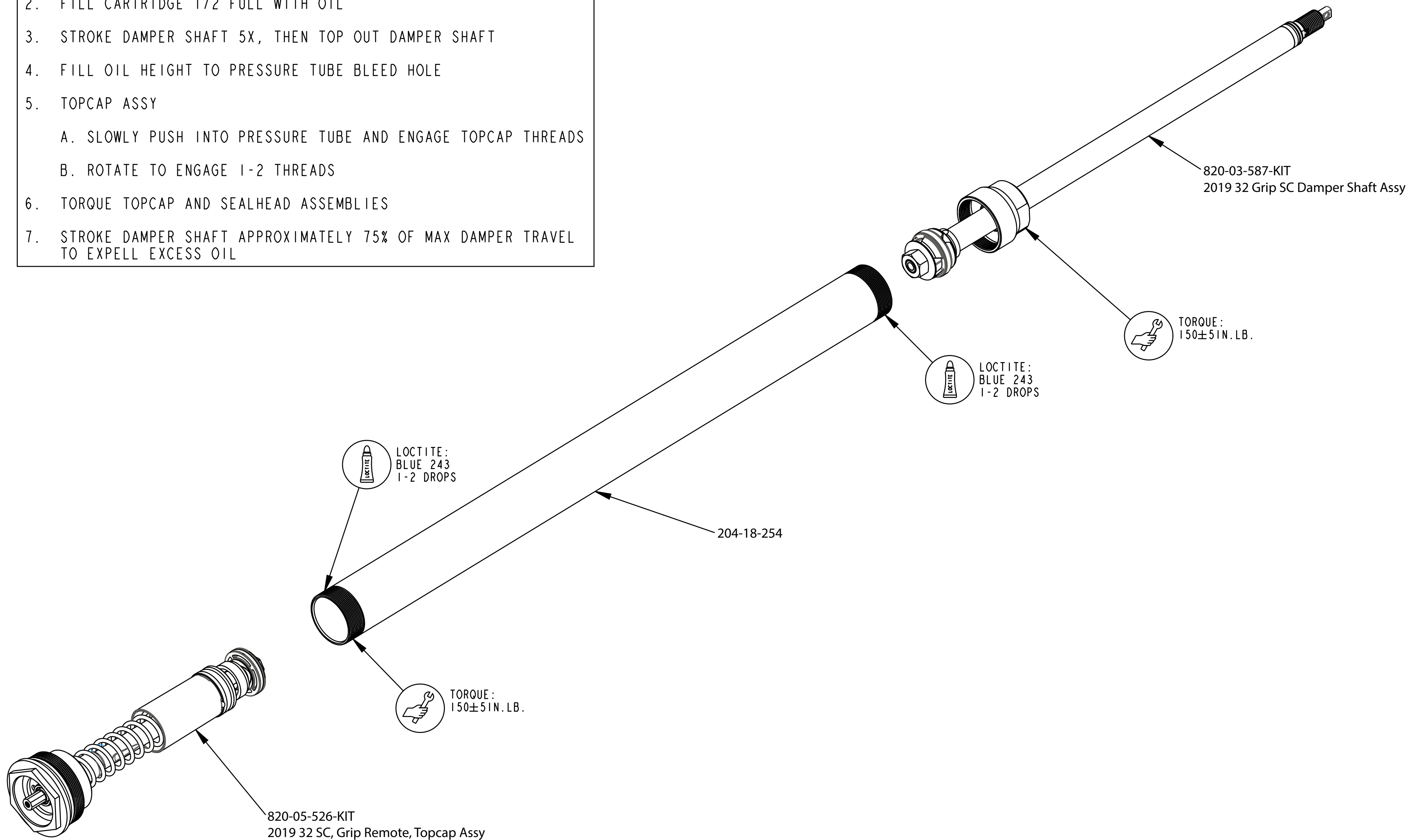

FOX FOX Factory, Inc. Ph 831-768-1100
130 Hangar Way, Watsonville, CA 95076 USA Fax 831-768-9312

TITLE
2019 32 27.5in & 29in SC
80-100, Grip Remote Cart Assy

SIZE DWG. NO.

C

PLOT SCALE 0.75:1

SHEET 1 OF 1

- PROPRIETARY -
THIS DOCUMENT CONTAINS CONFIDENTIAL, PROPRIETARY INFORMATION
THAT IS FOX PROPERTY. DO NOT DISCLOSE TO OR DUPLICATE
FOR OTHERS EXCEPT AS AUTHORIZED BY FOX.

4

3

2