

ASSEMBLY INSTRUCTIONS:

1. ASSEMBLE DAMPER SHAFT ASSEMBLY TO PRESSURE TUBE
2. FILL CARTRIDGE 1/2 FULL WITH OIL
3. STROKE DAMPER SHAFT 5X, THEN TOP OUT DAMPER SHAFT
4. FILL OIL HEIGHT TO PRESSURE TUBE BLEED HOLE
5. TOPCAP ASSY
 - A. SLOWLY PUSH INTO PRESSURE TUBE AND ENGAGE TOPCAP THREADS
 - B. ROTATE TO ENGAGE 1-2 THREADS
6. TORQUE TOPCAP AND SEALHEAD ASSEMBLIES
7. STROKE DAMPER SHAFT APPROXIMATELY 75% OF MAX DAMPER TRAVEL TO EXPELL EXCESS OIL

DAMPER SHAFT ASSEMBLIES:
 820-03-568-KIT: 2019 36 180 MAX, Grip Damper Shaft Assy
 820-03-593-KIT: 2019 36 180 MAX, Grip E-Bike Damper Shaft Assy

PRESSURE TUBES:
 204-18-155: Pressure Tube, 20.0 Bore, Grip, 36 180 Max
 204-18-255: Pressure Tube, FIT Grip, Hard Ano, 36 180 Max

TOPCAP ASSEMBLIES:
 820-05-509-KIT: 2019 36 180 MAX, Grip Damper, Topcap Assy
 820-05-535-KIT: 2019 36 180 MAX, Grip E-Bike Damper, Topcap Assy

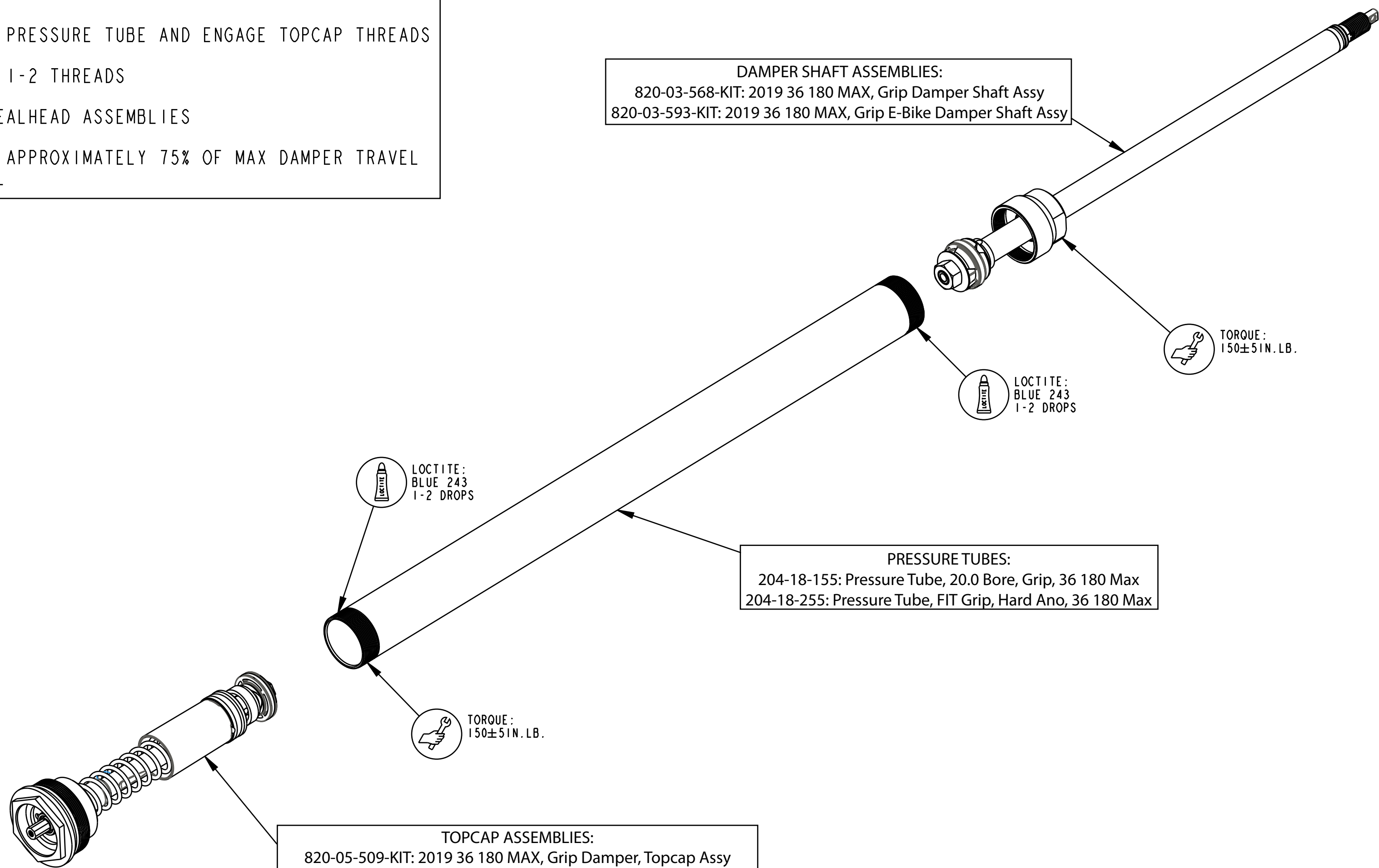

		FOX Factory, Inc.	Ph 831-768-1100
		130 Hangar Way, Watsonville, CA 95076 USA	Fax 831-768-9312
TITLE		2019 36 Rhythm	
		Grip Cartridge Assemblies	
SIZE	DWG. NO.		
C			
PLOT SCALE 0.75:1		SHEET 1 OF 1	

- PROPRIETARY -
 THIS DOCUMENT CONTAINS CONFIDENTIAL, PROPRIETARY INFORMATION
 THAT IS FOX PROPERTY. DO NOT DISCLOSE TO OR DUPLICATE
 FOR OTHERS EXCEPT AS AUTHORIZED BY FOX.