

LOCTITE:  
RED 263, 1 DROP  
APPLY PER 605-14-175

(241-02-106)

DETAIL B  
SCALE 2:1

019-02-025 Fastener, Standard (Metric), Nut, M6 x .75

039-00-349 Spring: [0.200 TLG X .400 ID X 0.50 lbs/in] Stainless Steel

045-00-151 Valve: Metric [8.00mm OD X 5.55mm ID X 0.25mm THK] Custom, Check

029-08-188 O-Ring [17mm ID X 1.5mm CS], N-90, Static

TORQUE: 16 ± 1 IN-LB

Seals: O-Ring [8mm ID X 1.5mm CS] Metric, N-70, Static

210-22-957 Damping Adj Part: Hat Preload Comp

Seals: O-Ring [16.0mm ID X 2.0mm CS] Metric, N-70, Dynamic

029-03-011 O-Ring (-011) [.070 C.S. X .301 ID]

Bearing: External, [.13 W X .128 ID X .030 TH], PA6

Seals: O-Ring [4.0mm ID x 1.5mm CS] Metric, N-70, Static

002-02-091 Bearing: External, Slit [.13 W X .244 OD X .030 TH], PA6

Bearing: External, Slit [.13 W X .244 OD X .030 TH], PA6

GREASE:  
THIN LAYER  
OF SLICK HONEY

IMPORTANT:  
NOTE ORIENTATION.  
THIS END TAPERED

231-00-025 Sleeve: Isolator, Spring, ID, Grip

019-01-116 Fastener Standard (Metric): PIN SS 2 X 12

229-10-781 Shaft, Damper, Comp, 8mm, 2020 Grip Remote, 32, 34

029-03-024-A Seals: O-Ring [(-024) .070 C.S. X 1.114 ID] Standard, N-70, Static

Damping Adj Part: Topcap, 34, 2020 GRIP Remote, Black Ano

SEE DETAIL B

GREASE:  
THIN LAYER  
OF SLICK HONEY

222-01-295 Piston Damping Comp 20.0 Bore

820-03-617-KIT 2020 Grip Remote E-Bike Compression Valving

241-02-106 Fastener, Custom: Bolt Piston Comp Grip

GREASE:  
THIN LAYER  
OF SLICK HONEY

223-00-049 Piston Floating: IFP, Grip

231-00-026 Sleeve: Isolator, Spring, OD, Grip

210-03-301 Damping Adj Part: Needle, Comp, Grip Remote, Bushings, 32, 34

039-00-378 Spring, Piston, Floating, Grip 160

SEE DETAIL A

IMPORTANT:  
ORIENTATION OF PISTON IS CRITICAL  
ONE RAISED RING TOWARDS TOPCAP

IMPORTANT:  
DO NOT PINCH VALVES

IMPORTANT:  
DO NOT PINCH CHECK VALVE

DETAIL A  
SCALE 6:1

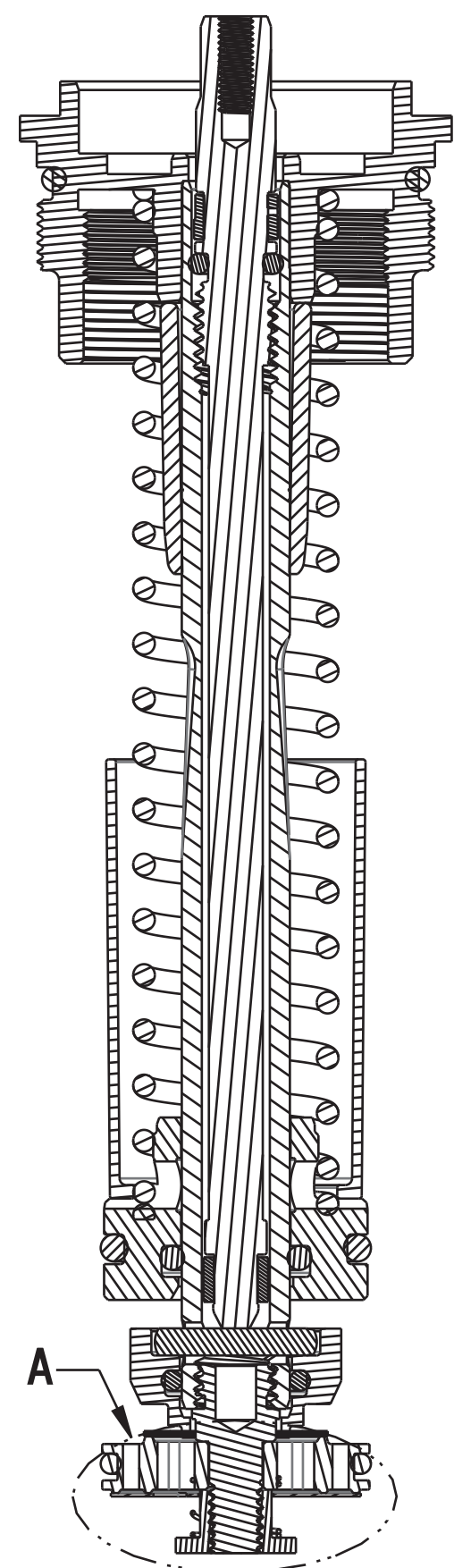

SECTION A-A  
SCALE 2:1

PROPRIETARY - THIS DOCUMENT CONTAINS CONFIDENTIAL, PROPRIETARY INFORMATION THAT IS FOX PROPERTY. DO NOT DISCLOSE TO OR DUPLICATE FOR OTHERS EXCEPT AS AUTHORIZED BY FOX.

**FOX Factory, Inc.** Ph 831-768-1100  
 130 Hangar Way, Watsonville, CA 95076 USA Fax 831-768-9312

TITLE **2020 34, Grip E-Bike+ Remote, Topcap Assy**

SIZE DWG. NO. **C 820-05-607-KIT**

PLOT SCALE 1:1 SHEET 1 OF 1