

4

3

2

1

D

D

C

C

B

B

A

A

**TOPCAP ASSEMBLIES:**  
 820-05-418-KIT: Topcap Assy, 2018, FLOAT LC NA 2, 32, Black  
 820-05-431-KIT: Topcap Assy, FLOAT LC NA 2, 32, Black Ano, Hollow Volume Spacer, 33cc  
 820-05-430-KIT: Topcap Assy, FLOAT LC NA 2, 32, Black Ano, Hollow Volume Spacer, 22cc

241-00-005  
 Fastener, Custom: Nut, Bottom, R\_RL\_RLC

241-01-002  
 Fastener, Custom: Crush Washer, Plastic, R\_RL\_RLC

038-00-091  
 Retaining Ring: Internal, Smalley EH-29-S02, 302 SS

**TORQUE:**  
 50±5 IN.LB.  
 (INTO FORK CHASSIS)

**IMPORTANT:**  
 INSPECT 100% THAT RETAINING RING  
 IS FULLY INSTALLED INTO GROOVE FULL 360°

029-03-008  
 O-Ring (-008) [.070 C.S. X .176 ID]

**AIR SHAFT ASSEMBLIES:**  
 820-02-417-KIT: Air Shaft Assy, 2018, 32, 26in & 27.5 140mm, FLOAT LC NA 2, 1.110 Bore  
 820-02-422-KIT: Air Shaft Assy, 2018, 32, 26in & 27.5in 100mm, FLOAT LC NA 2, 1.110 Bore  
 820-02-424-KIT: Air Shaft Assy, 2018, 32, 26in & 27.5in 120mm, 29in 90mm, FLOAT LC NA 2, 1.110 Bore  
 820-02-425-KIT: Air Shaft Assy, 2018, 32, 29in 100mm, FLOAT LC NA 2, 1.110 Bore  
 820-02-427-KIT: Air Shaft Assy, 2018, 32, 29in 120mm, FLOAT LC NA 2, 1.110 Bore

**GREASE:**  
 THIN LAYER  
 OF SLICK HONEY

**TORQUE:**  
 220±5 IN.LB.  
 (INTO FORK CHASSIS)

234-04-811  
 Volume Spacer, FLOAT NA 2, 32

234-04-881  
 Air Cap, FLOAT NA 2, 32 & 34, Blue Ano

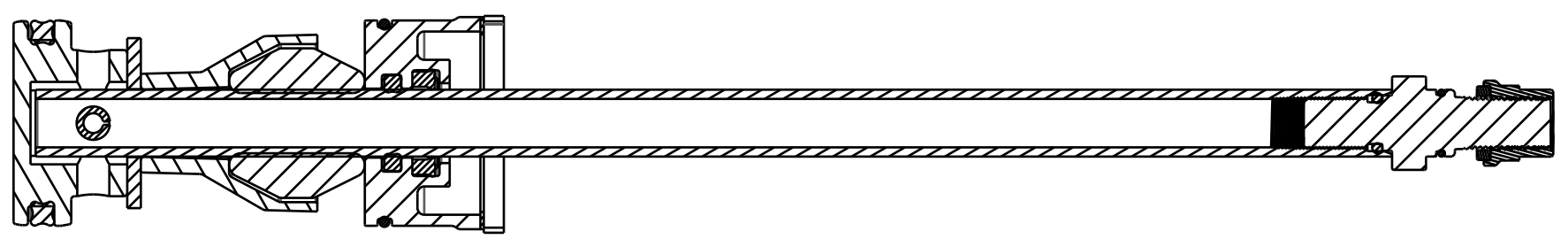
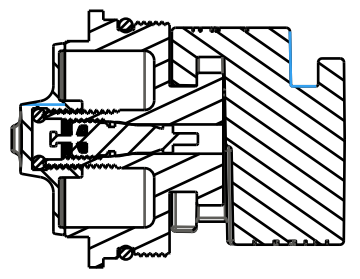

SECTION A-A

- PROPRIETARY -  
 THIS DOCUMENT CONTAINS CONFIDENTIAL, PROPRIETARY INFORMATION  
 THAT IS FOX PROPERTY. DO NOT DISCLOSE TO OR DUPLICATE  
 FOR OTHERS EXCEPT AS AUTHORIZED BY FOX.

		<b>FOX Factory, Inc.</b>	Ph 831-768-1100
		130 Hangar Way, Watsonville, CA 95076 USA	Fax 831-768-9312
TITLE			
2020 32 FLOAT NA2			
Air Spring Assemblies			
SIZE DWG. NO.			
C			
PLOT SCALE   .00:1		SHEET   OF	