

4

3

2

1

D

D

C

C

B

B

A

A

LOCTITE:  
RED 263, 1 DROP  
APPLY PER 605-14-175

DETAIL B  
SCALE 2:1

019-02-025 Fastener, Standard (Metric), Nut, M6 x .75  
 039-00-349 Spring: [0.200 TLG X .400 ID X 0.50 lbs/in] Stainless Steel  
 045-00-151 Valve: Metric [8.00mm OD X 5.55mm ID X 0.25mm THK] Custom, Check  
 029-08-188 O-Ring [17mm ID X 1.5mm CS], N-90, Static

TORQUE:  
16 ± 1 IN-LB

GREASE:  
THIN LAYER  
OF SLICK HONEY

GREASE:  
THIN LAYER  
OF SLICK HONEY

(241-02-106)

Seals: O-Ring [8mm ID X 1.5mm CS] Metric, N-70, Static

Damping Adj Part: Hat Preload Comp

Seals: O-Ring [16.0mm ID X 2.0mm CS] Metric, N-70, Dynamic

O-Ring (-011) [.070 C.S. X .301 ID]

Bearing: External, [.13 W X .128 ID X .030 TH], PA6

Seals: O-Ring [4.0mm ID x 1.5mm CS] Metric, N-70, Static

Bearing: External, Slit [.13 W X .244 OD X .030 TH], PA6

GREASE:  
THIN LAYER  
OF SLICK HONEY

IMPORTANT:  
NOTE ORIENTATION.  
THIS END TAPERED

SEE DETAIL A

IMPORTANT:  
ORIENTATION OF PISTON IS CRITICAL  
ONE RAISED RING TOWARDS TOPCAP

IMPORTANT:  
DO NOT PINCH VALVES

IMPORTANT:  
DO NOT PINCH CHECK VALVE

DETAIL A  
SCALE 6:1

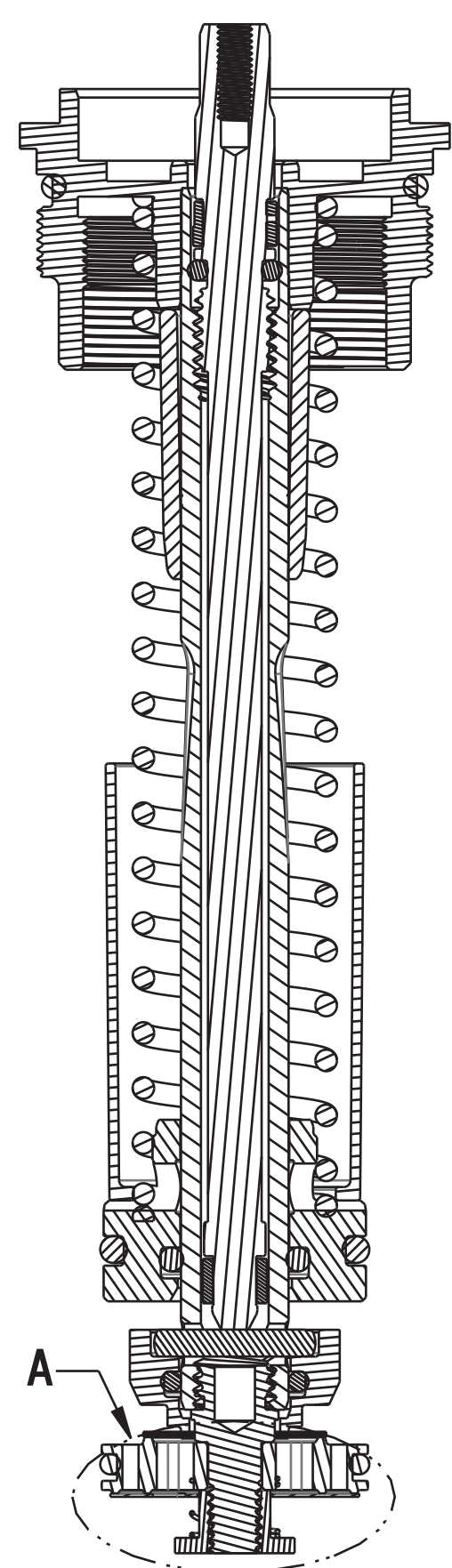

SECTION A-A  
SCALE 2:1

029-08-084  
210-22-957  
029-08-196  
029-03-011  
002-02-089  
029-08-108  
002-02-091  
039-00-378  
231-00-026  
210-03-301  
039-00-378  
231-00-025  
019-01-116  
229-10-781  
029-03-022-A  
Damping Adj Part: Topcap, 32, 2020 GRIP Remote, Black Ano

222-01-295 Piston Damping Comp 20.0 Bore  
820-03-616-KIT 2020 Grip Remote Compression Valving  
241-02-106 Fastener, Custom: Bolt Piston Comp Grip

223-00-049 Piston Floating: IFP, Grip

231-00-026 Sleeve: Isolator, Spring, OD, Grip

210-03-301 Damping Adj Part: Needle, Comp, Grip Remote, Bushings, 32, 34

039-00-378 Spring, Piston, Floating, Grip 160

231-00-025 Sleeve: Isolator, Spring, ID, Grip

019-01-116 Fastener Standard (Metric): PIN SS 2 X 12

229-10-781 Shaft, Damper, Comp, 8mm, 2020 Grip Remote, 32, 34

029-03-022-A Seals: O-Ring [(-022) .070 C.S. X 0.989 ID] Standard, N-70, Static

PROPRIETARY  
THIS DOCUMENT CONTAINS CONFIDENTIAL, PROPRIETARY INFORMATION  
THAT IS FOX PROPERTY. DO NOT DISCLOSE TO OR DUPLICATE  
FOR OTHERS EXCEPT AS AUTHORIZED BY FOX.

**FOX** FOX Factory, Inc. Ph 831-768-1100  
130 Hangar Way, Watsonville, CA 95076 USA Fax 831-768-9312

TITLE  
**2020 32, All,  
Grip Remote, Topcap Assy**

SIZE DWG. NO. **820-05-605-KIT**

PLOT SCALE 1:1 SHEET 1 OF 1

4

3

2

ProE ASSEM