

4

3

2

1

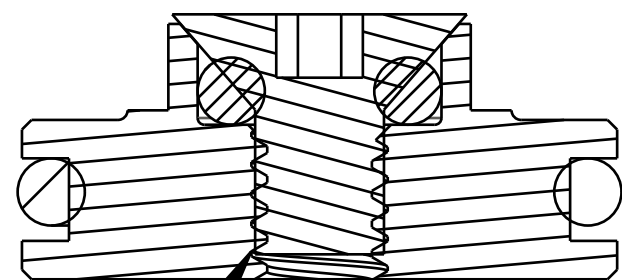
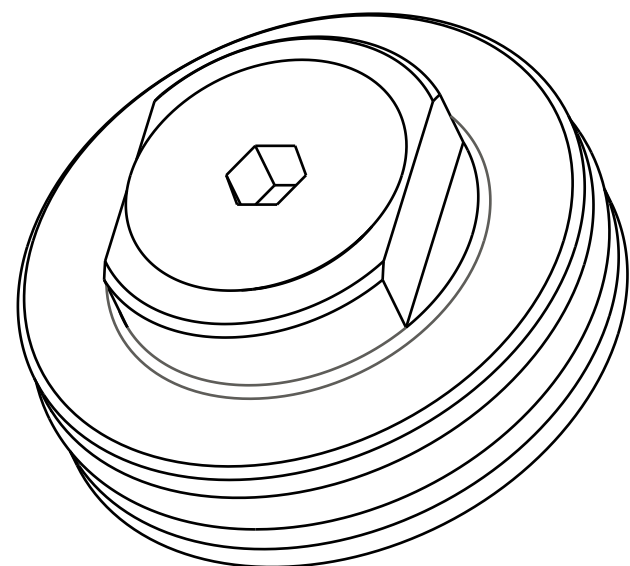

REFERENCE: Fits 398-00-749
 Service tooling: Trek Thru Shaft IFP removal tool

SECTION A-A

TORQUE:
 5 ± 1 IN-LB

GREASE:
 THIN LAYER
 SLICK HONEY

018-01-026
 Screw [#6-32 X .250 TLG]

029-03-006
 O-Ring (-006) [.070 C.S. X .114 ID]

Piston: Floating w/bleed, 9mm thru shaft, [.625 bore, .620 OD]

029-03-014
 O-Ring (-014) [.070 C.S. X .489 ID]

FOX **FOX Factory, Inc.** Ph 831-768-1100
 130 Hangar Way, Watsonville, CA 95076 USA Fax 831-768-9312

TITLE Piston Assembly: Floating,
 With Bleed, [.625 Bore],
 9mm Thru Shaft

SIZE DWG. NO. **C** 805-00-117-KIT

PLOT SCALE 5:1 SHEET 1 OF 1

- PROPRIETARY -
 THIS DOCUMENT CONTAINS CONFIDENTIAL, PROPRIETARY INFORMATION
 THAT IS FOX PROPERTY. DO NOT DISCLOSE TO OR DUPLICATE
 FOR OTHERS EXCEPT AS AUTHORIZED BY FOX.

4

3

2

ProE ASSEM