

4

3

2

1

Retaining Ring: Wire [1.280 OD X .024 CS] SS

Compression Adjust Coupler, F-S, FIT4

ASSEMBLE AT THIS LEVEL

820-05-619-KIT
2020 34 SC FIT4 Topcap Assy, 3 Pos Adj

TORQUE:
55±5 IN LBS

820-03-619-KIT
2020 34 SC 27.5in and 29in 120 Max FIT4
Damper Shaft Assy, 8mm Shaft

TORQUE:
55±5 IN LBS

820-03-565-KIT
2019 34 SC 27.5in and 29in 120 Max FIT4, Bladder Assy

Seals: O-Ring [3.0MM ID x 1.5MM CS] Metric, N-70, Static

Spring: Detent [.138 TLG, .087 OD, 48 lb/in]

Ball [Ø.1094]

GREASE:
THIN LAYER OF
SLICK HONEY ON BALL

ASSEMBLE THESE PARTS AFTER OIL FILL

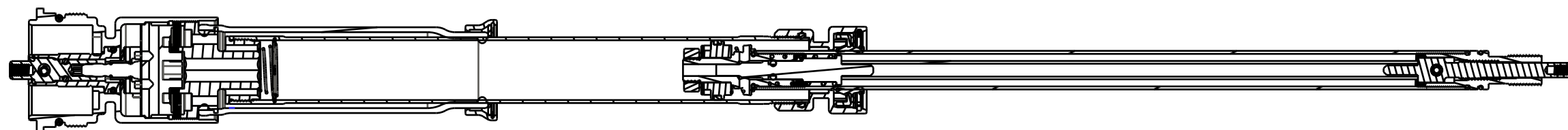

SECTION A-A
SCALE 0.750

- PROPRIETARY -
THIS DOCUMENT CONTAINS CONFIDENTIAL, PROPRIETARY INFORMATION
THAT IS FOX PROPERTY. DO NOT DISCLOSE TO OR DUPLICATE
FOR OTHERS EXCEPT AS AUTHORIZED BY FOX.

FOX **FOX Factory, Inc.** Ph 831-768-1100
130 Hangar Way, Watsonville, CA 95076 USA Fax 831-768-9312

TITLE
2020 34 SC 27.5in and 29in
120 Max FIT4 3 Pos Adj, Cart Assy

SIZE DWG. NO.
C
PLOT SCALE 1.0:1 SHEET 1 OF 1

4

3

2

1