

4

3

2

1

Retaining Ring: Wire [1.280 OD X .024 CS] SS

Compression Adjust Coupler, F-S, FIT4

ASSEMBLE AT THIS LEVEL

820-05-582-KIT
2020 34 FIT4 F-S Topcap Assy, CL Tune, Remote, U-Cup, 2 Position, Push-Lock

TORQUE:
55±5 IN LBS

820-03-604-KIT
2020 34 ALL Non-SC FIT4 8mm Damper Shaft Assy

TORQUE:
55±5 IN LBS

820-03-608-KIT
2020 32 and 34 Non-SC FIT4 8mm, Bladder Assy

Seals: O-Ring [3.0MM ID x 1.5MM CS] Metric, N-70, Static

Spring: Detent [.138 TLG, .087 OD, 48 lb/in]

Ball [Ø.1094]

GREASE:
THIN LAYER OF
SLICK HONEY ON BALL

ASSEMBLE THESE PARTS AFTER OIL FILL

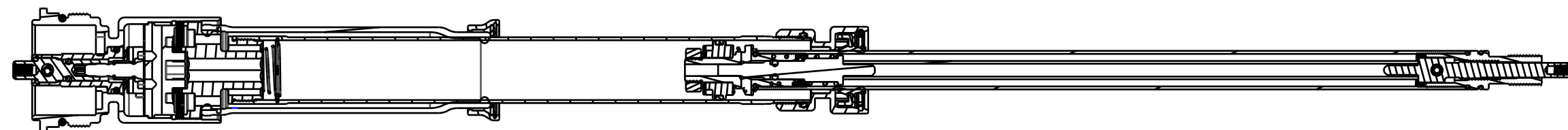

SECTION A-A
SCALE 0.750

- PROPRIETARY -
THIS DOCUMENT CONTAINS CONFIDENTIAL, PROPRIETARY INFORMATION
THAT IS FOX PROPERTY. DO NOT DISCLOSE TO OR DUPLICATE
FOR OTHERS EXCEPT AS AUTHORIZED BY FOX.

FOX FOX Factory, Inc. Ph 831-768-1100
130 Hangar Way, Watsonville, CA 95076 USA Fax 831-768-9312

TITLE
2020 34, 110-160, FIT4 F-S, CL Tune,
Remote, 2 Pos Adj, Push-Lock Cart Assy

SIZE DWG. NO.
C
PLOT SCALE 1.0:1 SHEET 1 OF 1