

4

3

2

1

Seals: O-Ring [2.5mm ID x 1mm CS] Metric, N-70, Static

Seals: O-Ring [17.5MM ID x 1.5MM CS] Metric, N-70, Static

Bearing: Oring Backup, DPX2 Remote, Rebound End Cap

O-Ring (-005) [0.070 C.S. X 0.101 ID]

End Cap: Float DPX2, Rebound side

Rebound Needle Driver, Float DPX2

Ball [Ø 0.0938] 52100 Grade 25 Steel, Chrome

Spring: Detent [0.28 TLG, .087 OD, 24 lb/in]

GREASE: THIN LAYER HIGH TEMP BLUE

GREASE: THIN LAYER ON ALL THREADS HIGH TEMP BLUE

GREASE: THIN LAYER HIGH TEMP BLUE

Ball [Ø 0.0938] 52100 Grade 25 Steel, Chrome

Fastener, Custom: Washer [0.398 OD x 0.275 ID x 0.020 TH] Stainless

Retaining Ring: Internal, D-ends, 0.400 Housing, [OD 0.443 , TH 0.025 ], 316 SS

GREASE: THIN LAYER SLICK HONEY

GREASE: THIN LAYER SLICK HONEY

IMPORTANT: ORIENTATION CRITICAL

GREASE: THIN LAYER SLICK HONEY

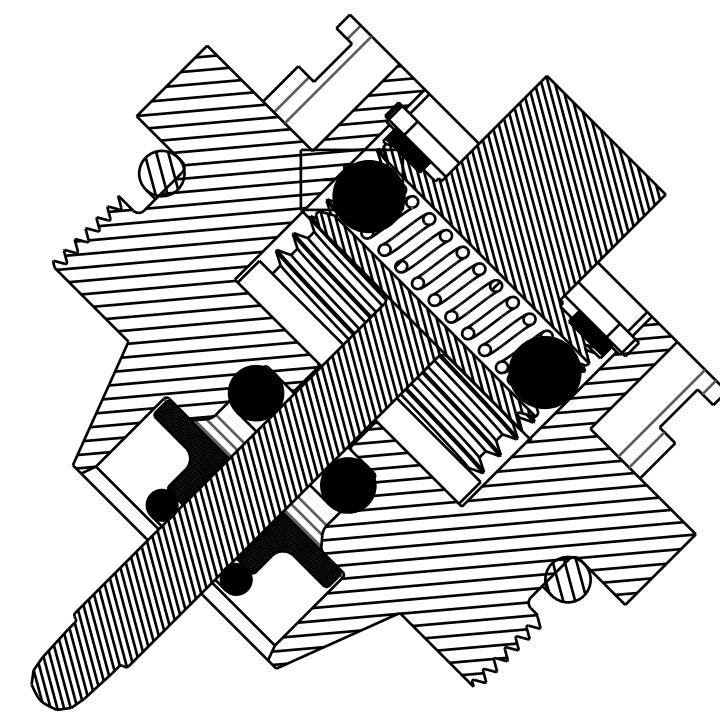

PROPRIETARY - THIS DOCUMENT CONTAINS CONFIDENTIAL, PROPRIETARY INFORMATION THAT IS FOX PROPERTY. DO NOT DISCLOSE TO OR DUPLICATE FOR OTHERS EXCEPT AS AUTHORIZED BY FOX.

**FOX** **FOX Factory, Inc.** Ph 831-768-1100  
 130 Hangar Way, Watsonville, CA 95076 USA Fax 831-768-9312

TITLE Eyelet Cap Assembly:  
 DPX2 Remote, Rebound Side

SIZE DWG. NO. **C** 804-00-156-KIT

PLOT SCALE 4:1 SHEET 1 OF 1

4

3

2

1

ProE ASSEM