

4

3

2

1

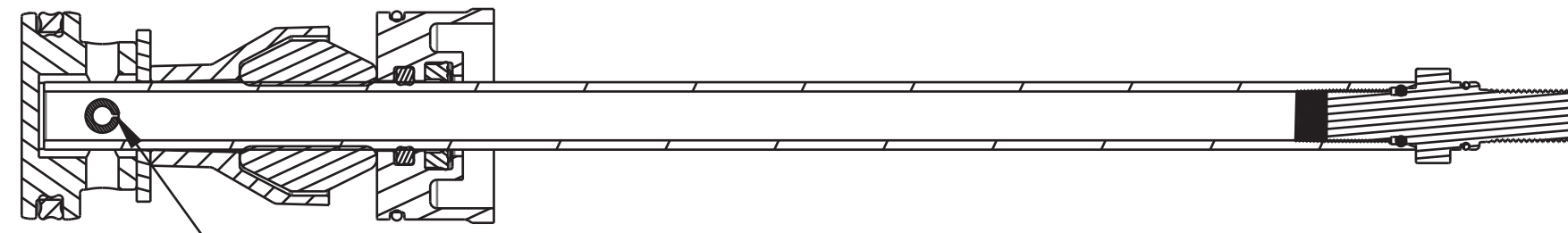

IMPORTANT:  
ORIENT GAP IN PIN TOWARDS  
TOPOUT SPACER ±15°

Seals: O-Ring [8.0MM ID x 1.0MM CS] Metric, N-70, Static

Base Stud: Float, 0.305-48 Thread

Seals: O-Ring [6.0mm ID x 1.5mm CS] Metric, N-70, Static

Topout Bumper, FLOAT NA

Topout Spacer, FLOAT NA 2, 0.040" Thick, Aluminum

TORQUE:  
50±5 IN LB

GREASE:  
THIN LAYER  
OF SLICK HONEY

Q-RING

PISTON

LOCTITE:  
1-2 DROPS  
RED 263

Topout Spacer

820-02-470-KIT  
Neg Plate Subassembly, 2019,  
34 Rhythm SPD-PED-ELEC

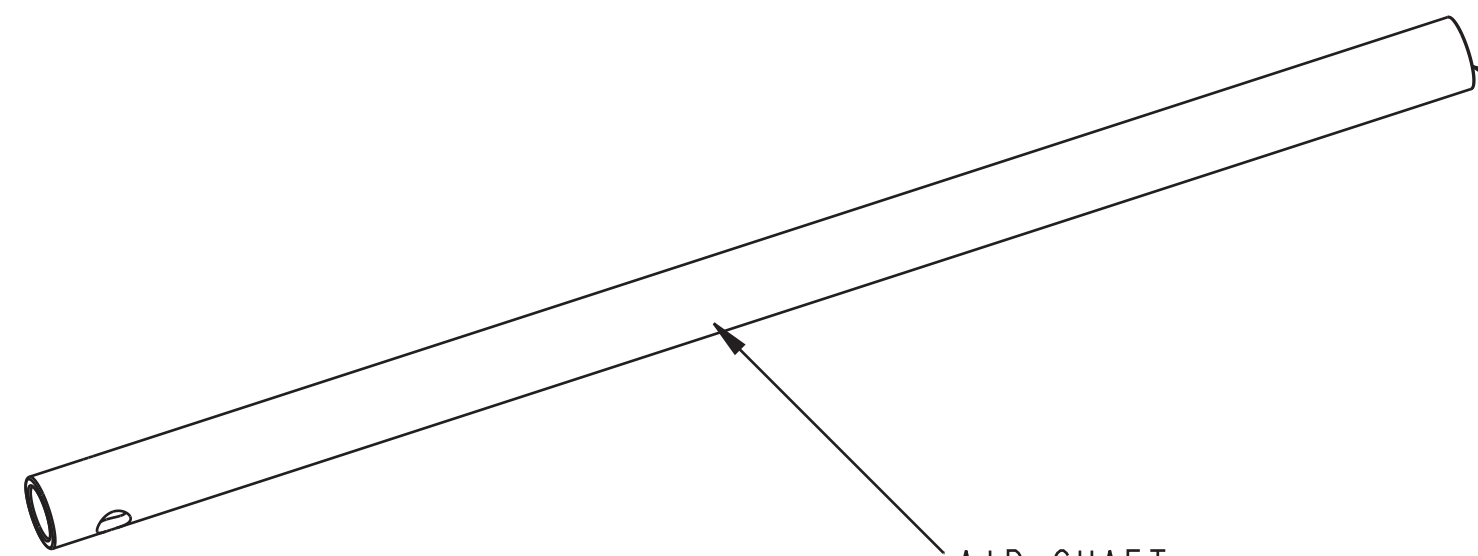

AIR SHAFT

IMPORTANT:  
PRESS PIN UNTIL CENTERED

Pin: Spring [Ø 0.188 X 0.875 TLG] Spring Steel, Zinc

IMPORTANT:  
VERIFY SEAL IS NOT  
TWISTED AFTER INSTALL

**FOX** FOX Factory, Inc. Ph 831-768-1100  
130 Hangar Way, Watsonville, CA 95076 USA Fax 831-768-9312

TITLE  
2022 34 RHYTHM E-BIKE+ FLOAT NA2  
AIR SHAFT ASSEMBLIES

SIZE DWG. NO.  
**C**  
PLOT SCALE 1:1:1 SHEET 1 OF 1

PROPRIETARY  
THIS DOCUMENT CONTAINS CONFIDENTIAL, PROPRIETARY INFORMATION  
THAT IS FOX PROPERTY. DO NOT DISCLOSE TO OR DUPLICATE  
FOR OTHERS EXCEPT AS AUTHORIZED BY FOX.

4

3

2

1

ProE ASSEM