

4

3

2

1

Fastener Standard (Metric): Screw, Socket Head, M2.5 X 8

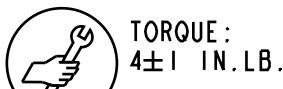

TORQUE:
4±1 IN.LB.

COMP SELECTOR KNOB

820-05-553-KIT
2019 Grip 34 & 36 Rhythm Topcap Interface Parts

Seals: O-Ring Custom: [1.066 C.S. X .742 ID] N-70, Static



GREASE:
THIN LAYER
OF SLICK HONEY

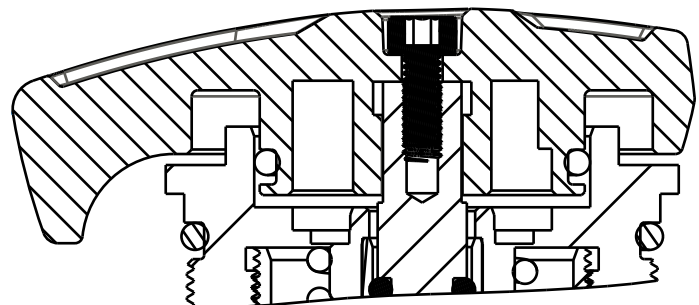
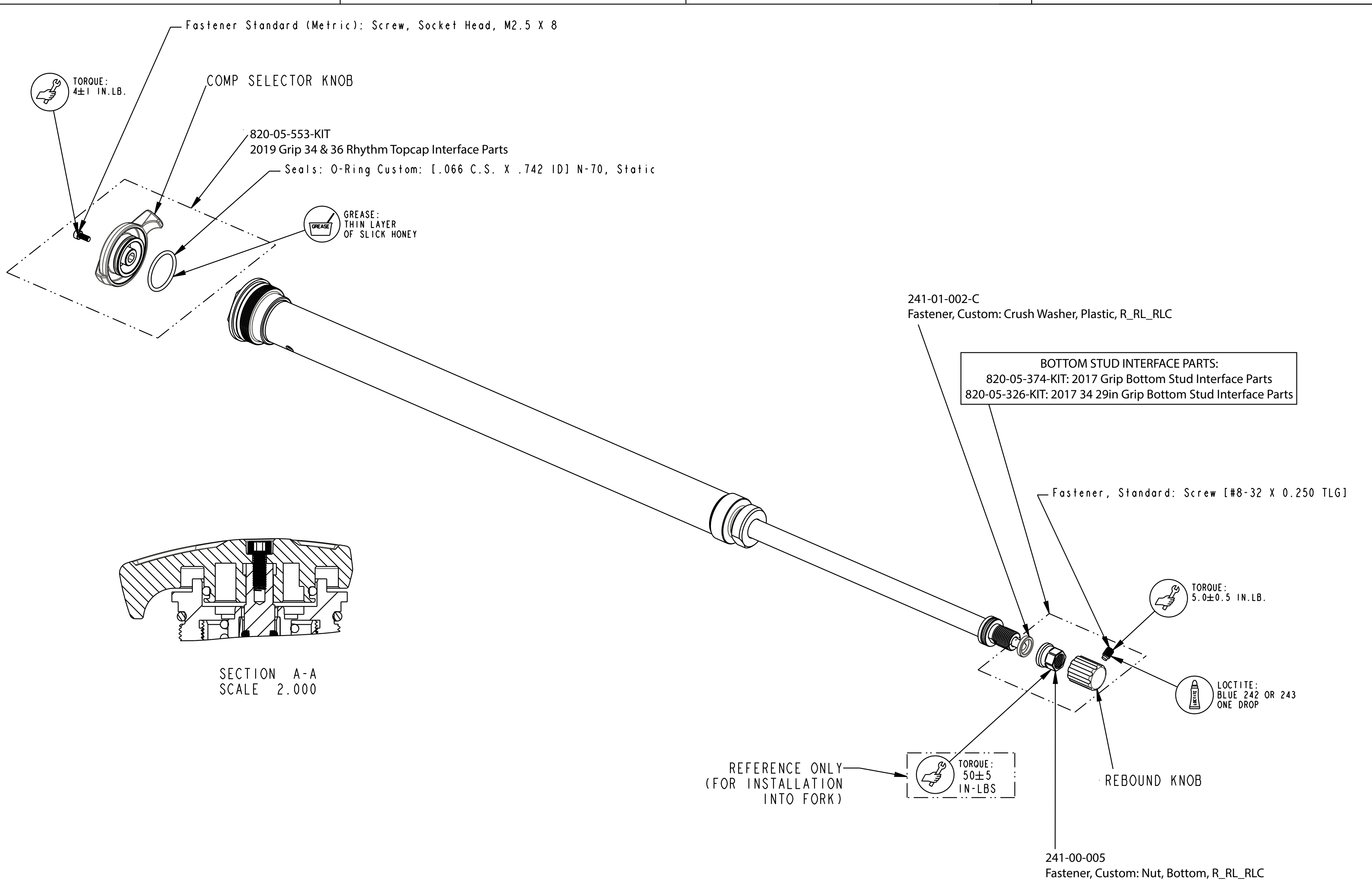

SECTION A-A
SCALE 2.000

241-01-002-C
Fastener, Custom: Crush Washer, Plastic, R_RL_RLC

BOTTOM STUD INTERFACE PARTS:
820-05-374-KIT: 2017 Grip Bottom Stud Interface Parts
820-05-326-KIT: 2017 34 29in Grip Bottom Stud Interface Parts

Fastener, Standard: Screw [#8-32 X 0.250 TLG]



TORQUE:
5.0±0.5 IN.LB.



LOCTITE:
BLUE 242 OR 243
ONE DROP

REBOUND KNOB

241-00-005
Fastener, Custom: Nut, Bottom, R_RL_RLC

REFERENCE ONLY
(FOR INSTALLATION
INTO FORK)



TORQUE:
50±5
IN-LBS

		FOX Factory, Inc.	Ph 831-768-1100
		130 Hangar Way, Watsonville, CA 95076 USA	Fax 831-768-9312
TITLE			
2022 34 RHYTHM GRIP			
CARTRIDGE ASSEMBLIES COMPLETE			
SIZE DWG. NO.			
C			
PLOT SCALE 0.75:1		SHEET 1 OF 2	

- PROPRIETARY -
THIS DOCUMENT CONTAINS CONFIDENTIAL, PROPRIETARY INFORMATION
THAT IS FOX PROPERTY. DO NOT DISCLOSE TO OR DUPLICATE
FOR OTHERS EXCEPT AS AUTHORIZED BY FOX.

4

3

2

1