

**ASSEMBLY INSTRUCTIONS:**

1. WITH THE DAMPER IN "DESCEND" POSITION INSTALL 210-22-759. POSITION HOUSING SO CABLE BOSS IS BETWEEN 1 AND 2 O'CLOCK FROM RIDER'S PERSPECTIVE.
2. INSTALL 036-01-044 ON 210-22-760. NOTE ORIENTATION OF U-CUP.
3. INSTALL 002-02-050 ON 210-22-760.
4. INSTALL 019-01-088 IN 210-22-760.
5. APPLY A LIBERAL AMOUNT OF GREASE TO 039-00-291. INSTALL SPRING TANG IN HOLE ON 210-22-760. INSTALL THIS ASSMBLY IN HOUSING SO SET SCREW IS POSITIONED AT CABLE BOSS OF HOUSING. ENSURE SPRING TANG SEATS IN A HOLE IN BOTTOM OF HOUSING. SECURE IN PLACE USING 019-01-095.
6. LIFT UP ON HOUSING AND ROTATE COUNTER CLOCKWISE UNTIL CABLE BOSS IS AT 7 O'CLOCK FROM RIDER'S PERSPECTIVE. LOWER HOUSING AND ENSURE IT IS PROPERLY SEATED ON TOP CAP.

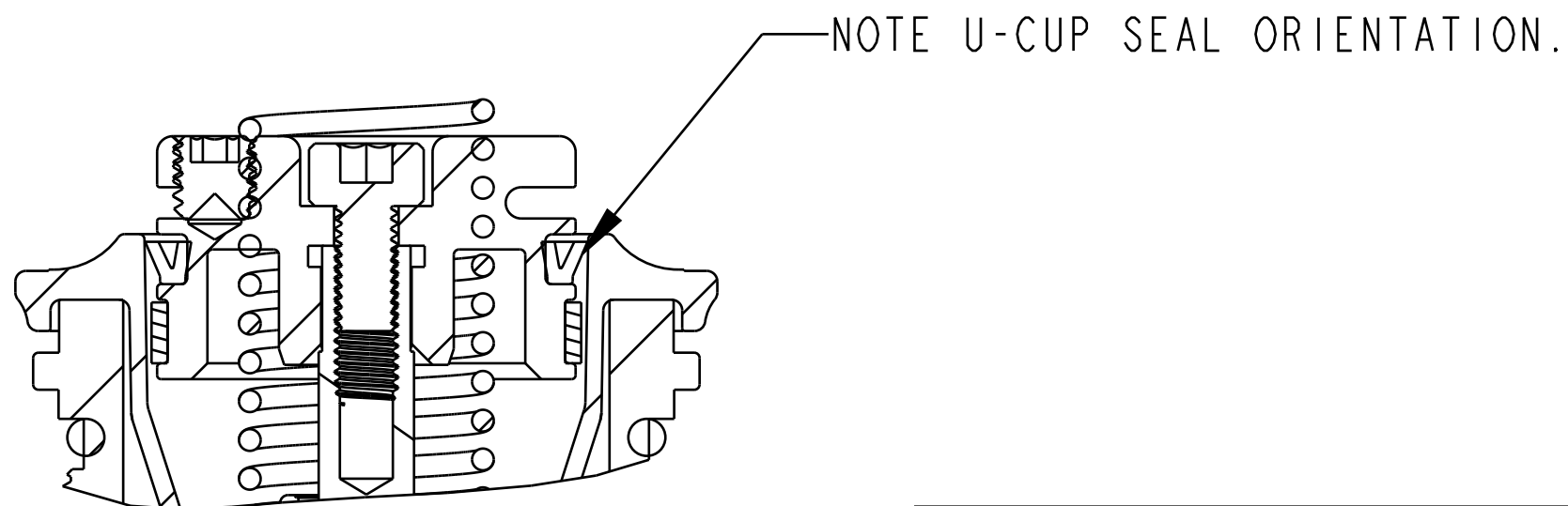

- PROPRIETARY -  
THIS DOCUMENT CONTAINS CONFIDENTIAL, PROPRIETARY INFORMATION  
THAT IS FOX PROPERTY. DO NOT DISCLOSE TO OR DUPLICATE  
FOR OTHERS EXCEPT AS AUTHORIZED BY FOX.

|  |  |                          |                 |
|--|--|--------------------------|-----------------|
| <b>FOX</b>   |  | <b>FOX Factory, Inc.</b> | Ph 831-768-1100 |
| 130 Hangar Way, Watsonville, CA 95076 USA                      |  | Fox 831-768-9312         |                 |
| <b>TITLE</b>   |  |                          |                 |
| <b>2014 32 O/C-CTD REMOTE<br/>CARTRIDGE ASSEMBLY COMPLETE.</b> |  |                          |                 |
| <b>SIZE DWG. NO.</b>   |  |                          |                 |
| <b>C</b>   |  |                          |                 |
| PLOT SCALE 0.80:1  |  | SHEET 1 OF 1             |                 |