

REFERENCE ONLY  
(FOR INSTALLATION  
INTO FORK)

TORQUE:  
50±5 IN. LB.

Rebound Knob:  
210-24-006 Knob, Rebound Adjust, Extruded, 32 29in 15x110QR  
210-22-523 Knob: Rebound Adj, Extruded

LOCTITE:  
BLUE 242  
ONE DROP

018-01-004-A  
Fastener, Standard: Screw [#8-32 X 0.250 TLG]

TORQUE:  
5.0±1.0 IN. LB.

241-00-005  
Fastener, Custom: Nut, Bottom, R, RL\_RLC

241-01-002-C  
Fastener, Custom: Crush Washer, Plastic, R, RL\_RLC

Base Stud Interface Parts:  
820-05-381-KIT 2016 FIT4 Bottom Stud Interface Parts 32 29in 15x110QR  
820-05-334-KIT 2016 FIT4 Bottom Stud Interface Parts 32

Topcap Interface Parts:  
820-05-455-KIT 2018 FIT4 TopCap Interface Parts F-S Remote, U-Cup, Push-Unlock  
820-05-456-KIT 2018 FIT4 TopCap Interface Parts F-S Remote, U-Cup, Push-Lock

CARTRIDGE ASSY

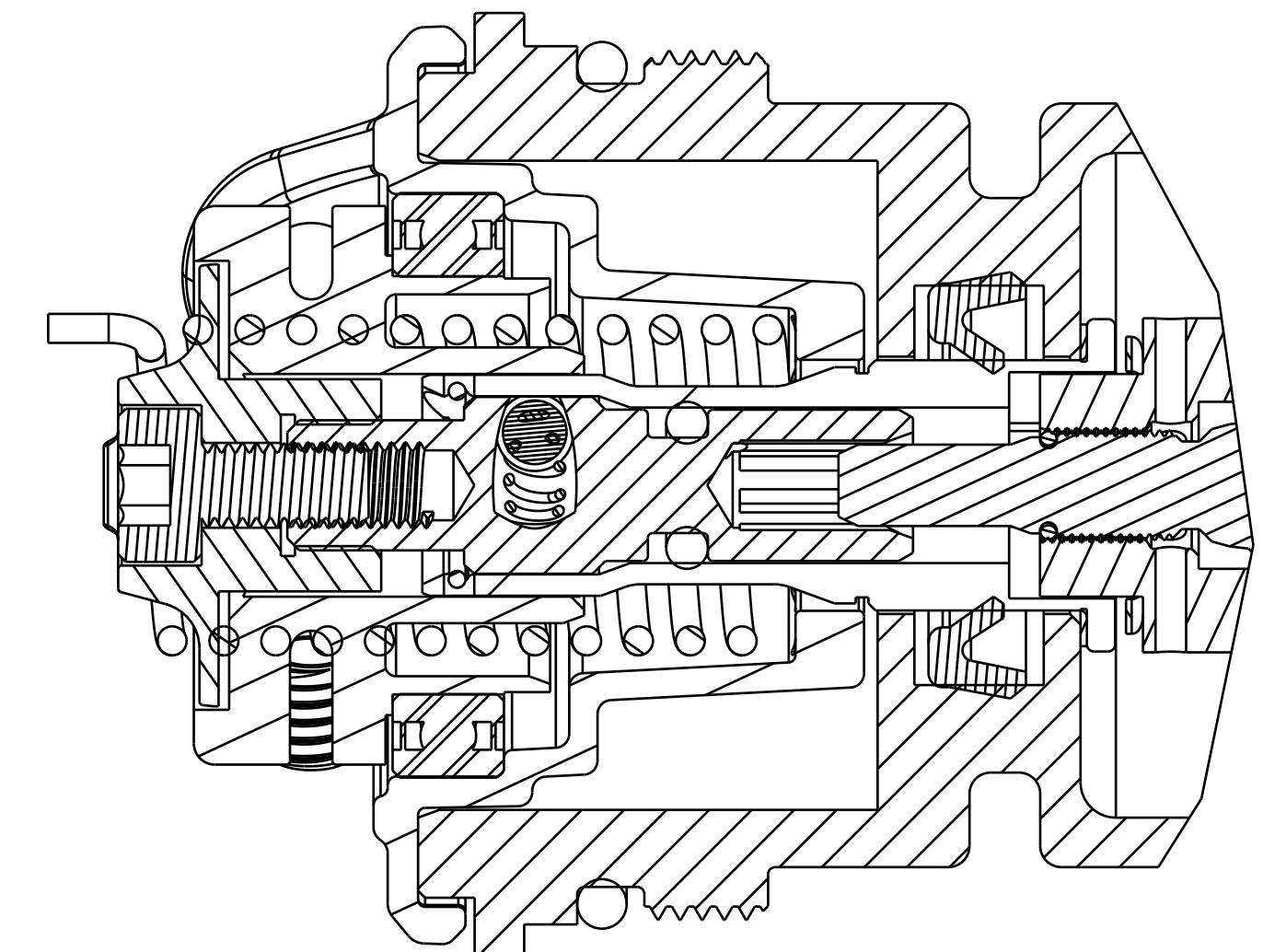

DETAIL A  
SCALE 4:1

REFERENCE ONLY  
(FOR INSTALLATION  
INTO FORK)

TORQUE:  
220±5 IN. LB.

SEE DETAIL A

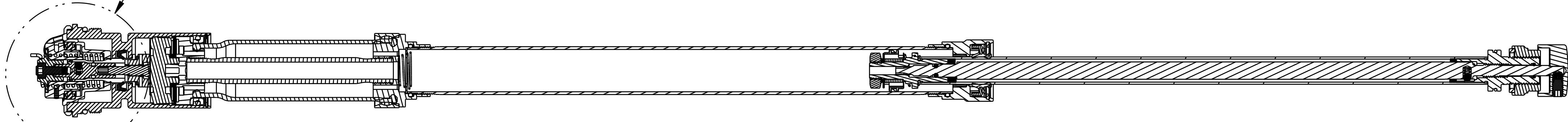

SECTION A-A

TORQUE:  
11±3 IN. LB.

IMPORTANT:  
DO NOT ALLOW PULLEY  
TO ROTATE WHILE TORQUING

PROPRIETARY  
THIS DOCUMENT CONTAINS CONFIDENTIAL, PROPRIETARY INFORMATION  
THAT IS FOR PROPERTY USE ONLY. DO NOT DISCLOSE TO OR DUPLICATE  
FOR OTHERS EXCEPT AS AUTHORIZED BY FOX.

**FOX** FOX Factory, Inc. Ph 831-768-1100  
130 Hangar Way, Watsonville, CA 95076 USA Fax 831-768-9312

TITLE  
2018 32mm 26in/27.5in/29in 110-150  
F-S FIT4 Remote Cartridge Complete

SIZE DWG. NO.  
D

PLOT SCALE 1.00:1 SHEET 1 OF 1