

210-24-034  
Compression Piston Clamp, FIT4, Lightweight

045-00-150  
Valve: Metric [15mm OD X 8mm ID X .15mm]

039-00-205  
Spring, Comp. Check

040-12-060  
Valve: [.600 OD X 0.377 ID X 0.012 TH]

038-00-142  
Retaining Ring: Snap, Smalley, Internal, VH-62 , Ø.610 Bore



IMPORTANT:  
THIN VALVE FACES  
COMPRESSION CLAMP

IMPORTANT:  
SMALL DIAMETER OF SPRING  
FACES COMPRESSION CLAMP

IMPORTANT:  
THICKER VALVE FACES  
RETAINING RING

207-11-130  
Pressure Tube, 15.5 Bore, FIT4 Lightweight, 100mm Max Travel

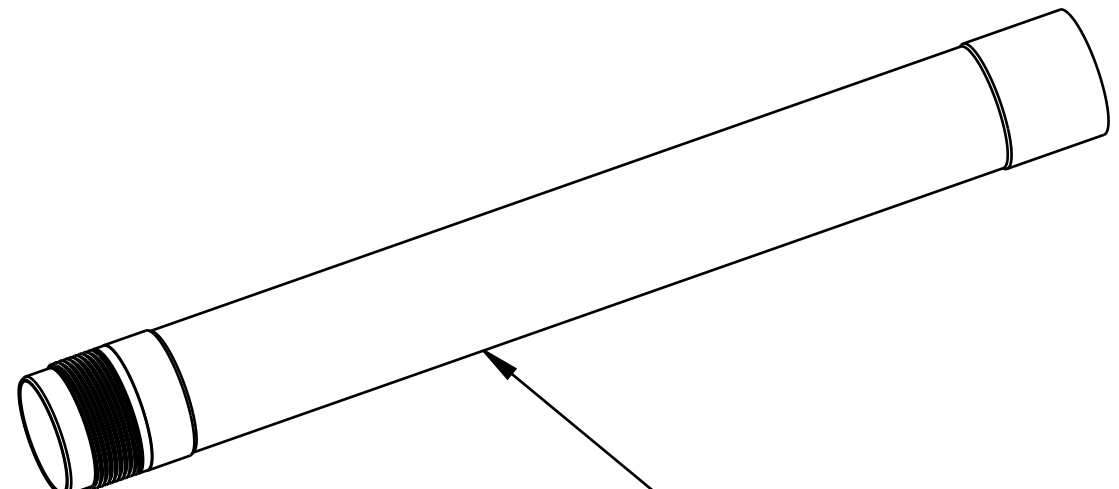

210-22-303  
Bladder, 010 RL\_RLC

GREASE:  
THIN LAYER OF SLICK HONEY  
ON ID AND OD OF BLADDER

IMPORTANT:  
ENSURE RETAINING RING  
FULLY SEATED FULL 360 DEG

210-22-420  
Lower Bladder Ring, Snap Ring, 011 RC2

241-01-029  
Bladder retainer, 011 RC2

038-00-065  
Retaining Ring: Snap, Smalley, Internal, Custom, Ø.923 BORE

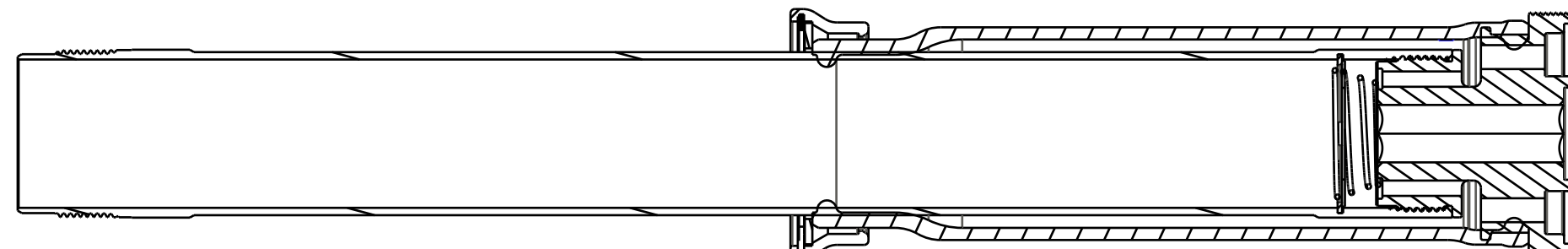

- PROPRIETARY -  
THIS DOCUMENT CONTAINS CONFIDENTIAL, PROPRIETARY INFORMATION  
THAT IS FOX PROPERTY. DO NOT DISCLOSE TO OR DUPLICATE  
FOR OTHERS EXCEPT AS AUTHORIZED BY FOX.

**FOX** **FOX Factory, Inc.** Ph 831-768-1100  
130 Hangar Way, Watsonville, CA 95076 USA Fax 831-768-9312

TITLE  
**2017 32mm 27.5in/29in 80-100 FIT4  
Lightweight Bladder Assembly**

SIZE DWG. NO. **820-03-281-KIT**

PLOT SCALE | .50:1 | SHEET | OF |