

4

3

2

1

019-01-115  
Fastener Standard (Metric): Screw, Socket Head, M2.5 X 8



210-03-179  
Damping Adj Part: Knob, Comp Selector, Grip, Forged

820-05-373-KIT  
2017 Grip Topcap Interface Parts

029-30-000  
Seals: O-Ring Custom: [1.066 C.S. X .742 ID] N-70, Static

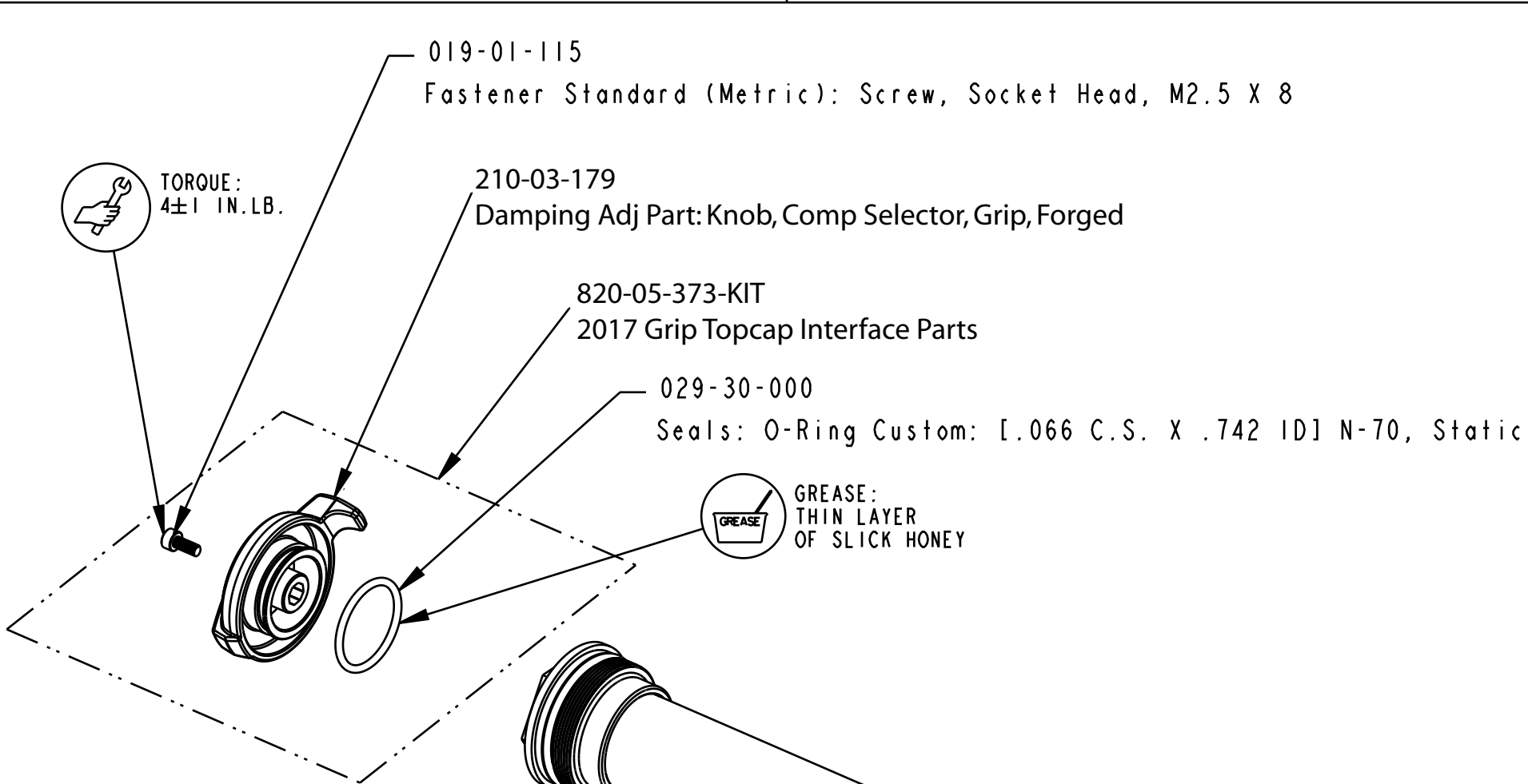

CARTRIDGE ASSY

241-01-002-C  
Fastener, Custom: Crush Washer, Plastic, R\_RL\_RLC

Bottom Stud Interface Parts:  
820-05-374-KIT: 2017 Grip Bottom Stud Interface Parts  
820-05-326-KIT: 2017 34 29in Grip Bottom Stud Interface Parts

018-01-004-A  
Fastener, Standard: Screw [#8-32 X 0.250 TLG]

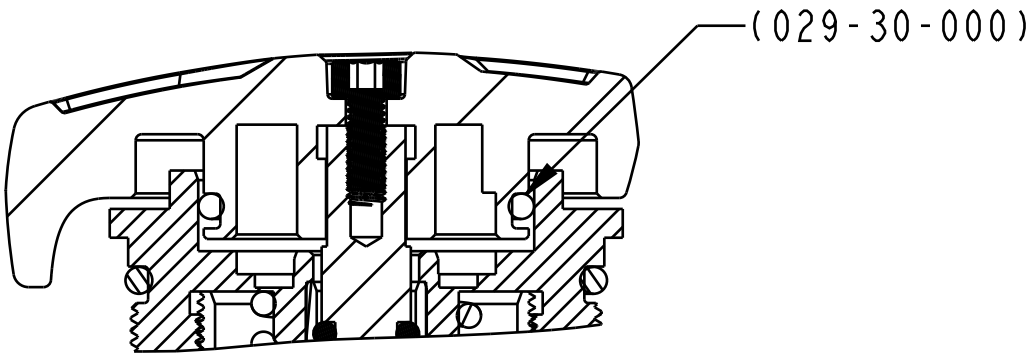

SECTION A-A  
SCALE 2.000

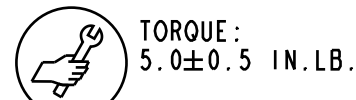

REFERENCE ONLY  
(FOR INSTALLATION  
INTO FORK)

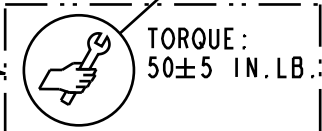

Rebound Knobs:  
210-22-726: Knob: Rebound Adjust, Extruded, Red, Grip  
210-24-032: Knob, Rebound Adjust, Grip Extruded, Red, 29

241-00-005  
Fastener, Custom: Nut, Bottom, R\_RL\_RLC

**FOX** FOX Factory, Inc. Ph 831-768-1100  
130 Hangar Way, Watsonville, CA 95076 USA Fax 831-768-9312

TITLE  
2018 34mm Rhythm 27.5in/29in 80-120  
& 130-150 GRIP Cartridges Complete

SIZE DWG. NO.  
C

PLOT SCALE 0.75:1

SHEET 1 OF 2

PROPRIETARY  
THIS DOCUMENT CONTAINS CONFIDENTIAL, PROPRIETARY INFORMATION  
THAT IS FOX PROPERTY. DO NOT DISCLOSE TO OR DUPLICATE  
FOR OTHERS EXCEPT AS AUTHORIZED BY FOX.

4

3

2

ProE ASSEM