

D

D

C

C

B

B

A

A

- ASSEMBLY INSTRUCTIONS:
1. ASSEMBLE DAMPER SHAFT ASSEMBLY TO PRESSURE TUBE.
 2. FILL CARTRIDGE WITH OIL.
 3. STROKE DAMPER SHAFT 5X, THEN TOP OUT.
 4. FILL OIL HEIGHT TO PRESSURE TUBE BLEED HOLE.
 5. TOPCAP ASSY (WITHOUT COMPRESSION NEEDLE)
 - A. SLOWLY PUSH INTO PRESSURE TUBE AND ENGAGE THREADS.
 - B. ROTATE TO ENGAGE 1-2 THREADS.
 6. DIP COMPRESSION NEEDLE AND O-RING IN OIL.
 7. THREAD COMPRESSION NEEDLE 3-4 TURNS.
 8. TORQUE TOPCAP ASSEMBLY.

Damper Shaft Assemblies:
 820-03-332-KIT: 2017 Rhythm 34 27.5 & 29 130-150, Grip Damper Shaft Assy
 820-03-499-KIT: 2017 Rhythm 34 27.5 80-120 Grip Damper Shaft Assy

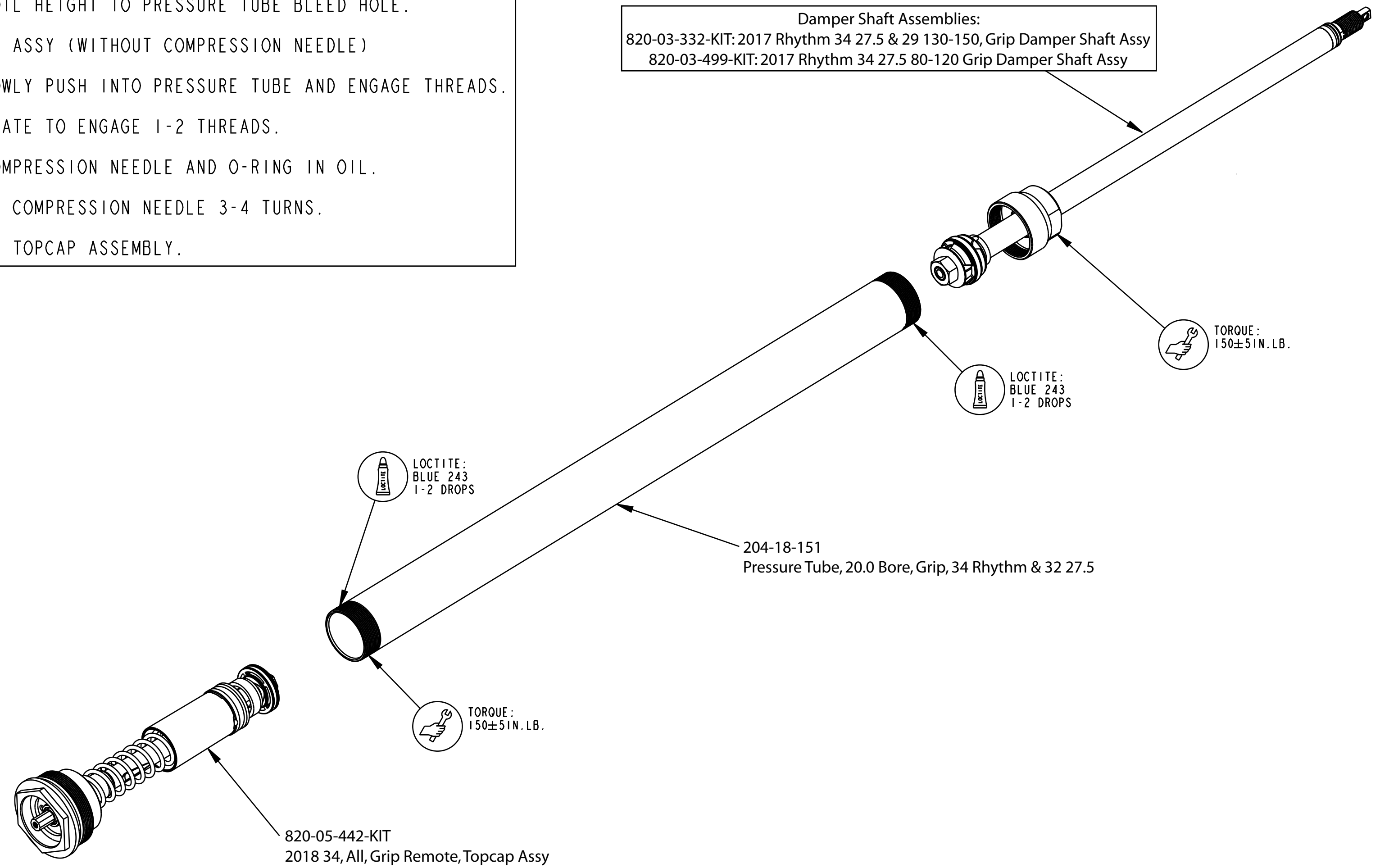

- PROPRIETARY -
 THIS DOCUMENT CONTAINS CONFIDENTIAL, PROPRIETARY INFORMATION
 THAT IS FOX PROPERTY. DO NOT DISCLOSE TO OR DUPLICATE
 FOR OTHERS EXCEPT AS AUTHORIZED BY FOX.

FOX FOX Factory, Inc. Ph 831-768-1100
 130 Hangar Way, Watsonville, CA 95076 USA Fax 831-768-9312

TITLE
2018 34mm Rhythm 27.5in/29in 80-120 & 130-150 GRIP Remote Cartridge Assemblies

SIZE DWG. NO.
C

PLOT SCALE 0.75:1 SHEET 1 OF 1