

D

D

C

C

B

B

A

A

- ASSEMBLY INSTRUCTIONS:
1. ASSEMBLE DAMPER SHAFT ASSEMBLY TO PRESSURE TUBE.
 2. FILL CARTRIDGE WITH OIL.
 3. STROKE DAMPER SHAFT 5X, THEN TOP OUT.
 4. FILL OIL HEIGHT TO PRESSURE TUBE BLEED HOLE.
 5. TOPCAP ASSY (WITHOUT COMPRESSION NEEDLE)
 - A. SLOWLY PUSH INTO PRESSURE TUBE AND ENGAGE THREADS.
 - B. ROTATE TO ENGAGE 1-2 THREADS.
 6. DIP COMPRESSION NEEDLE AND O-RING IN OIL.
 7. THREAD COMPRESSION NEEDLE 3-4 TURNS.
 8. TORQUE TOPCAP ASSEMBLY.

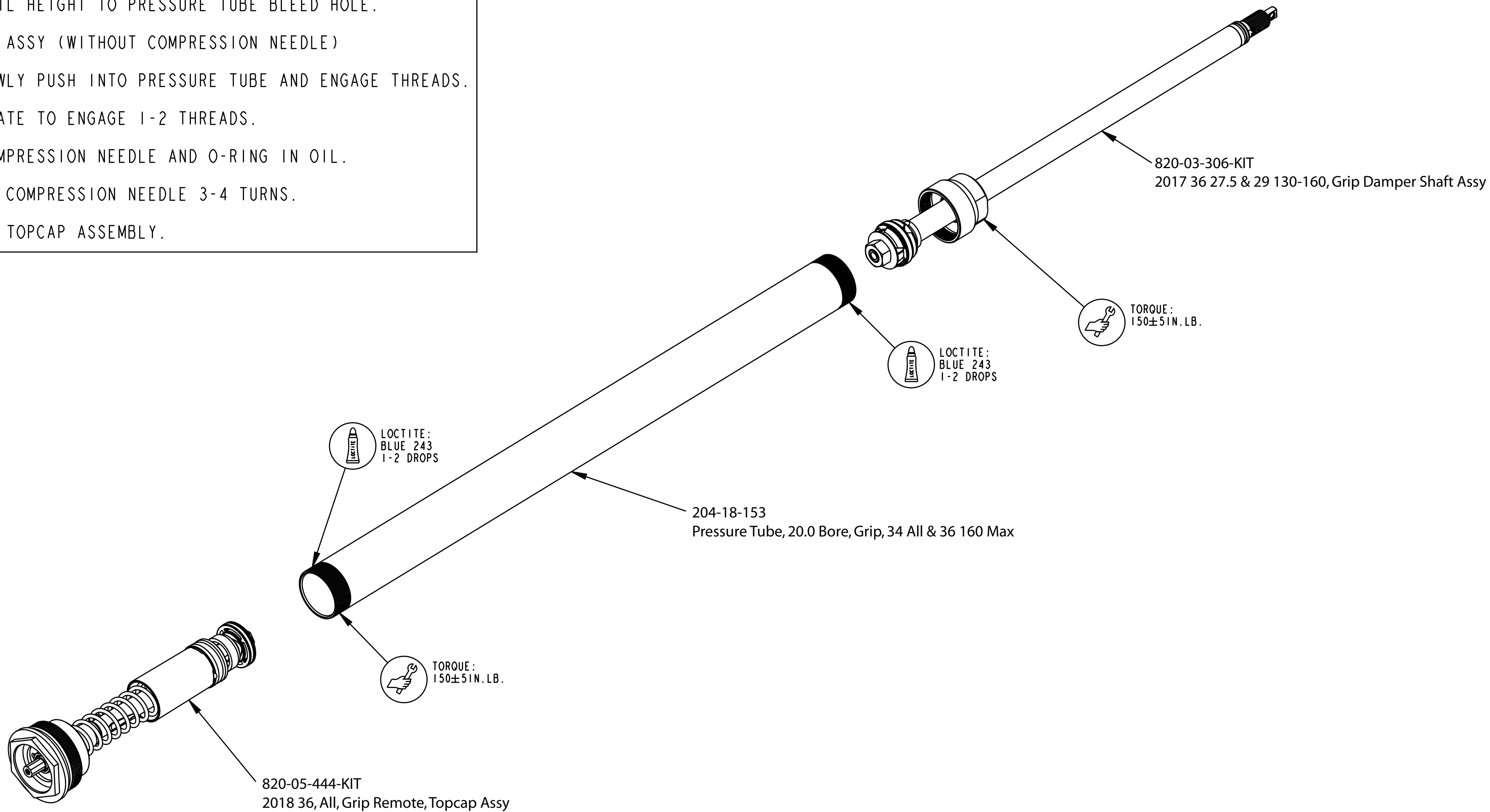

- PROPRIETARY -
THIS DOCUMENT CONTAINS CONFIDENTIAL, PROPRIETARY INFORMATION
THAT IS FOX PROPERTY. DO NOT DISCLOSE TO OR DUPLICATE
FOR OTHERS EXCEPT AS AUTHORIZED BY FOX.

FOX **FOX Factory, Inc.** Ph 831-768-1100
130 Hangar Way, Watsonville, CA 95076 USA Fax 831-768-9312

TITLE **2018 36 27.5 & 29 130-160,
Grip Remote Cart Assy**

SIZE DWG. NO. **C**

PLOT SCALE 0.75:1 | SHEET 1 OF 1