

REFERENCE ONLY
(FOR INSTALLATION
INTO FORK)

TORQUE:
150±5 IN-LB

210-03-120
Knob, Rebound, 2011 36_40

TORQUE:
5.0±1.0 IN-LB

LOCTITE:
BLUE 242
ONE DROP

018-01-004-A
Fastener, Standard: Screw [#8-32 X 0.250 TLG]

241-00-022
Fastener, Custom: Nut, Bottom, 011

820-05-377-KIT
2016 FIT4 Bottom Stud Interface Parts 36 and 40

241-01-011
Fastener, Custom: Crush Washer, Plastic, 13mm

REFERENCE ONLY
(FOR INSTALLATION
INTO FORK)

TORQUE:
220±5 IN-LB

CARTRIDGE ASSY

036-01-043
Seals: U-Cup, Shore 70A, 2013 Fit-CTD and CTD-ADJ

210-22-923
Compression Adjust Knob, F-S, FIT4

TORQUE:
11±3 IN-LB

SEE DETAIL A FOR PARTS

GREASE:
THIN LAYER
BLUE MARINE

210-22-922
Lockout Knob, F-S, FIT4

019-01-095
Fastener, Standard (Metric): Screw [M3 X 6mm] SHCS, Patchlock

DO NOT TIGHTEN FASTENER AGAINST COMPRESSION ADJUSTER HARD STOP,
USE TOOL TO PREVENT KNOB FROM TURNING

820-05-330-KIT
2016 FIT4 TopCap Interface Parts F-S

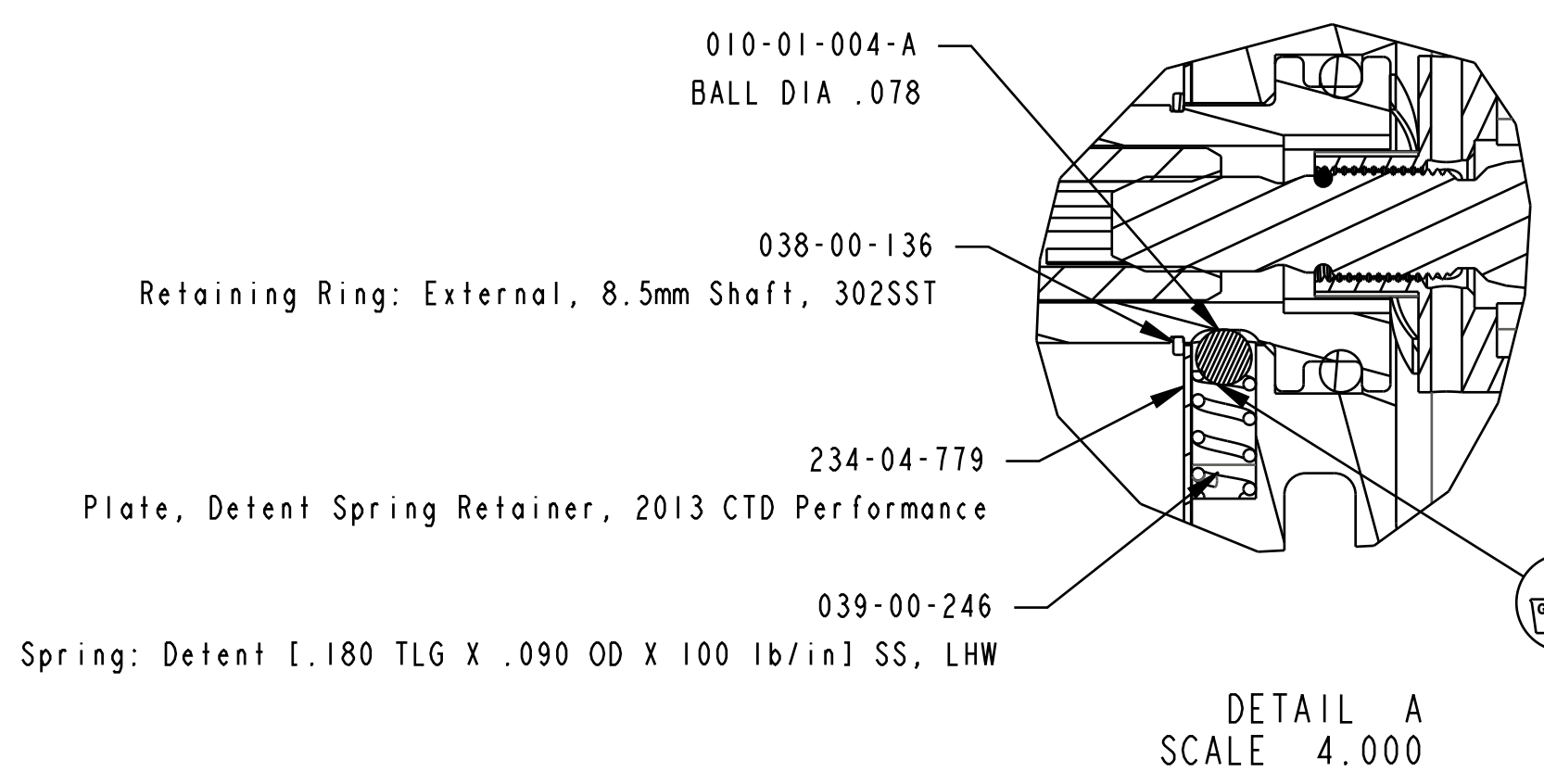

SEE DETAIL A

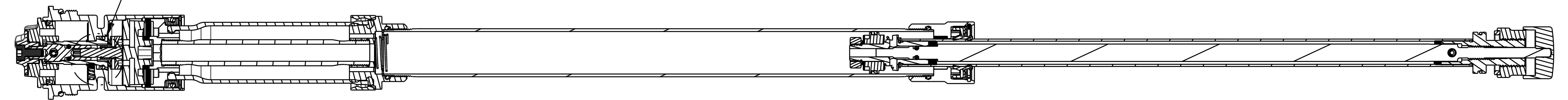

PROPRIETARY
THIS DOCUMENT CONTAINS CONFIDENTIAL, PROPRIETARY INFORMATION
THAT IS FOR PROPERTY. DO NOT DISCLOSE TO OR DUPLICATE
FOR OTHERS EXCEPT AS AUTHORIZED BY FOX.

FOX Factory, Inc.
130 Hangar Way, Watsonville, CA 95076 USA
Ph 831-768-1100
Fax 831-768-9312

TITLE
**2018 36mm 27.5in/29in 140-180 F-S FIT4
Cartridge Assembly Complete, E18**

SIZE DWG. NO.
820-08-740-KIT

PLOT SCALE 1.00:1 SHEET 1 OF 1