

REFERENCE ONLY
(FOR INSTALLATION
INTO FORK)

TORQUE:
150±5 IN-LB

TORQUE:
5.0±1.0 IN-LB

LOCTITE:
BLUE 242
ONE DROP

018-01-004-A
Fastener, Standard: Screw [#8-32 X 0.250 TLG]

210-03-120
Knob, Rebound, 2011 36_40

820-05-377-KIT
2016 FIT4 Bottom Stud Interface Parts 36 and 40

241-00-022
Fastener, Custom: Nut, Bottom, 011

241-01-011
Fastener, Custom: Crush Washer, Plastic, 13mm

REFERENCE ONLY
(FOR INSTALLATION
INTO FORK)

TORQUE:
220±5 IN-LB

CARTRIDGE ASSY

010-01-004-A
BALL DIA .078

038-00-136
Retaining Ring: External, 8.5mm Shaft, 302SST

234-04-779
Plate, Detent Spring Retainer, 2013 CTD Performance

039-00-246
Spring: Detent [.180 TLG X .090 OD X 100 lb/in] SS, LHW

GREASE:
THIN LAYER OF
BLUE MARINE ON BALL

DETAIL A
SCALE 4.000

TORQUE:
11±3 IN-LB

SEE DETAIL A FOR PARTS

210-22-915
KNOB, COMPRESSION SELECTOR, P-S, FIT4

019-02-024
Fastener Standard (Metric): Socket Head Cap [M6 X 1.0 X 6MM] SST, Patchlock

DO NOT TIGHTEN FASTENER AGAINST COMPRESSION SELECTOR HARD STOP,
USE TOOL TO PREVENT KNOB FROM TURNING

820-05-331-KIT
2016 FIT4 TopCap Interface Parts P-S

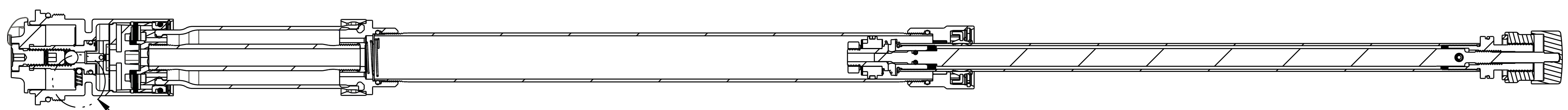

SEE DETAIL A

FOX Factory, Inc.
130 Hangar Way, Watsonville, CA 95076 USA
Ph 831-768-1100 Fax 831-768-9312

TITLE
2018 36mm 26in/27.5in/29in 160-180
P-S FIT4 Cartridge Assembly Complete

SIZE DWG. NO.
D 820-08-792-KIT

PLOT SCALE 1.00:1 SHEET 1 OF 1

PROPRIETARY
THIS DOCUMENT CONTAINS CONFIDENTIAL, PROPRIETARY INFORMATION
THAT IS FOR PROPERTY. DO NOT DISCLOSE TO OR DUPLICATE
FOR OTHERS EXCEPT AS AUTHORIZED BY FOX.