

029-08-059
Seals: O-Ring [16.5mm ID X 1.5mm CS] Metric, N-70, Static

039-00-205
Spring, Comp. Check

044-06-060
Valve: [.600 X .252 X .006]

040-20-066
Valve: [0.660 OD X 0.377 ID X 0.020 TH]

GREASE:
THIN LAYER
OF SLICK HONEY

IMPORTANT:
NOTE ORIENTATION
OF SPRING

210-22-877
Reflow Cap, FIT 4

OIL:
THIN LAYER OF FOX R3 DAMPER OIL
P/N 025-06-002 ON OD AND ID

210-22-887
Bladder Seal Ring Lower, FIT4

TORQUE:
55±5 IN.LB.

038-00-063
RING: INTERNAL SMALLLEY (VH-100-S02)

GREASE:
THIN LAYER
OF SLICK HONEY

210-22-997
Compression Piston Clamp, FIT4

GREASE:
THIN LAYER
OF SLICK HONEY

210-22-996
Shaft: Coupler, 0.375" OD X 0.254" ID, 7075-T6, FIT4

029-03-020
O-Ring (-020) [.070 C.S. X .864 ID]

210-22-886
Bladder Seal Ring Upper, FIT4

TORQUE:
75±5 IN.LB.
COMPRESSION CLAMP INTO TOPCAP ONLY

820-03-461-KIT
2016 FIT4 P-S Compression Valving Assy

820-03-541-KIT
2018 FIT4 P-S Top Cap Parts, Remote, U-Cup, Push-Unlock

036-01-093
Seals: U-cup, Low Friction, 9mm Shaft

029-03-022-A
Seals: O-Ring [(-022) .070 C.S. X 0.989 ID] Standard, N-70, Static

Body, Topcap, 32, Fit4 Remote, U-Cup

TORQUE:
55±5 IN.LB.

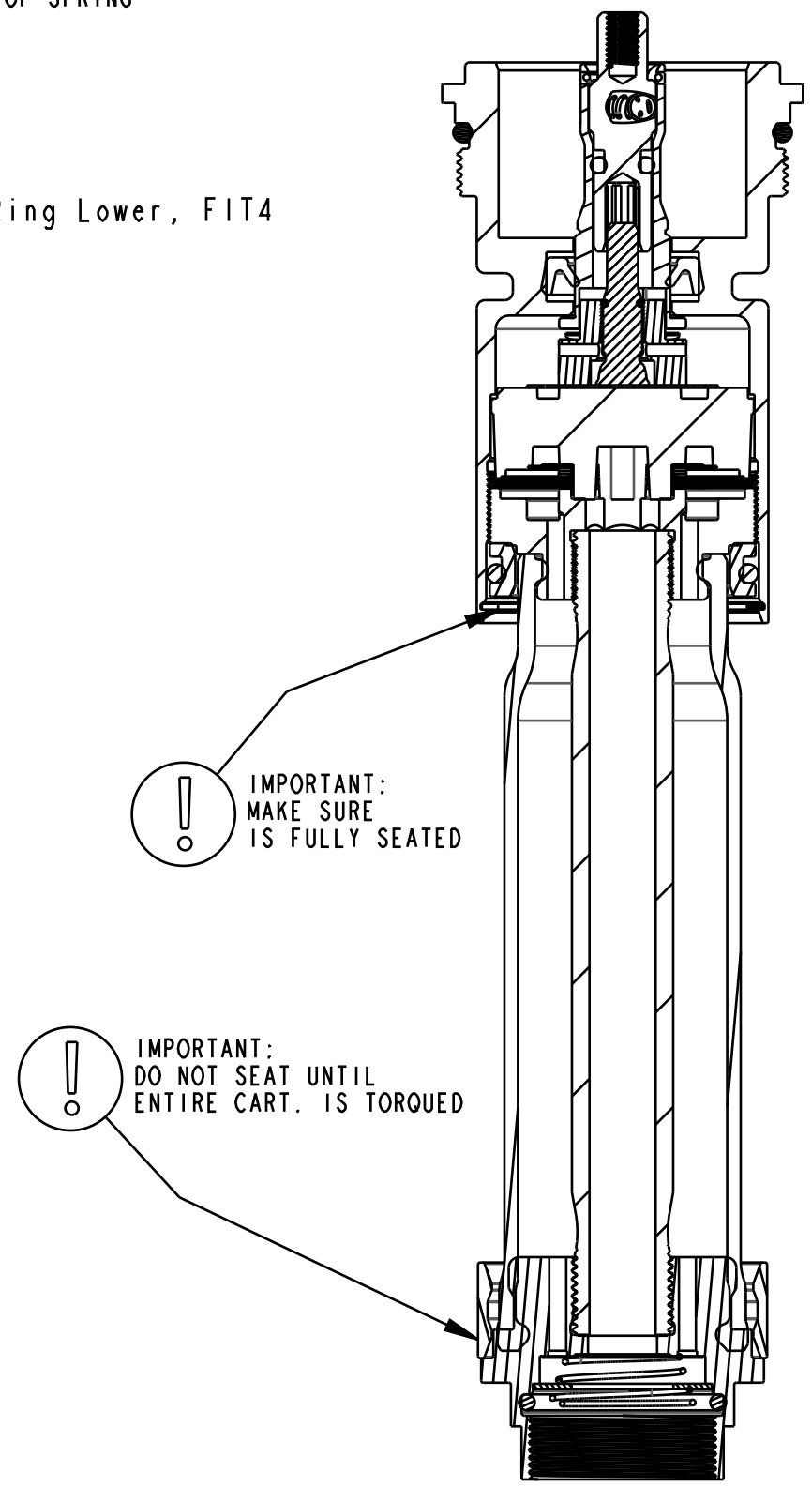

IMPORTANT:
MAKE SURE
IS FULLY SEATED

IMPORTANT:
DO NOT SEAT UNTIL
ENTIRE CART. IS TORQUED

SECTION A-A
SCALE 1.500

PROPRIETARY
THIS DOCUMENT CONTAINS CONFIDENTIAL, PROPRIETARY INFORMATION
THAT IS FOX PROPERTY. DO NOT DISCLOSE TO OR DUPLICATE
FOR OTHERS EXCEPT AS AUTHORIZED BY FOX.

FOX Factory, Inc. Ph 831-768-1100
130 Hangar Way, Watsonville, CA 95076 USA Fax 831-768-9312

TITLE
**2018 32 FIT4 P-S Topcap Assy, Long Travel,
Remote, U-Cup, 2 Position, Push-Unlock**

SIZE DWG. NO.
C 820-05-482-KIT

PLOT SCALE | .00 : 1 | SHEET | OF | 1