

4

3

2

1

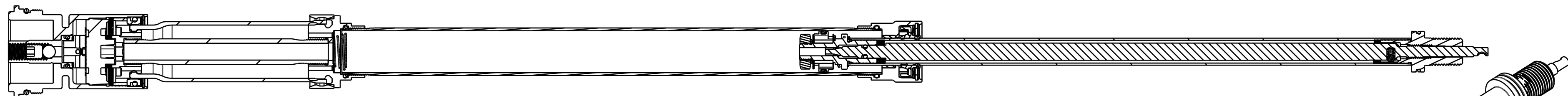

DAMPER SHAFT ASSEMBLIES:
 820-03-469-KIT: 2016 34 26in and 27.5in and 29in FIT4 Damper Shaft Assy
 820-03-334-KIT: 2016 34 26in and 27.5in and 29in FIT4 Damper Shaft Assy, 120 Max Travel

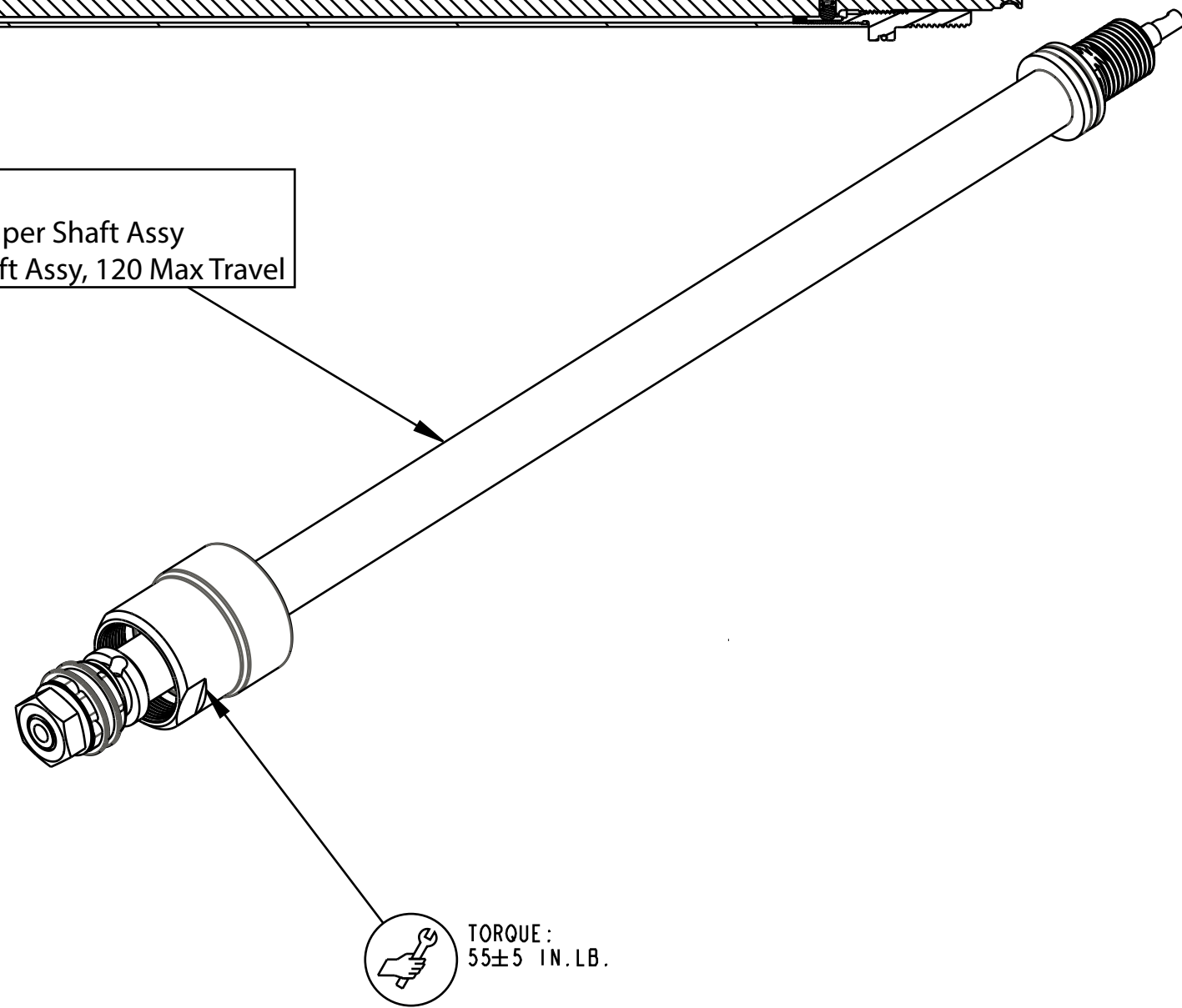

TORQUE:
55±5 IN. LB.

820-05-483-KIT
 2018 34 FIT4 P-S Topcap Assy, Remote, U-Cup, 2 Position, Push-Unlock

TORQUE:
55±5 IN. LB.

207-11-106
 (T) Pressure Tube, 15.5 Bore, 160 Max Travel, FIT4

TORQUE:
11±2 IN. LB.

- 010-01-001
Air Valve Parts: Ball [Ø 0.1875] E52100 Grade 25 Steel, Chrome
- 019-01-107
Fastener Standard (Metric): Socket Set Screw [M6 X 1.0 x 6.0MM] Flat PT, SST

ASSEMBLE THESE PARTS AFTER OIL FILL
 COMPRESS DAMPER SHAFT 3IN BEFORE SEALING DAMPER

PROPRIETARY
 THIS DOCUMENT CONTAINS CONFIDENTIAL, PROPRIETARY INFORMATION
 THAT IS FOX PROPERTY. DO NOT DISCLOSE TO OR DUPLICATE
 FOR OTHERS EXCEPT AS AUTHORIZED BY FOX.

FOX Factory, Inc. Ph 831-768-1100
 130 Hangar Way, Watsonville, CA 95076 USA Fax 831-768-9312

TITLE
2019 34 P-S FIT4
 Remote Cartridge Assemblies

SIZE DWG. NO.
C
 PLOT SCALE | .00:1 | SHEET | OF |

4

3

2

1

ProE ASSEM