

4

3

2

1

D

D

C

C

B

B

A

A

DAMPER SHAFT ASSEMBLIES:
 820-03-470-KIT: 2016 36 26in and 27.5in and 29in FIT4 Damper Shaft Assy
 820-03-598-KIT: 2019 36 FIT4 Damper Shaft Assy, E-Bike Tune

TOPCAP ASSEMBLIES:
 820-05-499-KIT: 2018 36 FIT4 F-S Topcap Assy, E18, Black Ano
 820-05-543-KIT: 2019 36 FIT4 F-S Topcap Assy, E-Bike Tune

038-01-073
 Retaining Ring: Wire [.280 X .024 CS] SS

210-22-920
 Compression Adjust Coupler, F-S, FIT4

029-08-068
 Seals: O-Ring [3.0MM ID x 1.5MM CS] Metric, N-70, Static

207-11-118
 (T) Pressure Tube, 15.5 Bore, Bladder Seal,
 180 Max Travel, FIT4

TORQUE:
 55±5 IN. LB.

038-00-065
 Retaining Ring: Snap, Smalley, Internal, Custom, Ø.923 BORE

241-01-029
 Bladder retainer, 011 RC2

210-22-420
 Lower Bladder Ring, Snap Ring, 011 RC2

210-22-391
 Bladder, 2011 36_40

210-22-925
 Bladder Seal Ring, Upper, 36, FIT4

OIL:
 THIN LAYER OF FOX R3 DAMPER OIL

TORQUE:
 55±5 IN. LB.

039-00-243
 Spring: Detent [.138 TLG, .087 OD, 48 lb/in]

010-01-012
 Air Valve Parts: Ball [Ø 0.1094] E52100 Grade 25 Steel, Chrome

GREASE:
 THIN LAYER
 OF SLICK HONEY ON BALL

ASSEMBLE THESE PARTS AFTER OIL FILL

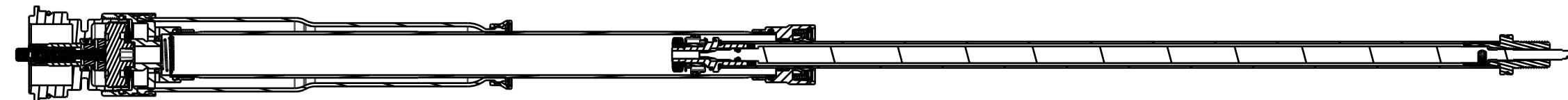

- PROPRIETARY -
 THIS DOCUMENT CONTAINS CONFIDENTIAL, PROPRIETARY INFORMATION
 THAT IS FOX PROPERTY. DO NOT DISCLOSE TO OR DUPLICATE
 FOR OTHERS EXCEPT AS AUTHORIZED BY FOX.

FOX **FOX Factory, Inc.** Ph 831-768-1100
 130 Hangar Way, Watsonville, CA 95076 USA Fax 831-768-9312

TITLE
2019 36 F-S FIT4
Cartridge Assemblies

SIZE DWG. NO.

C

PLOT SCALE 0.50:1

SHEET 1 OF 1

4

3

2

1

ProE ASSEM