

4

3

2

1

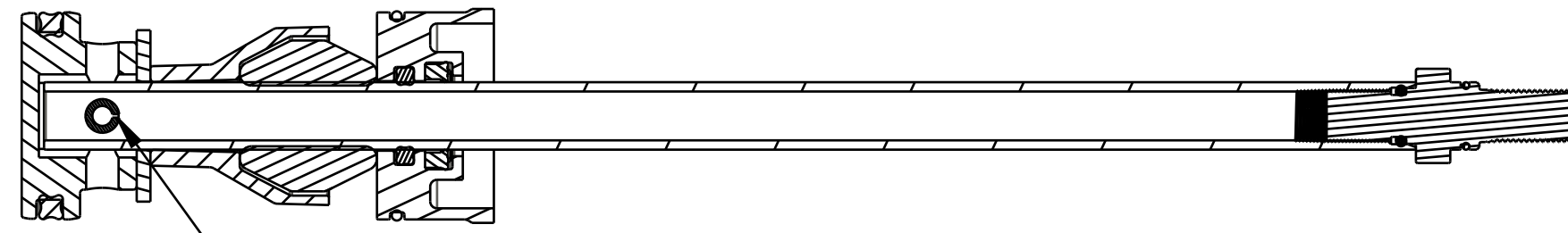

! IMPORTANT:
ORIENT GAP IN PIN TOWARDS
TOPOUT SPACER ±15°

Seals: O-Ring [8.0MM ID x 1.0MM CS] Metric, N-70, Static

234-04-655
Base Stud: Float, 0.305-48 Thread

Seals: O-Ring [6.0mm ID x 1.5mm CS] Metric, N-70, Static

234-04-629
Topout Bumper, FLOAT NA

029-08-060

TORQUE:
50±5 IN LB

GREASE:
THIN LAYER
OF SLICK HONEY

035-00-214
Seals: Q-Ring [(-214) .139 C.S. X 0.984 ID]

222-01-334
Piston, FLOAT NA 2 LC, 36, 1.287 Bore

LOCTITE:
1-2 DROPS
RED 262

820-02-448-KIT
Neg Plate Subassembly, 2018 FLOAT NA 2, 36,
All Travel, 1.287" Bore, Aluminum

234-44-117
Topout Spacer, Aluminum, FLOAT NA2 LC, 36

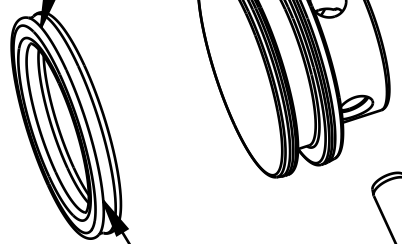

! IMPORTANT:
PRESS PIN UNTIL CENTERED

AIR SHAFT

060-01-010
Pin: Spring [Ø 0.188 X 0.875 TLG] Spring Steel, Zinc

! IMPORTANT:
VERIFY SEAL IS NOT
TWISTED AFTER INSTALL

		FOX Factory, Inc. 130 Hangar Way, Watsonville, CA 95076 USA Ph 831-768-1100 Fax 831-768-9312
TITLE 2019 36 FLOAT NA2 Air Shaft Assemblies		
SIZE C	DWG. NO.	SHEET 1 OF 1
PLOT SCALE 1:1:1		PROJ ASSEM

PROPRIETARY -
THIS DOCUMENT CONTAINS CONFIDENTIAL, PROPRIETARY INFORMATION
THAT IS FOX PROPERTY. DO NOT DISCLOSE TO OR DUPLICATE
FOR OTHERS EXCEPT AS AUTHORIZED BY FOX.

4

3

2

PROJ ASSEM