

- ASSEMBLY INSTRUCTIONS:
1. ASSEMBLE DAMPER SHAFT ASSEMBLY TO PRESSURE TUBE
 2. FILL CARTRIDGE 1/2 FULL WITH OIL
 3. STROKE DAMPER SHAFT 5X, THEN TOP OUT DAMPER SHAFT
 4. FILL OIL HEIGHT TO PRESSURE TUBE BLEED HOLE
 5. TOPCAP ASSY
 - A. SLOWLY PUSH INTO PRESSURE TUBE AND ENGAGE TOPCAP THREADS
 - B. ROTATE TO ENGAGE 1-2 THREADS
 6. TORQUE TOPCAP AND SEALHEAD ASSEMBLIES
 7. STROKE DAMPER SHAFT APPROXIMATELY 75% OF MAX DAMPER TRAVEL TO EXPELL EXCESS OIL

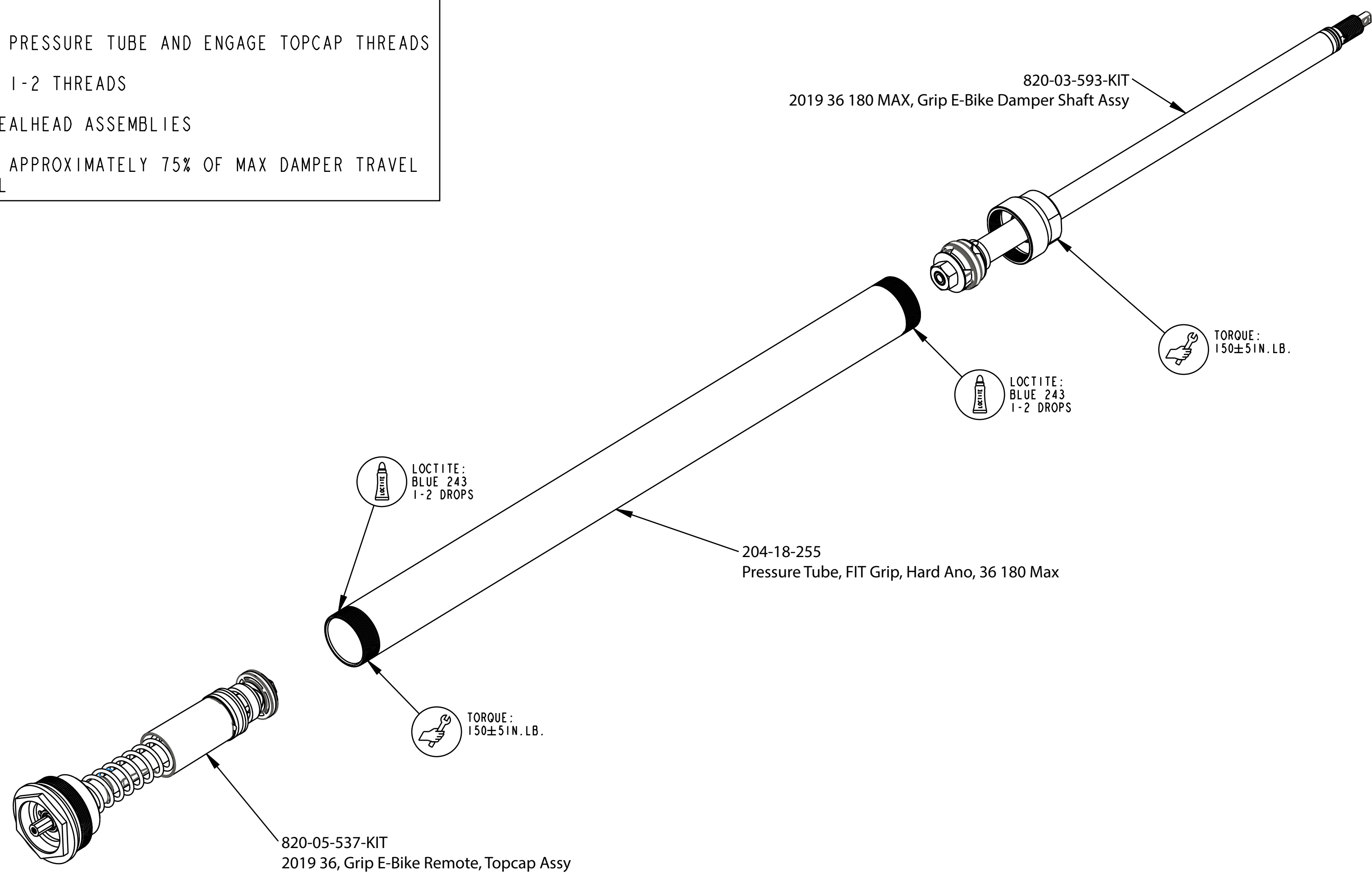

FOX FOX Factory, Inc. Ph 831-768-1100
 130 Hangar Way, Watsonville, CA 95076 USA Fax 831-768-9312

TITLE **2019 36 Rhythm, 180 MAX,
Grip E-Bike Remote Cart Assy**

SIZE DWG. NO. **C**

PLOT SCALE 0.75:1 SHEET 1 OF 1

- PROPRIETARY -
 THIS DOCUMENT CONTAINS CONFIDENTIAL, PROPRIETARY INFORMATION
 THAT IS FOX PROPERTY. DO NOT DISCLOSE TO OR DUPLICATE
 FOR OTHERS EXCEPT AS AUTHORIZED BY FOX.