

REFERENCE ONLY  
(FOR INSTALLATION  
INTO FORK)

TORQUE:  
80±5  
IN-LBS

210-03-120  
Knob, Rebound, 2011 36\_40

TORQUE:  
5.0±1.0 IN-LB

LOCTITE:  
BLUE 242  
ONE DROP

018-01-004-A  
Fastener, Standard: Screw [#8-32 X 0.250 TLG]

241-00-022  
Fastener, Custom: Nut, Bottom, 011

820-05-377-KIT  
2016 FIT4 Bottom Stud Interface Parts 36 and 40

241-01-011  
Fastener, Custom: Crush Washer, Plastic, 13mm

REFERENCE ONLY  
(FOR INSTALLATION  
INTO FORK)

TORQUE:  
220±51N-LB

CARTRIDGE ASSY

036-01-043  
Seals: U-Cup, Shore 70A, 2013 Fit-CTD and CTD-ADJ

210-22-923  
Compression Adjust Knob, F-S, FIT4

TORQUE:  
11±3 IN-LB

SEE DETAIL A FOR PARTS

GREASE:  
THIN LAYER  
BLUE MARINE

210-22-922  
Lockout Knob, F-S, FIT4

019-01-095  
Fastener, Standard (Metric): Screw [M3 X 6mm] SHCS, Patchlock

820-05-330-KIT  
2016 FIT4 TopCap Interface Parts F-5

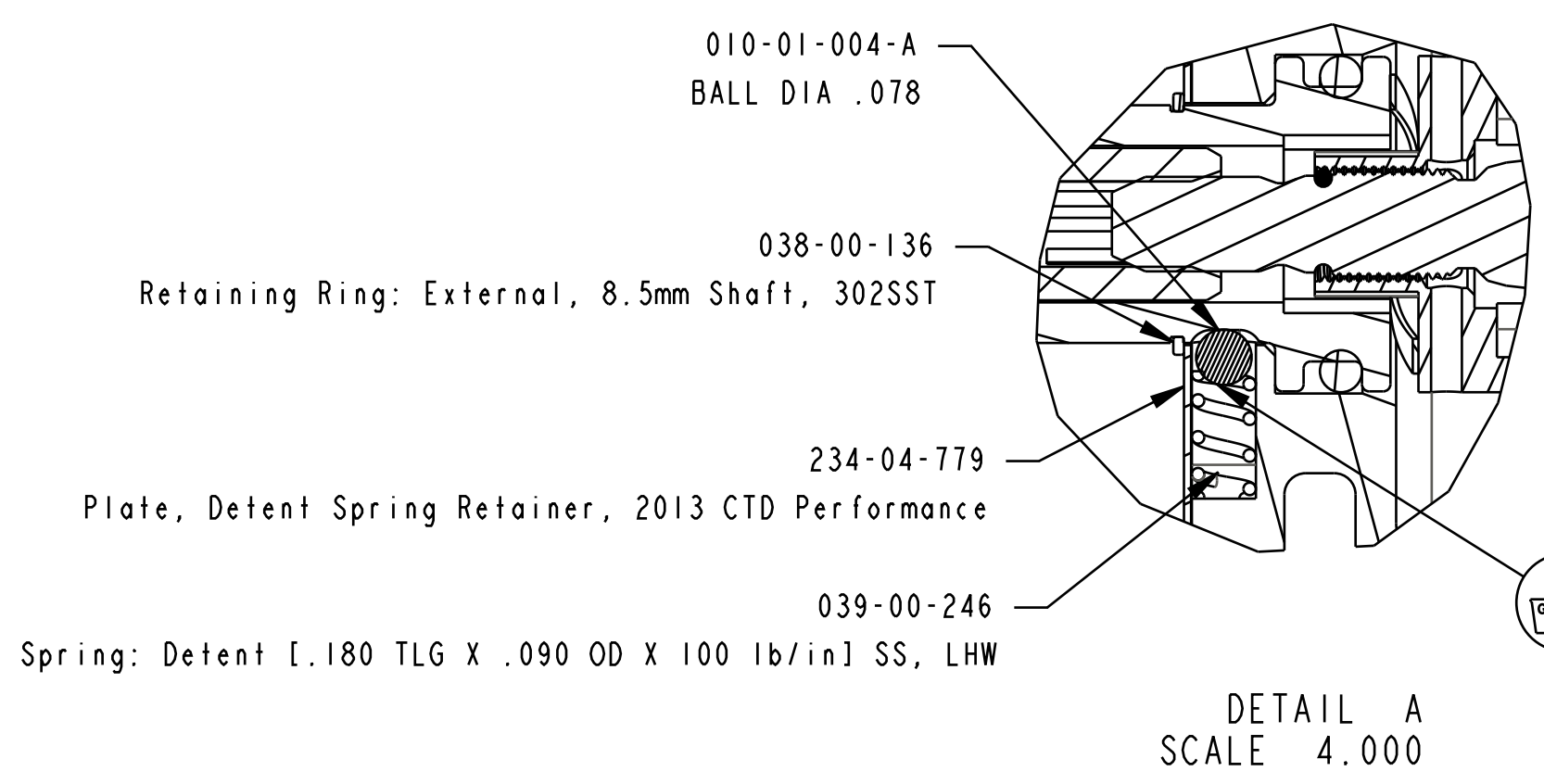

SEE DETAIL A

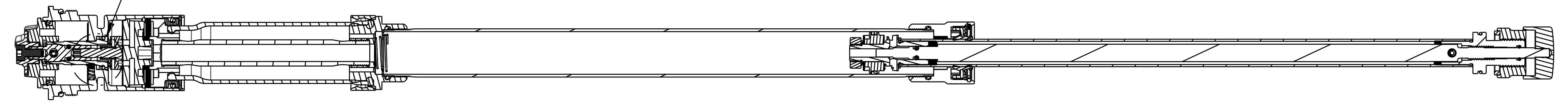

PROPRIETARY  
THIS DOCUMENT CONTAINS CONFIDENTIAL, PROPRIETARY INFORMATION  
THAT IS FOR PROPERTY. DO NOT DISCLOSE TO OR DUPLICATE  
FOR OTHERS EXCEPT AS AUTHORIZED BY FOX.

**FOX Factory, Inc.**  
130 Hangar Way, Watsonville, CA 95076 USA  
Ph 831-768-1100  
Fax 831-768-9312

TITLE  
**2019 36 160 MAX SPD-PED F-S  
FIT4 Cart Assy Complete, 3Pos-Adj**

SIZE DWG. NO.  
**820-18-154-KIT**

PLOT SCALE 1.00:1 SHEET 1 OF 1