

4

3

2

1

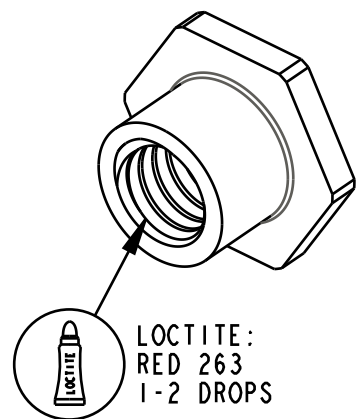

- 019-02-025 Fastener, Standard (Metric), Nut, M6 x .75
- 241-02-106 Fastener, Custom: Bolt Piston Comp Grip
- 039-00-349 Spring: [0.200 TLG X .400 ID X 0.50 lbs/in] Stainless Steel
- 045-00-151 Valve: Metric [8.00mm OD X 5.55mm ID X 0.25mm THK] Custom, Check
- 222-01-295 Piston Damping Comp 20.0 Bore
- 029-08-196 Seals: O-Ring [16.0mm ID X 2.0mm CS] Metric, N-70, Dynamic
- 029-03-011 O-Ring (-011) [.070 C.S. X .301 ID]
- 223-00-049 Piston Floating: IFP, Grip
- 820-03-331-KIT 2017 Grip Compression Valving
- 029-08-084 Seals: O-Ring [8mm ID X 1.5mm CS] Metric, N-70, Static
- 210-22-957 Damping Adj Part: Hat Preload Comp
- 029-08-188 O-Ring [17mm ID X 1.5mm CS], N-90, Static
- 231-00-026 Sleeve: Isolator, Spring, OD, Grip
- 019-01-116 Fastener Standard (Metric): PIN SS 2 X 12
- 210-03-270 Damping Adjust Part: Needle, Comp, Grip, 36 180 Max, Remote
- 029-08-108 Seals: O-Ring [4.0mm ID x 1.5mm CS] Metric, N-70, Static
- 039-00-435 Spring, Piston, Floating, Grip 180
- 231-00-025 Sleeve: Isolator, Spring, ID, Grip
- 029-08-178 Seals: O-Ring [30.0mm X 1.5mm CS] Metric, N-70, Static
- Damping Adj Part: Topcap 36 2018 Grip, Black Ano

TORQUE:  
16±1 IN.LB.

SEE DETAIL Y

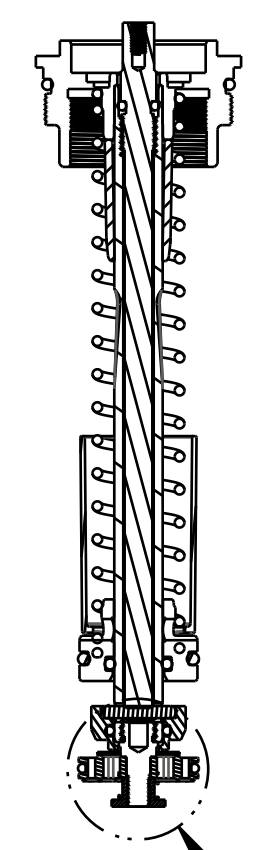

SEE DETAIL Z

IMPORTANT:  
NOTE ORIENTATION  
THIS END TAPERED

IMPORTANT:  
DO NOT PINCH VALVES

IMPORTANT:  
ORIENTATION OF PISTON IS CRITICAL  
ONE RAISED RING TOWARDS TOPCAP

IMPORTANT:  
DO NOT PINCH CHECK VALVE

PROPRIETARY  
THIS DOCUMENT CONTAINS CONFIDENTIAL, PROPRIETARY INFORMATION  
THAT IS FOX PROPERTY. DO NOT DISCLOSE TO OR DUPLICATE  
FOR OTHERS EXCEPT AS AUTHORIZED BY FOX.

		<b>FOX Factory, Inc.</b>		Ph 831-768-1100
130 Hangar Way, Watsonville, CA 95076 USA		Fox 831-768-9312		
<b>2019 36 180 MAX</b>				
<b>Grip Remote, Topcap Assy</b>				
SIZE	DWG. NO.	820-05-508-KIT		
<b>C</b>				
PLOT SCALE 0.80:1		SHEET 1 OF 1		