

IMPORTANT:
DO NOT INSTALL O-RING
IN STRAIN RELIEF.

018-01-026
Screw [#6-32 X .250 TLG]

TORQUE:
14±2 IN.LB.

029-03-006
O-Ring (-006) [.070 C.S. X .114 ID]

GREASE:
THIN LAYER
OF SLICK HONEY

Seals: O-Ring [(-023) .070 C.S. X 1.051 ID] Standard, N-70, Static

029-03-023

029-03-025
O-Ring (-025) [.070 C.S. X 1.176 ID]

SECTION B-B
SCALE 1.500

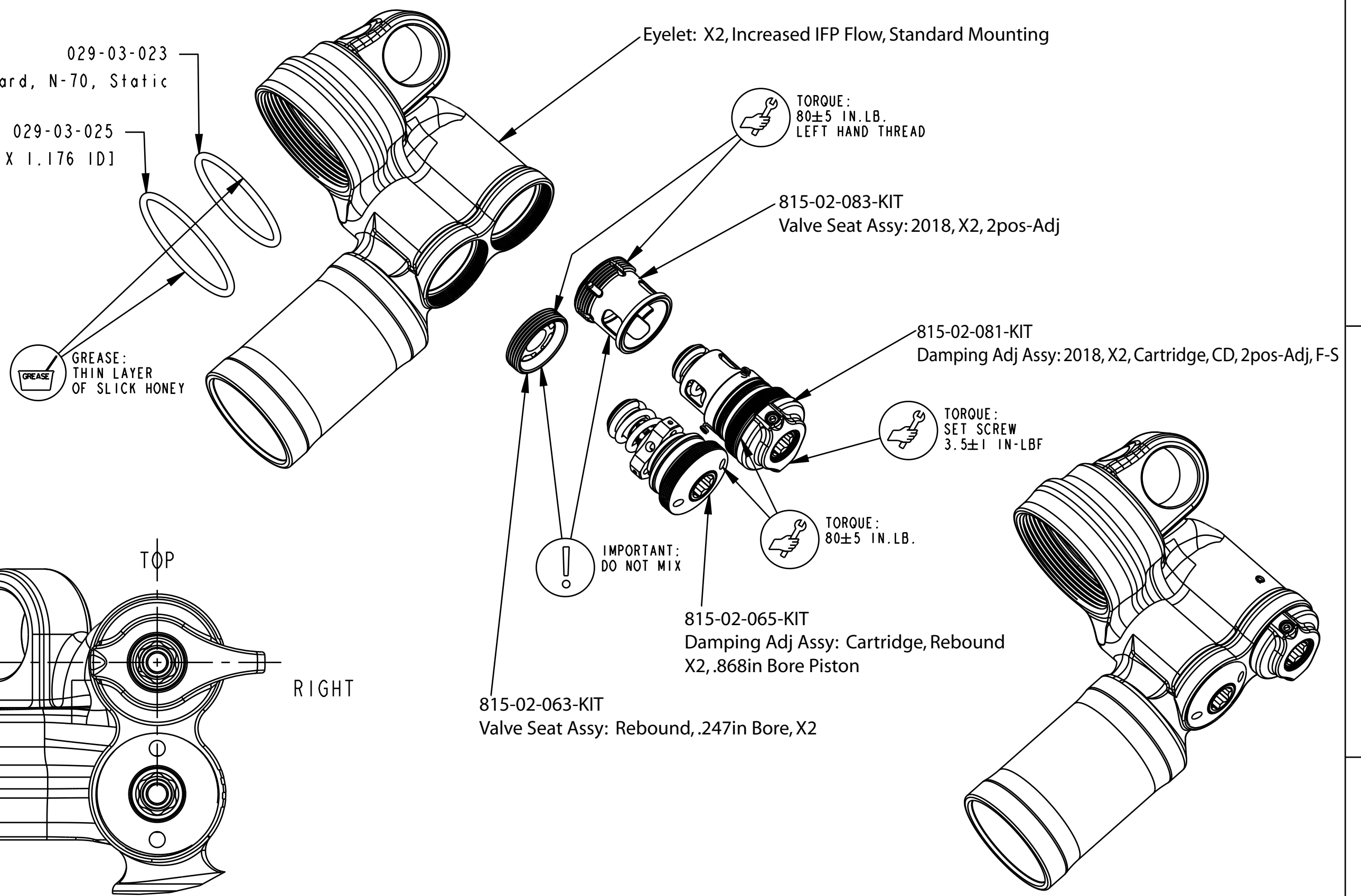

Eyelet: X2, Increased IFP Flow, Standard Mounting

TORQUE:
80±5 IN.LB.
LEFT HAND THREAD

815-02-083-KIT
Valve Seat Assy: 2018, X2, 2pos-Adj

815-02-081-KIT
Damping Adj Assy: 2018, X2, Cartridge, CD, 2pos-Adj, F-S

TORQUE:
SET SCREW
3.5±1 IN-LBF

TORQUE:
80±5 IN.LB.

IMPORTANT:
DO NOT MIX

815-02-065-KIT
Damping Adj Assy: Cartridge, Rebound
X2, .868in Bore Piston

815-02-063-KIT
Valve Seat Assy: Rebound, .247in Bore, X2

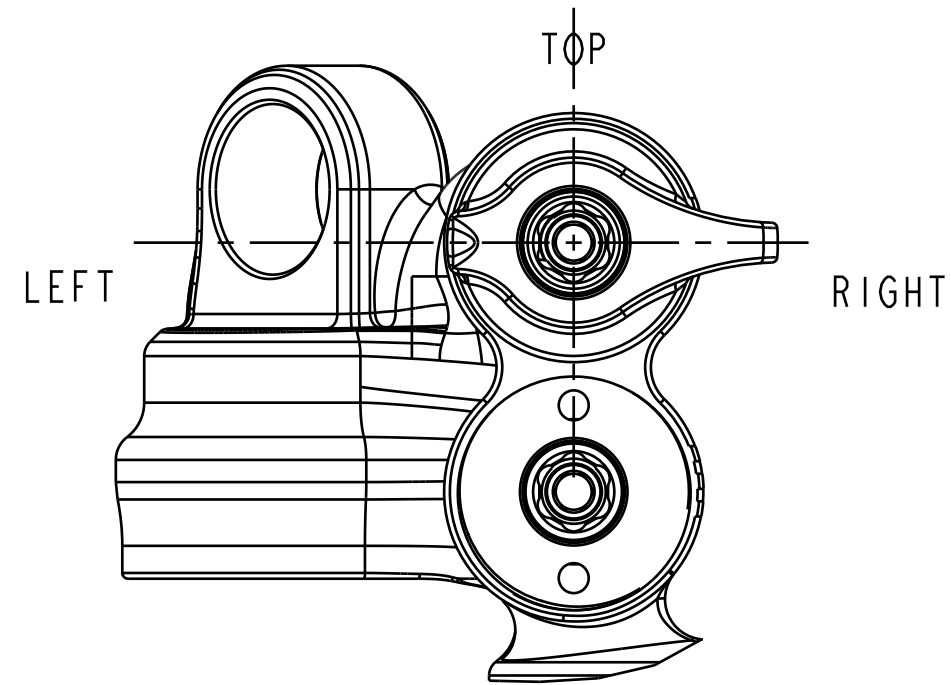

SCALE 1.500

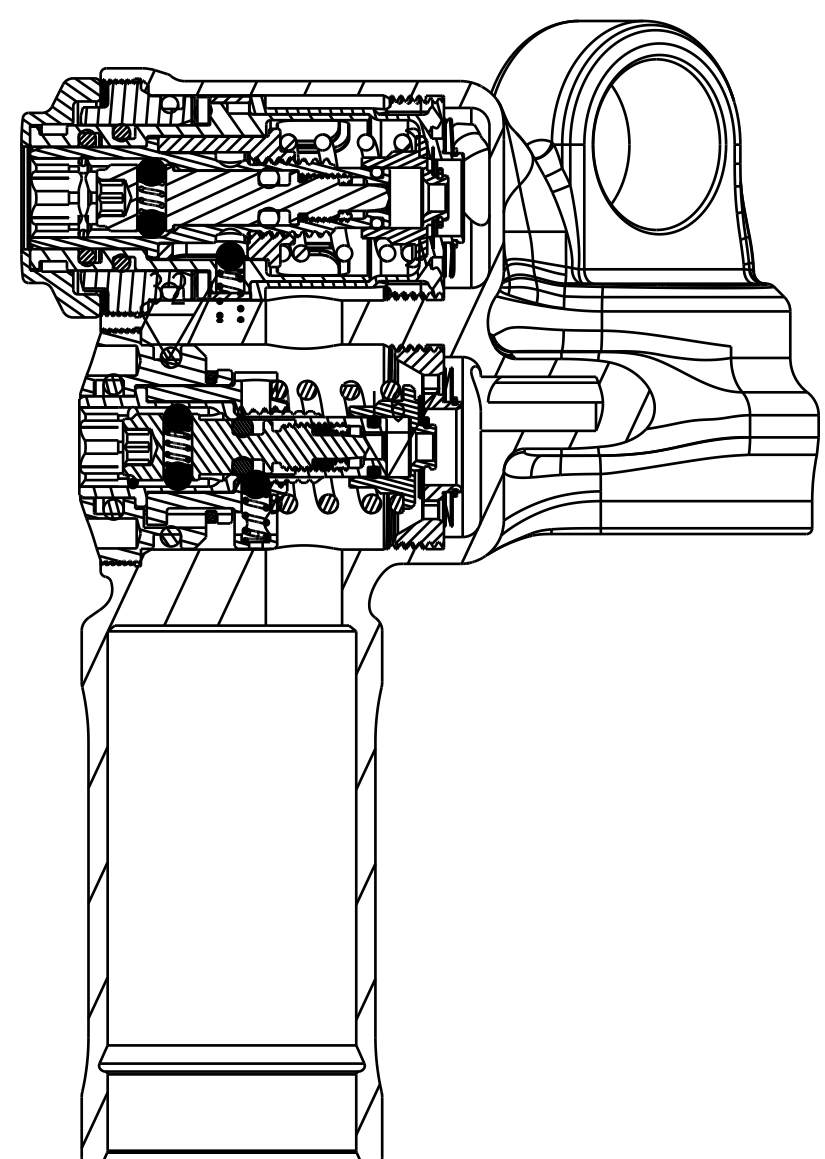

SECTION C-C
SCALE 1.500

PROPRIETARY
THIS DOCUMENT CONTAINS CONFIDENTIAL, PROPRIETARY INFORMATION
THAT IS FOX PROPERTY. DO NOT DISCLOSE TO OR DUPLICATE
FOR OTHERS EXCEPT AS AUTHORIZED BY FOX.

FOX FOX Factory, Inc.		Ph 831-768-1100
130 Hongor Way, Watsonville, CA 95076 USA		Fox 831-768-9312
TITLE		
Eyelet Assy: 2018, X2, 2pos-Adj, F-S		
SIZE	DWG. NO.	
C	808-17-361-KIT	
PLOT SCALE .00:1		SHEET 1 OF 2